

Excellent Integrated System Limited

Stocking Distributor

Click to view price, real time Inventory, Delivery & Lifecycle Information:

[FCI](#)

[51860-002LF](#)

For any questions, you can email us directly:

sales@integrated-circuit.com

Tous droits strictement réservés. Reproduction ou communication de ces lignes infidèle sans aucune forme que ce soit sans autorisation écrite du propriétaire. Propriété de c FCI. Droits de reproduction FCI.

All rights strictly reserved. Reproduction or issue in third parties in any form without written authority from the proprietor. Property of FCI. Copyright FCI.

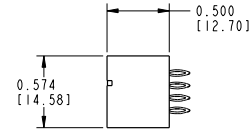
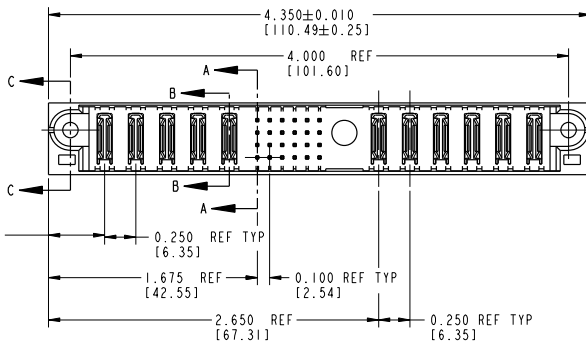
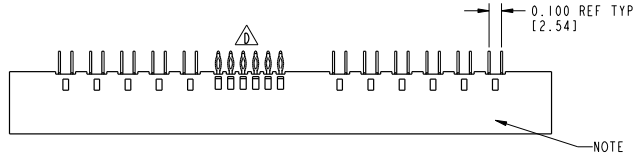
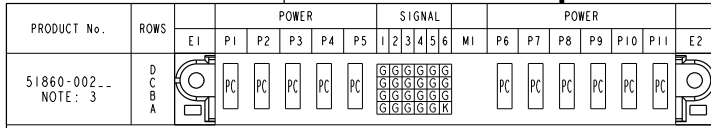

CODE	DIM "M" ±.010 [0.25]	CONTACT TYPE
G	0.270 [6.86]	SIGNAL
K	0.220 [5.59]	SIGNAL
PC	[N/A] [N/A]	POWER

ltr	ecn no.	dr	date	tolerances unless otherwise specified
A	V12513	DA1	10/31/01	linear .XX±.01/0.XX±0.3
B	V21104	TAB	09/30/02	linear .XXX±.005/0.XX±0.13
C	DG65-0572	JMG	01/05/06	linear .XXX±.0020/0.XX±0.051
D	DG07-0357	JC	03/26/08	angles 0°±
		dr	J. WITMER	10/3/01
		engr	J. ALLISON	10/3/01
		chr	J. ALLISON	10/3/01
		oppd	J. ALLISON	10/3/01

CUSTOMER		FCI	
www.fciconnect.com		www.fciconnect.com	
COPY		projection	
INCH/MM		scale 1:1	
product family	PWRBLADE	code	213
size	A	dwg no	51860-002
sheet	1	of	3

sheet index	revision sheet	D	D	D
1	2	3		

code code	22526
-----------	-------

Tous droits strictement réservés. Reproduction ou communication de ces lignes infidèle sans autorisation écrite du propriétaire. Propriété de FCI. Droits de reproduction FCI.

All rights strictly reserved. Reproduction or issue in third parties in any form without written authority from the proprietor. Property of FCI. Copyright FCI.

PRODUCT NUMBER
51860-002...
NOTE: 2

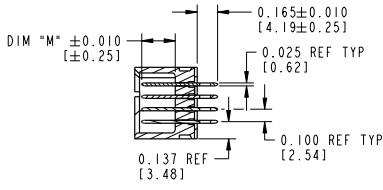

SECTION A-A

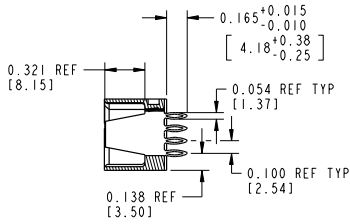

SECTION B-B

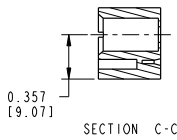

SECTION C-C

CONNECTOR NOTES:

1. HOUSING MATERIAL: UL 94 V-0 GLASS FILLED HIGH TEMP THERMOPLASTIC
 POWER CONTACT MATERIAL: COPPER ALLOY
 SIGNAL CONTACT MATERIAL: COPPER ALLOY
 2. PLATING:
 SEE PRINT 10064183 FOR PLATING SPEC OF 51860-002; 51860-002LF
 3. "MANUFACTURER'S" NAME, P/N, AND DATE CODE TO APPEAR ON THIS SURFACE
 4. PRODUCT SPECIFICATION GS-12-149
- PCB NOTES:
5. ALL DIMENSIONS ARE BASIC UNLESS OTHERWISE SPECIFIED.
 6. ALL THROUGH HOLES ARE LOCATED WITH A TRUE POSITION OF 0.004 [0.10]
 7. ALL HOLE DIAMETERS ARE FINISHED HOLE SIZE
 8. Ø0.098[2.41] THROUGH HOLES ARE UNPLATED.
 9. Ø0.0453±0.0010 [1.151±0.025] DRILLED HOLES PLATED WITH 0.0003 [0.008] MIN SnPb OVER 0.001 [0.03] TO 0.003 [0.08] Cu PLATING TO ACHIEVE A Ø0.040±0.003 [1.02±0.07] HOLE.
 10. FOR PRESS FIT APPLICATION USE FCI CAM TOOL 430169-XXX.
 11. DIMENSIONS AND TOLERANCES ARE IN ACCORDANCE WITH ASME Y14.5M, 1994 UNLESS OTHERWISE SPECIFIED.
 12. AΔSYMBOL WILL BE NEXT TO ANY DIMENSION, VIEW, OR NOTE WHICH HAS BEEN MODIFIED WITH THE CURRENT DRAWING REVISION.

mat'l code				SEE NOTE 1	tolerances unless otherwise specified	CUSTOMER		FCI	
ltr	ecm no.	dr	date	linear	XX±.01/0.XX±0.3	COPY		www.fciconnect.com	
0				angles	XXX±.005/0.XX±0.13	projection	title		5P + 24S + 1M + 6P
				dr	XXX±.0020/0.XX±0.051	INCH/MM	product family		PWRBLADE
				eng	J. WITMER 10/3/01	scale	size	dwg no	51860-002
				chr	J. ALLISON 10/3/01	1:1	A	code	213
				appd	J. ALLISON 10/3/01			sheet	2
sheet index	revision sheet								

Pro/E

PDM: Rev:D

STATUS: Released

Printed: Dec 20, 2010

Tous droits strictement réservés. Reproduction ou communication de ces lignes initiales
 sous quelque forme que ce soit sans autorisation écrite du propriétaire.
 Propriété de FCI. Droits de reproduction FCI.



All rights strictly reserved. Reproduction or issue in any
 form whatever is not permitted without written authority from the proprietor.
 Property of FCI. Copyright FCI.

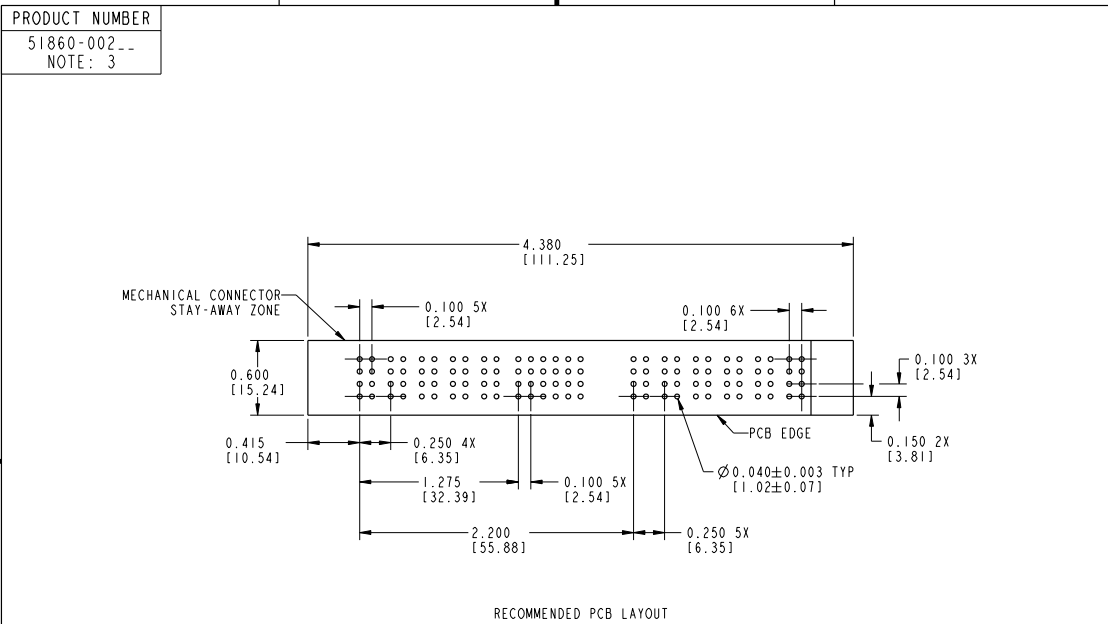

mat'l code		SEE NOTE 1	tolerances unless otherwise specified	CUSTOMER	FCI	
ltr	ecn no.	dr	date	COPY	www.fciconnect.com	
0				projection	title 5P + 24S + 1M + 6P VERTICAL PRESS-FIT HEADER	
				INCH/MM	product family PWRBLADE	code 213
				scale 1:1	size A	sheet 3
sheet index	revision sheet				dwg no 51860-002	

Pro/E 3 code code 22526 4