

## **Excellent Integrated System Limited**

Stocking Distributor

Click to view price, real time Inventory, Delivery & Lifecycle Information:

[Amphenol RF](#)  
[132112](#)

For any questions, you can email us directly:

[sales@integrated-circuit.com](mailto:sales@integrated-circuit.com)

REV.	DATE	DESCRIPTION
NC	05/22/03	INITIAL RELEASE

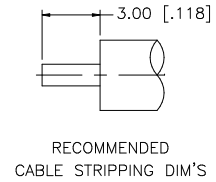
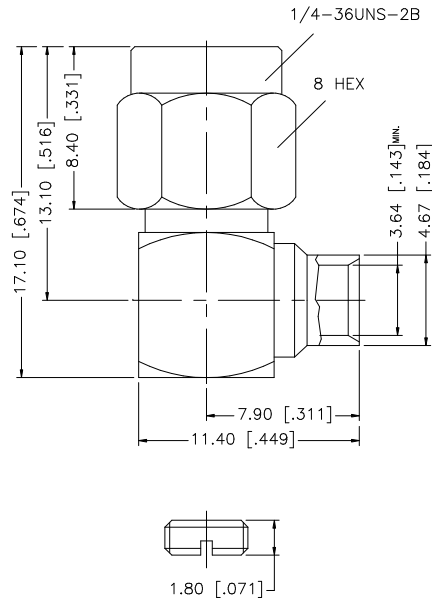

REV.	DATE	DESCRIPTION	APPROVALS	DATE	Amphenol Connex						
8					<b>SMA R/A DIRECT SOLDER PLUG (FOR .141" SEMI-RIGID CABLE)</b>						
7		COVER	BRASS	GOLD					1	PART DESCRIPTION	
6		GASKET	SILICONE	RED					1	PART NO.	
5		RETAINER RING	BER. COPPER	NATURAL					1	132112	
4		CONTACT PIN	BRASS	GOLD					1	DWG. NO. 132112.DWG	
3		INSULATOR	TEFLON	NATURAL	1	REV.	NC	SIZE	A	SCALE	NA
2		BODY	BRASS	GOLD	1						
1		SHELL	BRASS	GOLD	1						
DESCRIPTION		MATERIAL	FINISH	QTY	CAD FILE		C:/132/132112.DWG				

UNLESS OTHERWISE SPECIFIED DIMENSIONS ARE IN MILLIMETERS; DIMENSIONS IN [ ] ARE IN INCHES AND FOR CUSTOMER REFERENCE ONLY.

UNLESS OTHERWISE SPECIFIED TOLERANCES FOR MILLIMETERS ARE:  
 0.5 - 8mm ± 0.20mm  
 8 - 30mm ± 0.40mm  
 30 - 120mm ± 0.50mm

UNLESS OTHERWISE SPECIFIED TOLERANCES FOR INCHES ARE:  
 .020 - .315 = ± 0.007"  
 .315 - 1.180 = ± 0.015"  
 1.180 - 4.724 = ± 0.020"

DO NOT SCALE DRAWING

APPROVALS

DRAWN G.R.S. 05/22/03

CHECKED

ISSUED

SHEET 1 OF 1

CAD FILE C:/132/132112.DWG

**Amphenol Connex**

PART DESCRIPTION

SMA R/A DIRECT SOLDER PLUG  
(FOR .141" SEMI-RIGID CABLE)

PART NO. 132112

DWG. NO. 132112.DWG

REV. NC SIZE A SCALE NA