

## Excellent Integrated System Limited

Stocking Distributor

Click to view price, real time Inventory, Delivery & Lifecycle Information:

[Littelfuse](#)  
[OPTF0075PXBL](#)

For any questions, you can email us directly:

[sales@integrated-circuit.com](mailto:sales@integrated-circuit.com)

CAD GENERATED DRAWING - NO PENCIL CHANGES ALLOWED

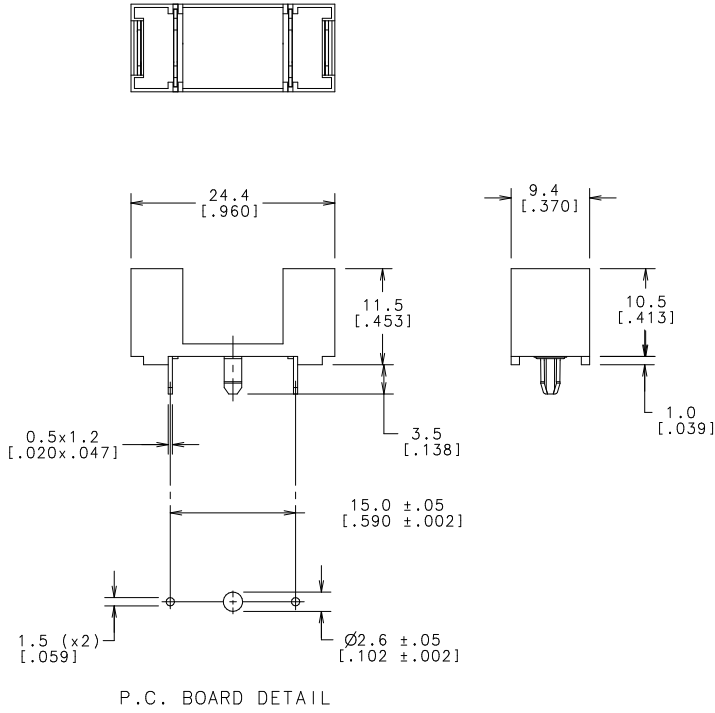

**SPECIFICATIONS:**

- INSULATING BODY: PA 68 UL 94 VO (BLACK)
- CONTACTS: CuZn37 + Ni + Sn
- NOMINAL CURRENT: 6.3A
- RATED VOLTAGE: 250V

NO		COMPONENT NO		DESCRIPTION		QTY/M		U/M	
<b>BILL OF MATERIAL</b>									
MATERIAL SPEC					FINISH				
COPIES TO	DRW	BJJ	DATE	12/08/04	SCALE	2:1			
1	9	18	CHK	DATE	12	20	SUPER DRW		
2	10	19	APPD	DATE	13	21	FINISH GOOD WT		
3	12	20	TOLERANCE UNLESS OTHERWISE SPECIFIED						
4	13	21	TWO PLACE DEC. $\pm$ .25[.01]						
5	14	23	THREE PLACE DEC. $\pm$ .100[.004] ANGULAR $\pm$ 1°						
6	15	33	TITLE						
7	16	43	FUSEHOLDER OPEN 5x20 BLACK						
8	17	53	PROJ. ANS. PROJECTION						
DES PLAINES, ILLINOIS 60016									
REVISION A									
61567 - RELEASED 12/8/04 BJJ									
CHK APD									
FINAL OPTF0075PXBL									

UNLESS OTHERWISE SPECIFIED, DIMENSIONS ARE IN MILLIMETERS. DIMENSIONS IN BRACKETS [ ] ARE INCHES.  
 UNLESS OTHERWISE SPECIFIED, DIMENSIONS DO NOT INCLUDE PLATING.  
 DENOTES CRITICAL CHARACTERISTICS.  
 DENOTES CPK DIMENSIONS - MINIMUM CPK VALUE  
 DENOTES A CHARACTERISTIC THAT PROVIDES AN INDICATION OF PROCESS PERFORMANCE. INSPECTOR SHALL FOLLOW THE LITTELFUSE INSPECTION INSTRUCTIONS.  
 DENOTES CP DIMENSIONS - MINIMUM CP VALUE (CPK) ON DRAWING AND INITIALLY LOCATED TO ALLOW FOR MAXIMUM TOOL LIFE.

