



**Distributor of ASSMANN WSW Components: Excellent Integrated System Limited**  
Datasheet of A-DS-09-LL/Z - D-Sub Connector Plug, Male Pins 9 Position Free Hanging (In-Line) Solder Cup

Contact us: [sales@integrated-circuit.com](mailto:sales@integrated-circuit.com) Website: [www.integrated-circuit.com](http://www.integrated-circuit.com)

---

## **Excellent Integrated System Limited**

Stocking Distributor

Click to view price, real time Inventory, Delivery & Lifecycle Information:

[ASSMANN WSW Components](#)  
[A-DS-09-LL/Z](#)

For any questions, you can email us directly:

[sales@integrated-circuit.com](mailto:sales@integrated-circuit.com)

Contact us: [sales@integrated-circuit.com](mailto:sales@integrated-circuit.com) Website: [www.integrated-circuit.com](http://www.integrated-circuit.com)

1 2 3 4 5 6 7

**Male**

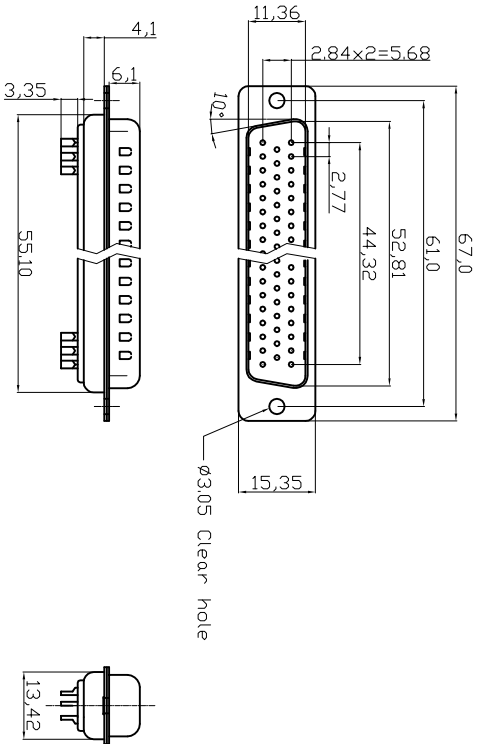
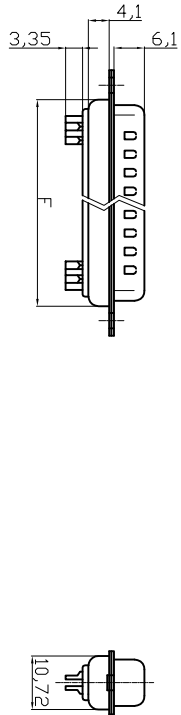
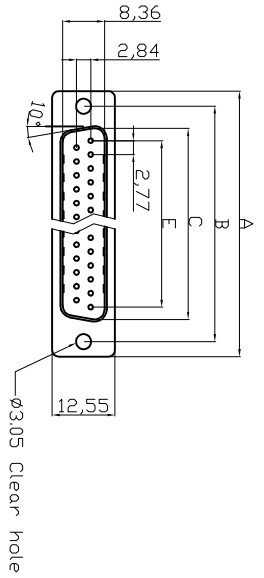

**50 Positions**

Positions	A	B	C	E	F
9	30.81	24.99	16.92	11.08	19.20
15	39.20	33.30	25.25	19.39	27.70
25	53.04	47.04	38.96	33.24	41.10
37	69.40	63.50	55.42	49.86	57.30

**Product Specification**  
**Material**  
 Insulator : Glass-Filled Thermoplastic PBT, UL94V-0, White  
 Contact : Copper alloy, Gold flash selective gold  
 Shell: SPCC  
 Clinch Nut : Brass, Nickel Plated  
 Screwlock : Brass, Nickel Plated

**Electrical**  
 Contact Resistance : 20 milliohms Max at 1 AMP DC.  
 Insulation Resistance : 1000 megohms at 500 VDC  
 Dielectric Withstanding Voltage : 1000 VAC/rms 60Hz for 1 minute  
 Current Rating : 3 AMP  
 Voltage Rating : 250 VAC/rms 60Hz  
 Ⓢ OPERATING TEMPERATURE:-55°C+105°C  
 Order Code:

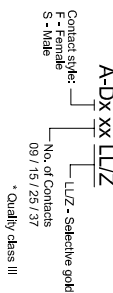

**ROHS compliant**  
 Unit: mm

Scale	Free
TOLEFRANCE	
X.	±0.38
X.X	±0.25
X.XX	±0.13
DIM	TOL
X.°	±3°
X.X°	±1.0°
Angle	TOL

Update operation temperature range	Id.	Modification	Date	Name
Ⓢ	Ⓢ	Drawn	15.08.2012	Lucas

Customer-No.	Name	Date	Approved	Winnle
ASSMANN WSW-No.	Lucas	15.08.2012	13.05.2014	Winnle
Drawing-No.				
ASS 4884 CO				
Replace				

**A-Dx xx LL/Z**

**ASSMANN**

WSW/ components

rev01

Sheet 1/2

