

Excellent Integrated System Limited

Stocking Distributor

Click to view price, real time Inventory, Delivery & Lifecycle Information:

[TE Connectivity AMP Connectors](#)
[520470-3](#)

For any questions, you can email us directly:

sales@integrated-circuit.com



Distributor of TE Connectivity AMP Connectors: Excellent Integrated System Limited

Datasheet of 520470-3 - CONN MOD JACK 6P6C R/A UNSHLD

REVISIONS TO THIS DRAWING	REVISIONS TO THIS DRAWING
REV. DATE	REV. DATE

REV.	DATE	DESCRIPTION	BY	CHKD	APP'D
AA	22				
G	ADDED	4/1/89	C95-57 & EC 5210-0345-95	5-26-95	ST

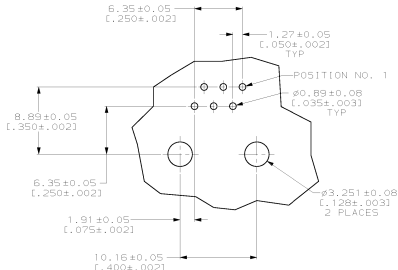
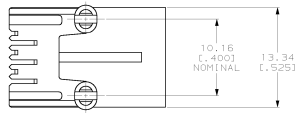
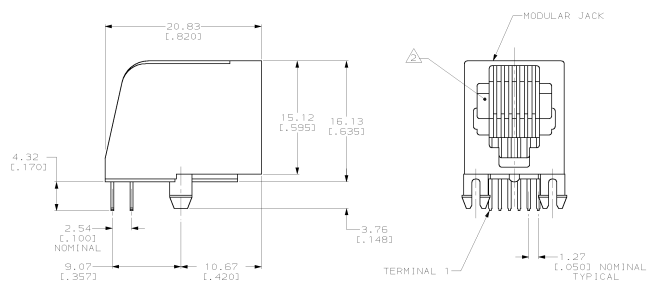

PRINTED CIRCUIT BOARD LAYOUT
NONCOMPONENT SIDE SHOWN

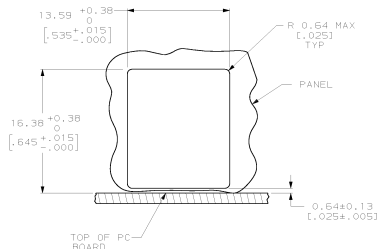

PANEL CUTOUT

- ⚠ MATERIAL: HOUSING - PBT POLYESTER, BLACK TERMINAL - 0.35 [1.018] THICK PHOS-BRONZE PLATED WITH 1.27 [1.00050] MINIMUM THICK HARD GOLD IN LOCALIZED GOLD PLATE AREA AND 3.81 [1.00150] MINIMUM THICK TIN-LEAD IN SOLDER AREA OVER 1.27 [1.00050] MINIMUM THICK NICKEL UNDERPLATE.
- ⚠ CAVITY CONFORMS TO FCC RULES AND REGULATIONS PART 68 AND REA BULLETIN 345-81, PE-76 SPECIFICATION FOR MODULAR TELEPHONE HARDWARE.
- ⚠ DIMENSIONS ARE MAXIMUM UNLESS OTHERWISE SPECIFIED.
- ⚠ TERMINALS LOCATED IN CENTER TWO POSITIONS ARE FOR 520470-4.

2	520470-4
6	520470-3
CONTACTS PART NUMBER	

THIS DRAWING IS A CONTROLLED DOCUMENT		REV. INDEX	DATE
DESIGNER		BY	DATE
DRAWN		CHKD	DATE
APP'D		DATE	
MATERIAL		REV. INDEX	DATE
FINISH		REV. INDEX	DATE

AMP Incorporated
Harri sburg, PA 17105-3608

MODULAR JACK ASSEMBLY,
SIDE ENTRY, 6 POSITION,
FLANGELESS

520470-3
114-2048
A100779-520470