

Excellent Integrated System Limited

Stocking Distributor

Click to view price, real time Inventory, Delivery & Lifecycle Information:

[TE Connectivity AMP Connectors](#)
[556591-1](#)

For any questions, you can email us directly:

sales@integrated-circuit.com



Distributor of TE Connectivity AMP Connectors: Excellent Integrated System Limited

Datasheet of 556591-1 - CONN MOD JACK 8P8C R/A SHIELDED

THIS DRAWING IS UNCONTROLLED
 (U) CONTROL IS

REV	DATE	REVISIONS	BY	CHK	APP
AA	22				
E		0851-2, EC 0502-0845-97			

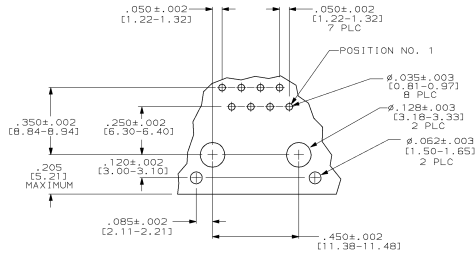
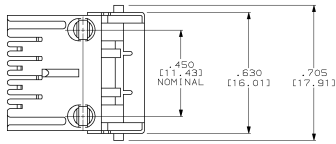
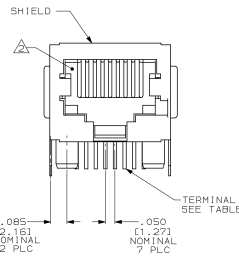
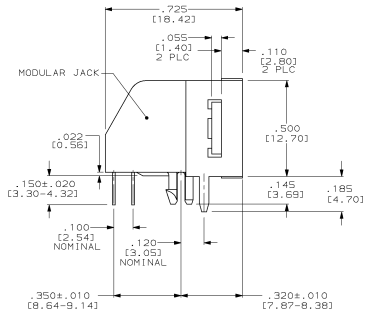

SUGGESTED PRINTED CIRCUIT BOARD
 MOUNTING HOLE LAYOUT
 VIEW SHOWN AS CIRCUIT SIDE OF BOARD

- △ MATERIAL:
 HOUSING-PBT POLYESTER BLACK.
 TERMINAL-.014 [0.36] THICK PH05-BRONZE
 PLATE WITH .000050 [1.27μm] THICK HARD
 GOLD IN LOCALIZED GOLD PLATE AREA AND
 .000080 [2.03μm] THICK TIN-LEAD IN
 SOLDER AREA OVER .000050 [1.27μm] THICK
 NICKEL UNDERPLATE.
 SHIELD-.010 [0.25] THICK COPPER ALLOY,
 TIN-LEAD PLATED.
- △ CAVITY CONFORMS TO FCC RULES AND
 REGULATIONS, PART 6B, SUBPART F.
- 3. FOR APPLICATION INFORMATION SEE AMP
 SPECIFICATION 114-2048.
- 4. FOR PERFORMANCE REQUIREMENTS SEE AMP
 SPECIFICATION 108-1163.
- △ ALL DIMENSION SHOWN ARE MAXIMUM
 UNLESS OTHERWISE SPECIFIED.
- 6. DIMENSIONS IN [] ARE MILLIMETERS.

8	556591-1
TERMINALS	PART NO.

APPROVED: [Signature] DATE: 11-18-98 BY: [Signature] DATE: 12-14-98 FOR: [Signature] DATE: 12-18-98 CHECKED: [Signature] DATE: 12-18-98 DESIGNED: [Signature] DATE: 12-18-98 DRAWN: [Signature] DATE: 12-18-98 PART: [Signature] DATE: 12-18-98 CHECKED: [Signature] DATE: 12-18-98 DESIGNED: [Signature] DATE: 12-18-98 DRAWN: [Signature] DATE: 12-18-98 PART: [Signature] DATE: 12-18-98	AMP Incorporated Harrisburg, PA 17105-3608 MODULAR JACK ASSEMBLY, 8 POSITION, SHIELDED, KEYED, LOW PROFILE, RIGHT ANGLE WITH PRINTED BOARD GROUND AND PANEL STOPS ORDER CODE: 556591 DRAWING NO: 00778 CUSTOMER DRAWING
--	--