

Excellent Integrated System Limited

Stocking Distributor

Click to view price, real time Inventory, Delivery & Lifecycle Information:

[Panduit](#)

[ACC38-A-C20](#)

For any questions, you can email us directly:

sales@integrated-circuit.com



Distributor of Panduit: Excellent Integrated System Limited
Datasheet of ACC38-A-C20 - ADHESIVE CORD CLIPS

THIS COPY IS PROVIDED ON A RESTRICTED BASIS AND IS NOT TO BE USED IN ANY WAY DETRIMENTAL TO THE INTERESTS OF PANDUIT CORPORATION.

PANDUIT PART NUMBER	DIMENSIONS				MAXIMUM CABLE DIA. in. (mm)	ADHESIVE BACKING	WEIGHT lbs/100 pcs (g)/100 pcs
	A	B	C	D			
ACC38-A						RUBBER	
ACC38-AT	1.00 (25.4)	1.00 (25.4)	0.49 (12.4)	0.40 (10.2) (REF)	0.380 (9.6)	ACRYLIC	0.40 (181)
ACC38-AV						HIGH BOND ACRYLIC	

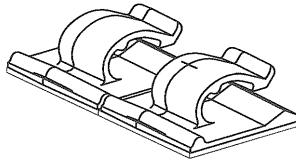
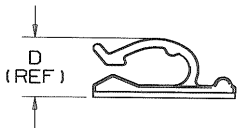
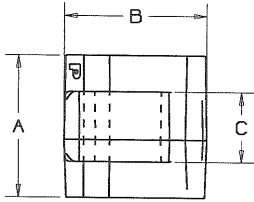

TWO UP CONFIGURATION
(AS SUPPLIED TO CUSTOMER)

NOTES:

- SEE CURRENT PRICE SHEET FOR PART NUMBER SUFFIX DESIGNATION FOR PACKAGE SIZE.

CAD FILENAME/LAYERS: G03597BB_DC_GB0239DY/00C



TINLEY PARK, ILLINOIS

ACC38-A, ACC38-AT, ACC38-AV
ADHESIVE CORD CLIP

UNLESS OTHERWISE SPECIFIED,
DIMENSIONAL TOLERANCES ARE:
(.X) ±0.05 (1.3) (1.XXX) ±0.010 (0.25)
(.XX) ±0.02 (1.5) ANGLES ±5°

UNLESS OTHERWISE SPECIFIED,
ALL DIMENSIONS ARE GIVEN
IN INCHES, THIRD ANGLE PROJECTION

00C	11-6-09	TMSA	SMV	ADDED ACC38-AV PART NUMBER	GB0239DY	00C	KW										
00B	6/23/08	DJSM		REVISED AND RE-RELEASED TO TEAMCENTER REV HISTORY; TABULARIZED DIMS, REMOVED .45 AND .27 DIMS, REVISED .38 DIM TO .45 INCLUDE TAPE, TIGHTENED TOLERANCES, REMOVED APPLICATION, TAPE, AND WARRANTY NOTES	GB0239DY	00B											
I	10/30/00	CGSM		CHANGED DIMS TO REF, REMOVED .03 DIM, CHANGED APPLICATION NOTE I	GB0239DY	I											
R	8-8-96	MLD		INITIAL RELEASE	GB0239DY	R											
REV	DATE	BY	CHK	DESCRIPTION	ECN	R	CUST	SUP									
										DRAWN BY	MLD	MAT'L:	NYLON 6/6	SCALE	FULL	DWG	A
										DATE	8-8-96			DRAWING NO.	GB0239DY	SIZE	
										CHK'D	KW						