

## Excellent Integrated System Limited

Stocking Distributor

Click to view price, real time Inventory, Delivery & Lifecycle Information:

[Lumex, Inc.](#)  
[SSF-LXH4RA5BID](#)

For any questions, you can email us directly:

[sales@integrated-circuit.com](mailto:sales@integrated-circuit.com)

DATE	REVISIONS	REV
7-5-95	UPDATED SPECS. & DIM WHERE NOTED./	A

DRAWING NUMBER	REV
<b>SSF-LXH4RA5BID</b>	A

*UNCONTROLLED DOCUMENT*

ELECTRO-OPTICAL CHARACTERISTICS TA=25 °C If=20mA

PARAMETER	MIN	TYP	MAX	UNITS	TEST COND
PEAK WAVELENGTH		635 (RED)		nm	
FORWARD VOLTAGE		3.5	13	V <sub>f</sub>	
AXIAL INTENSITY		20		mcd	V <sub>f</sub> =9.0
BLINKING FREQUENCY		1.5		Hz	V <sub>f</sub> =13.0
		2.5		Hz	V <sub>f</sub> =3.5
VIEWING ANGLE		60		2x theta	
EMITTED COLOR :	RED				
EPOXY LENS FINISH:	RED DIFFUSED				

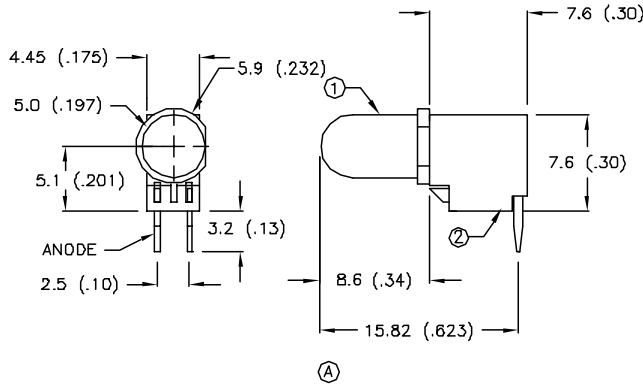

NOTES:

1. SSL-LX5093BID LED.
2. IFS-LX4FRA-1 LAMP SOCKET.
3. CUT LED LEADS 5mm LONG.
4. ASSEMBLE IN SOCKET, POLARITY AS SHOWN.

LIMITS OF SAFE OPERATION AT 25 DEG. C

PARAMETER	MAX	UNITS
FORWARD CURRENT	70	mA
FORWARD VOLTAGE	13	V
POWER DISSIPATION	200	mW
OPERATING, STORAGE TEMP.	-40 TO +85	°C
LEAD SOLDERING TEMP.	+260	°C
2.0mm FROM BODY		3 SEC. MAX

*UNCONTROLLED DOCUMENT*

<b>LUMEX</b> OPTO COMPONENTS INC.		292 E. HELLEN ROAD PALATINE, ILLINOIS 60067 (708) 359-2790	
DATE: 8-23-93	APPROVED BY:	DRAWN BY:	
SCALE: DO NOT SCALE			
T-1 3/4 LAMP, BLINKING RED FAULT INDICATOR			
PAGE 1 OF 1	DRAWING NUMBER <b>SSF-LXH4RA5BID</b>		REV A