

## Excellent Integrated System Limited

Stocking Distributor

Click to view price, real time Inventory, Delivery & Lifecycle Information:

[FCI](#)

[68290-002LF](#)

For any questions, you can email us directly:

[sales@integrated-circuit.com](mailto:sales@integrated-circuit.com)

PRODUCT NUMBER  
SEE TABLE

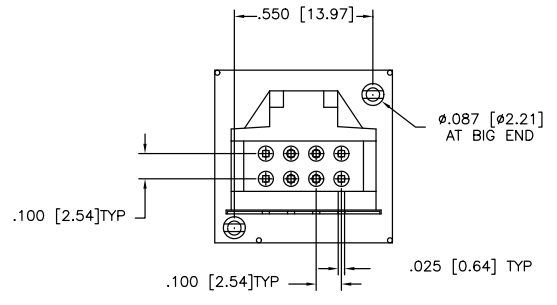
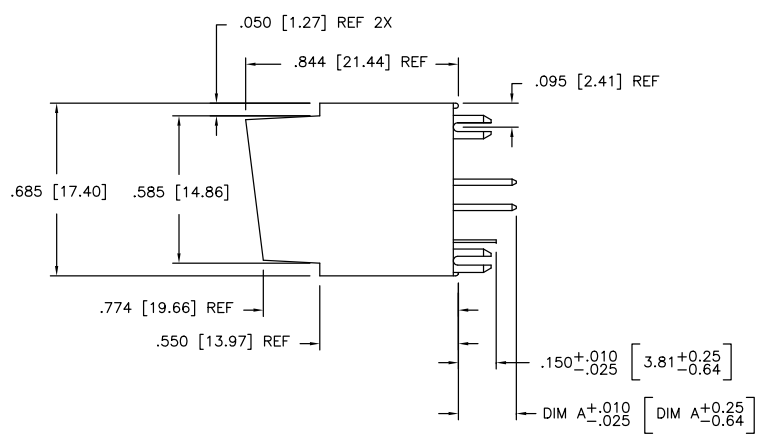
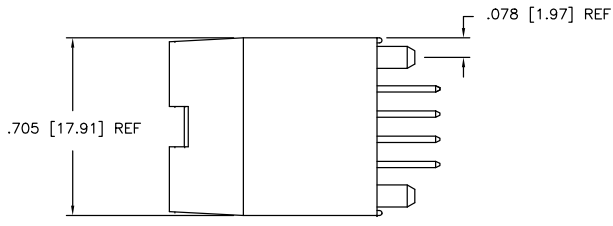

mat'l. code	surface	tolerance	projection	product family
	ISO 1302	ISO 406		LATCH-N-LOK
tr/ecn n/dr date	tolerances unless otherwise specified			title
L BX-H-00440 ZK 11/29/11	angles	lines	INCH/MM	180° 2X4 LNL HEADER ASSEMBLY
F M05-0033 ERE 2/25/05	0°±2'	XXX/01/03XXX/03	scale 2:1	dwg no 68290 sheet 1 of 2 size A3
G M05-0052 MHT 3/16/05	dr	S. ROYER 8/9/90	FCI	type Product Customer Drawing
H M06-0363 AGS 9/20/06	engr	D. HORCHLER 8/9/90		
J M07-0116 AGS 2/19/07	chr	D. HORCHLER 8/9/90		
K M09-0048 MHT 3/12/08	app	D. HORCHLER 8/9/90		
sheet revision	L			
index sheet	1 2			

68290-XXXLF

LEAD FREE OPTION ⑥

COLOR ④		
1	79343 LT GRAY	OBS
2	80166 OFF WHITE	
3	79634 BK GRAY	OBS
4	701 BLACK	
5	79514 SLATE GRAY	OBS
7	70455 SILVER GRAY	
8	80189 PEARL WHITE	OBS
9	70419 PEBBLE GRAY	

PLATING ③		
0	30u" MIN OVER 50u"MIN Ni	
3	30u" MIN OVER 50u"MIN Ni	
5	50u" MIN OVER 50u"MIN Ni	

PIN LENGTH		
	DIM L	
0	.130/3.30	
1	.230/5.83	

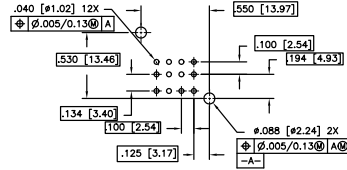

RECOMMENDED PCB LAYOUT

NOTES:

- HEADER SHROUD  
MAT'L: HIGH TEMPERATURE THERMOPLASTIC.  
UL-94V-0 RATED.
- GROUND CONTACT  
MAT'L: COPPER ALLOY  
PLATING: 100-160u" /2.54-4.06u TIN.
- SIGNAL CONTACT  
MAT'L: COPPER ALLOY  
PLATING: PERFORMANCE PLATING WILL BE EITHER GOLD OR GXT ON CONTACT AREA OR TAIL, OPTIONALLY (78-295u") TIN ON TAIL.
- NUMBERS SHOWN ARE FOR G.E. LEXAN AND ARE FOR REFERENCE ONLY.
- THIS ASSEMBLY U.L. APPROVED PER FILE E66906 VOL. 1, SEC. 84 AND CSA APPROVED PER MASTER FILE LR 46923.
- ADD LF SUFFIX AT THE END OF PART NUMBER FOR LEAD FREE OPTION.
- THE HOUSING WILL WITHSTAND EXPOSURE TO 260°C PEAK TEMPERATURE FOR 15 SECONDS IN A WAVE SOLDER APPLICATION WITH A 1.5mm MINIMUM THICK CIRCUIT BOARD. SEE APPLICATION NOTES/PROCEDURES IF THEY ARE AVAILABLE.
- THIS PRODUCT MEETS EUROPEAN UNION DIRECTIVES AND OTHER COUNTRY REGULATION AS DESCRIBED IN GS-22-008.
- PRODUCT SPEC: GS-12-003

mat'l. code	surface	tolerance	projection	product family
	ISO 1302	ISO 406		LATCH-N-LOK
ltr	ecn	ndbr	date	title
				180° 2X4 LNL HEADER ASSEMBLY
	angles	linea	scale 1:1	dwg no
	0±2'	XXX/01/012403		sheet2of2 size
	dr	S. ROYER	8/9/90	68290
	engr	D. HORCHLER	8/9/90	A3
	chr	D. HORCHLER	8/9/90	type Product Customer Drawing
	app	D. HORCHLER	8/9/90	
sheet index	revision sheet			

4 PDS: Rev :L

STATUS: released

Printed: Dec 27, 2011