

Excellent Integrated System Limited

Stocking Distributor

Click to view price, real time Inventory, Delivery & Lifecycle Information:

[FCI](#)
[51730-016](#)

For any questions, you can email us directly:
sales@integrated-circuit.com

Tous droits strictement réservés. Reproduction ou communication à des tiers interdite sous quelque forme que ce soit sans autorisation écrite du propriétaire. Propriété de c FCI. Droits de reproduction FCI.



All rights strictly reserved. Reproduction or issue to third parties in any form whatsoever is not permitted without written authority from the proprietor. Property of FCI. Copyright FCI.

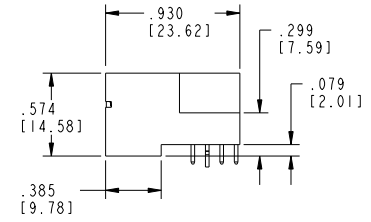
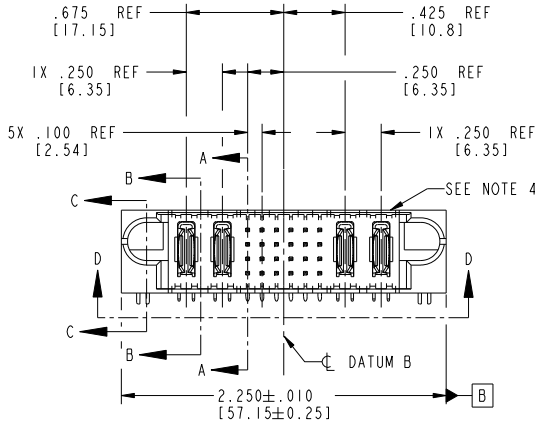
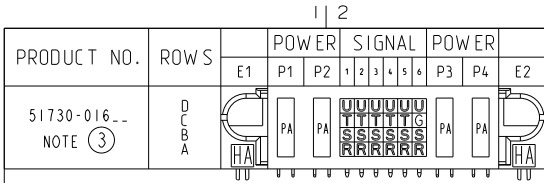

| CODE | DIM "M" MATING LENGTH | CONTACT TYPE |
|------|-----------------------|--------------|
| G | .220 [5.59] | SIGNAL |
| R | .270 [6.86] | SIGNAL |
| S | .270 [6.86] | SIGNAL |
| T | .270 [6.86] | SIGNAL |
| U | .270 [6.86] | SIGNAL |
| PA | N/A [N/A] | POWER |
| HA | N/A [N/A] | HOLD-DOWN |

| mat'l code | | SEE NOTE 2 | tolerances unless otherwise specified | | CUSTOMER | www.fciconnect.com |
|-------------|----------------|------------|---------------------------------------|----------------------------|------------|--------------------------------------|
| ltr | ech no. | dr | date | linear | COPY | |
| H | D607-0498 | JC | 03/26/08 | .XX±.01/0.X±0.3 | projection | 2P + 24S + 2P |
| J | D608-0272 | W D | 09/25/08 | .XXX±.005/0.XX±0.13 | INCH/MM | RIGHT ANGLE SOLDER HEADER |
| | | | | .XXX±.0020/0.XXX±0.051 | scale | product family PwrBlade code 213 |
| | | | | angles 0°±? | 1:1 | size dwg no A 51730-016 sheet 1 of 4 |
| | | | | dr J. SHAFFER 01-22-02 | | |
| | | | | engr M. MOSTOLLER 01-22-02 | | |
| | | | | chr M. MOSTOLLER 01-22-02 | | |
| | | | | appd M. MOSTOLLER 01-22-02 | | |
| sheet index | revision sheet | J 1 | J 2 | J 3 | J 4 | |

1 | 2

Pro/E

PDM: Rev:3

STATUS: Released

Printed: Dec 20, 2010

Tous droits strictement réservés. Reproduction ou communication à des tiers interdite sous quelque forme que ce soit sans autorisation écrite du propriétaire. Propriété de c FCI. Droits de reproduction FCI.

All rights strictly reserved. Reproduction or issue to third parties in any form whatsoever is not permitted without written authority from the proprietor. Property of FCI. Copyright FCI.

PRODUCT NUMBER
51730-016__
NOTE (3)

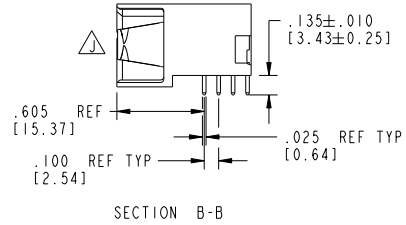
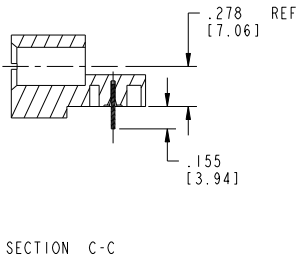
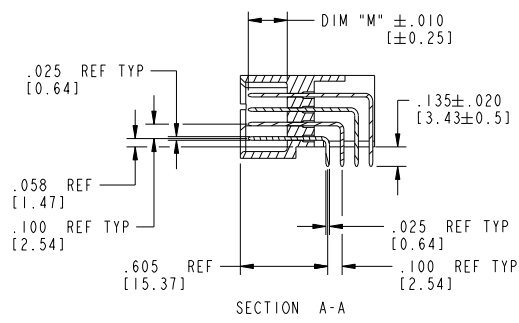
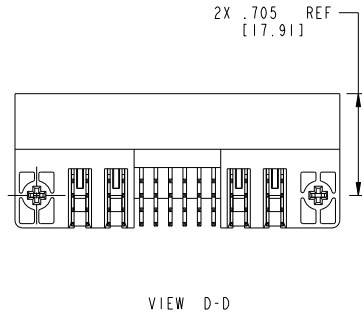

| | | | | | | | | | |
|-------------|----------------|------------|------|---------------------------------------|------------------------|------------|---------------------------|--------------------|----------|
| mat'l code | | SEE NOTE 2 | | tolerances unless otherwise specified | | CUSTOMER | | FCI | |
| ltr | ech no. | dr | date | linear | .XX±.01/0.X±0.3 | projection | COPY | www.fciconnect.com | |
| J | | | | linear | .XXX±.005/0.XX±0.13 | | title | 2P + 24S + 2P | |
| | | | | angles | .XXX±.0020/0.XXX±0.051 | | RIGHT ANGLE SOLDER HEADER | product family | PwrBlade |
| | | | | dr | J. SHAFFER 01-22-02 | INCH/MM | size | dwg no | code |
| | | | | enr | M. MOSTOLLER 01-22-02 | scale | A | 51730-016 | 213 |
| | | | | chr | M. MOSTOLLER 01-22-02 | 1:1 | | | sheet |
| | | | | appd | M. MOSTOLLER 01-22-02 | | | | 2 of 4 |
| sheet index | revision sheet | | | | | | | | |

1 | 2

Pro/E

PDM: Rev:3

STAT US: **Released**

Printed: Dec 20, 2010

1 | 2

3 |

4

A

A

B

B

Tous droits strictement réservés. Reproduction ou communication à des tiers interdite sans que la forme que ce soit sans autorisation écrite du propriétaire. Propriété de c FCI. Droits de reproduction FCI.



All rights strictly reserved. Reproduction or issue to third parties in any form whatsoever is not permitted without written authority from the proprietor. Property of FCI. Copyright FCI.

PRODUCT NUMBER
51730-016_ _
NOTE ③

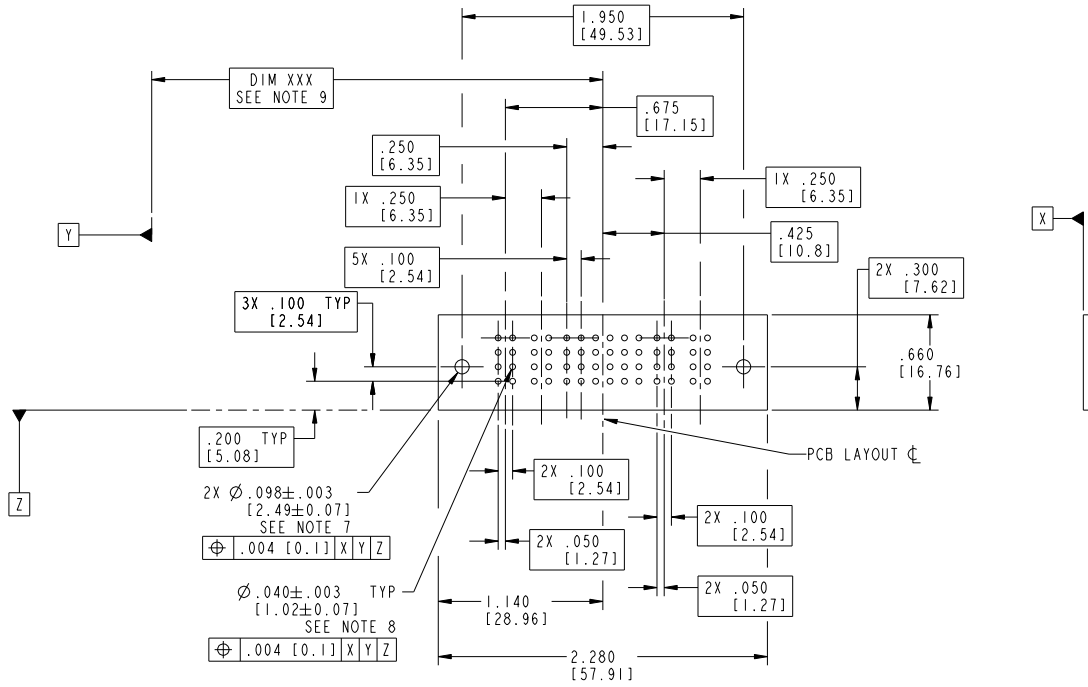

RECOMMENDED PCB LAYOUT

| | | | | | | | | | | | | | | | | | |
|-------------|----------------|----|------|------------|---------------------|----------|--|---------------------------------------|--|---------------------------|--|----------------|--|---------------|--|--------------------|--|
| mat'l code | | | | SEE NOTE 2 | | | | tolerances unless otherwise specified | | | | CUSTOMER | | FCI | | www.fciconnect.com | |
| ltr | ech no. | dr | date | linear | .XX±.01/0.X±0.3 | | | COPY | | projection | | title | | 2P + 24S + 2P | | code | |
| J | | | | angles | .XXX±.005/0.XX±0.13 | | | INCH/MM | | RIGHT ANGLE SOLDER HEADER | | product family | | PwrBlade | | 213 | |
| | | | | dr | J. SHAFFER | 01-22-02 | | scale | | A | | size | | 51730-016 | | sheet | |
| | | | | engr | M. MOSTOLLER | 01-22-02 | | 1:1 | | | | dwg no | | | | 3 of 4 | |
| | | | | chr | M. MOSTOLLER | 01-22-02 | | | | | | | | | | | |
| | | | | appd | M. MOSTOLLER | 01-22-02 | | | | | | | | | | | |
| sheet index | revision sheet | | | | | | | | | | | | | | | | |

1 | 2

Pro/E

PDM: Rev:3

STATUS: Released

Printed: Dec 20, 2010

Tous droits strictement réservés. Reproduction ou communication à des tiers interdite sans aucune forme que ce soit sans autorisation écrite du propriétaire. Propriété de c FCI. Droits de reproduction FCI.



All rights strictly reserved. Reproduction or issue to third parties in any form whatsoever is not permitted without written authority from the proprietor. Property of FCI. Copyright FCI.

1 | 2

3 |

4

PRODUCT NUMBER
51730-016_ _
NOTE ③

NOTES:

1. DIMENSIONS AND TOLERANCES ARE IN ACCORDANCE WITH ASME Y14.5M, 1994 UNLESS OTHERWISE SPECIFIED.

CONNECTORS NOTES:

② HOUSING MATERIAL: UL 94 V-0 GLASS FILLED HIGH TEMP THERMO PLASTIC
POWER CONTACT MATERIAL: COPPER ALLOY
SIGNAL PIN MATERIAL: COPPER ALLOY

③ SEE ITEM 1 & 2 IN PRINT 10064183 FOR PLATING SPEC OF 51730-016 AND 51730-016LF RESPECTIVELY.

4. "MANUFACTURER" NAME, P/N, AND DATE CODE TO APPEAR ON THIS SURFACE.

⑤ PRODUCT SPECIFICATION GS-12-149.

PCB - NOTES:

⑥ ALL HOLE DIAMETERS ARE FINISHED HOLE SIZE.

7. HOLD DOWN THROUGH HOLES ARE UNPLATED.

⑧ $\varnothing .0453 \pm 0.0010$ [1.151 \pm 0.025] DRILLED HOLES PLATED WITH 0.0003 [0.008] MIN SnPb OVER .001 [0.03] TO .003 [0.08] Cu PLATING TO ACHIEVE $\varnothing .040 \pm .003$ [1.02 \pm .07] HOLE.

9. "DIM XXX" TO BE DETERMINED BY THE CUSTOMER.

10. A Δ SYMBOL WILL BE NEXT TO ANY DIMENSION, VIEW, OR NOTE WHICH HAS BEEN MODIFIED WITH THE CURRENT DRAWING REVISION.

| | | | | | | | | | | | | | | | | | | | |
|-------------|---------|----------------|------|------------|---------------------|----------|---------|---------------------------------------|----------------|------|-------------|---------------------------|-------|---------------|--------|--------------------|--|--|--|
| mat'l code | | | | SEE NOTE 2 | | | | tolerances unless otherwise specified | | | | CUSTOMER | | FCI | | www.fciconnect.com | | | |
| ltr | ech no. | dr | date | linear | .XX±.01/0.X±0.3 | | | projection | | COPY | | title | | 2P + 24S + 2P | | | | | |
| J | | | | angles | .XXX±.005/0.XX±0.13 | | | | | | | RIGHT ANGLE SOLDER HEADER | | | | | | | |
| | | | | dr | J. SHAFFER | 01-22-02 | INCH/MM | | product family | | PwrBlade | | code | | 213 | | | | |
| | | | | engr | M. MOSTOLLER | 01-22-02 | scale | | size | | A 51730-016 | | sheet | | 4 of 4 | | | | |
| | | | | chr | M. MOSTOLLER | 01-22-02 | 1:1 | | size | | A 51730-016 | | sheet | | 4 of 4 | | | | |
| | | | | appd | M. MOSTOLLER | 01-22-02 | | | size | | A 51730-016 | | sheet | | 4 of 4 | | | | |
| sheet index | | revision sheet | | | | | | | | | | | | | | | | | |

1 | 2

Pro/E

PDM: Rev:3

STATUS: Released

Printed: Dec 20, 2010