

## Excellent Integrated System Limited

Stocking Distributor

Click to view price, real time Inventory, Delivery & Lifecycle Information:

[FCI](#)

[87610-208LF](#)

For any questions, you can email us directly:

[sales@integrated-circuit.com](mailto:sales@integrated-circuit.com)

PRODUCT NUMBER

87610-YXXLF

RoHS COMPATIBLE, SEE NOTE 7

PLATING

2 = 0.76µm GOLD/GXT  
(PdNi WITH GOLD FLASH) ON CONTACT AREA  
2µm MIN MATTE TIN ON TAIL

UNDERPLATE : 1.27µm Ni MIN

NOTES:

- 1 - HOUSING MAT'L : GLASS FILLED THERMOPLASTIC. UL94V-0 COLOR: BLUE
- 2 - PIN MATERIAL : PHOSPHOR BRONZE
- 3 - PRODUCT PACKAGED IN TUBES.
- 4 - TO DETERMINE DIMENSIONS :  
N = NUMBER OF POSITIONS PER ROW  
EXAMPLE : 8 POS N x 2.54 = 20.32mm
- 5 - NO RIGHT POLARIZATION FOR POS 04, 06, 08.  
NO LEFT POLARIZATION FOR POS 04, 06, 08, 14.
- 6 - RETENTION LEGS IN THE CENTER OF THE CONNECTOR.
- 7 - RoHS COMPATIBLE PRODUCT SPECIFICATIONS
  - a - PLATING:  
- "LF" MEANS THE PRODUCT IS LEAD-FREE,  
2µm MINIMUM MATTE TIN OVER 1.27µm  
MINIMUM NICKEL UNDERPLATE.
  - b - MANUFACTURING PROCESS COMPATIBILITY  
- THE HOUSING WILL WITHSTAND EXPOSURE TO  
260°C ±5°C SOLDER BATH TEMPERATURE FOR  
5 SECONDS IN A WAVE SOLDER APPLICATION  
WITH A 1.6mm MIN THICK CIRCUIT BOARD.
  - c - LABELLING:  
- MEETS PACKAGING SPECS AS PER GS-14-920
  - d - LEGAL STATEMENT: SEE GS-47-0004

TOTAL NUMBER OF POSITIONS	
06	26
08	34
10	40
14	44
16	50
18	60
20	64

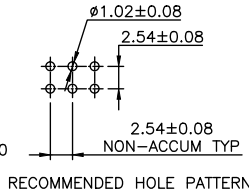
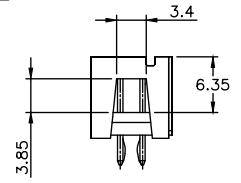
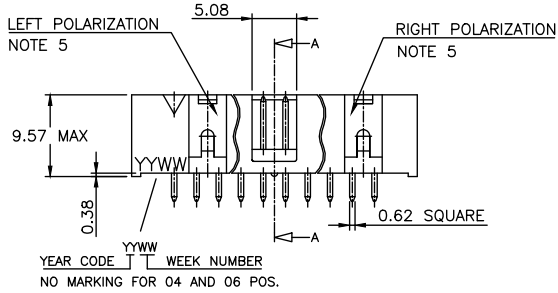
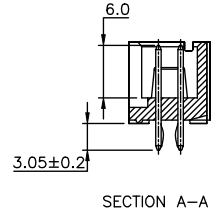
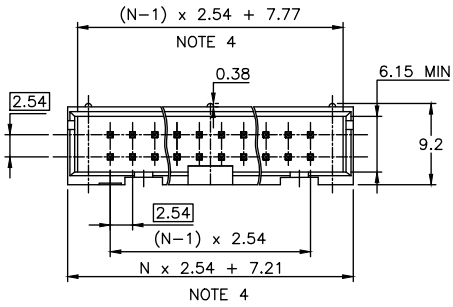

mat'l. code	surface	tolerance	projection	product family
SEE NOTES	ISO 1902	ISO 406 ISO 1101		QUICKIE
Ltr ecn no dr date	tolerances unless otherwise specified		mm	title
K F07-0198 LMU 07.05.30	angles	.X ±0.3	scale 2.5:1	SHR.LP.HEADER
L F08-0148 YOV 08.04.11	linear	.XX ±0.13		STR RETENTION LEGS
M B-19071 LMU 14.10.15		.XXX ±0.05		dwg no
N B-19094 LMU 14.10.16	dr	DLE	01.01.24	87610
H F04-0388 JCO 04.12.22	engr	JCO	04.12.20	sheet 1 of 1
J F06-0228 LMU 06.07.18	chr	JCO	04.12.22	size
sheet index	revision	sheet		A3
				type
				CUSTOMER Drawing