

Excellent Integrated System Limited

Stocking Distributor

Click to view price, real time Inventory, Delivery & Lifecycle Information:

[FCI](#)
[85812-101LF](#)

For any questions, you can email us directly:
sales@integrated-circuit.com

PRODUCT NUMBER	COLOR
85812-101LF	GREEN
85812-101NLF	NATURAL

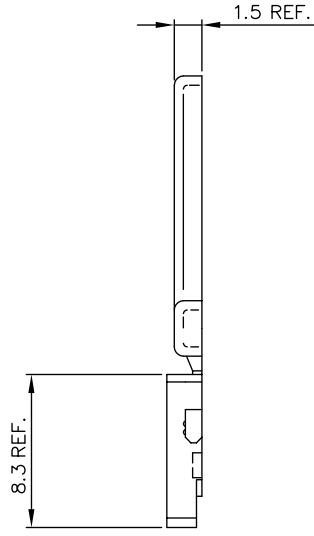
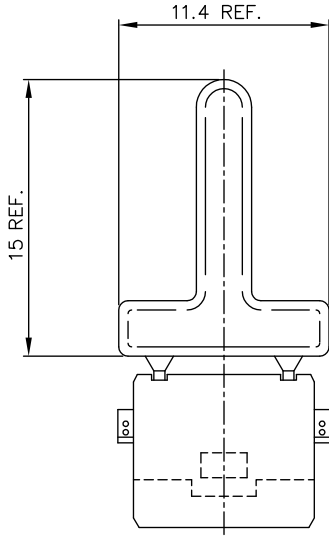

NOTES:

1. MAT'L: LIQUID CRYSTAL POLYMER, FLAME RETARDANT ACC. UL 94-V0, 30% GLASS FILLED, COLOR-GREEN.
2. THIS PRODUCT WITH "LF" SUFFIX MEETS EUROPEAN UNION DIRECTIVES AND OTHER COUNTRY REGULATIONS AS DESCRIBED IN GS -22-008.
3. THE PRODUCT IS NOT INTENDED TO BE EXPOSED TO A MANUFACTURING SOLDER PROCESS.

mat'l. code SEE NOTE 1		tolerances unless otherwise specified		CUSTOMER COPY	ELECTRONICS www.fciconnect.com
ltr	ecn no	dr	date	projection	
A	H40101	VW0	940211		title FEMALE KEY FULL, EXTENDED
B	H40259	VW0	940420		
C	H40487	DDB	940729	angles	product family METRAL (tm)
D	H40545	VW0	940831	dr	code 213
E	H50073	RVI	950201	eng	size A3
F	T03-0279	MW	030709	chr	dwg no 85812
G	bc05-0392	Clu	051017	app	sheet 1 of 1
sheet	revision	G		scale	
index	sheet	1		5:1	

PDM: Rev:G

STATUS: Released

Printed: May 19, 2061

Tous droits r serv s. Reproduction ou utilisation sans autorisation formelle de FCI est interdite sans autorisation formelle de FCI. Propri t  de FCI.

All rights reserved. Reproduction or use without written authority from FCI is not permitted without written authority from the proprietor. Property of FCI.