

Excellent Integrated System Limited

Stocking Distributor

Click to view price, real time Inventory, Delivery & Lifecycle Information:

[FCI](#)

[69273-104](#)

For any questions, you can email us directly:

sales@integrated-circuit.com

PRODUCT NUMBER
SEE TABLE

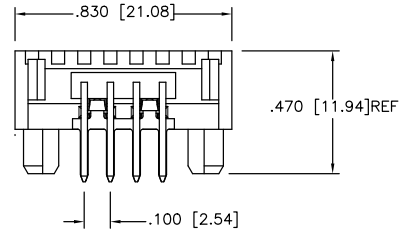
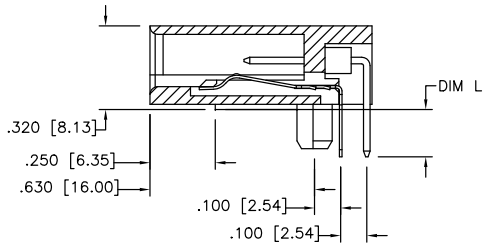
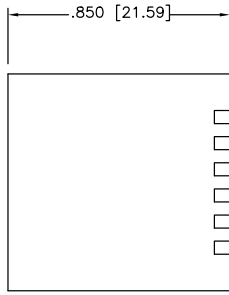

mat'l. code	surface	tolerance	projection	product family
	ISO 1302	ISO 406		LATCH-N-LOK
tr/ecn n/dr date	tolerances unless otherwise specified			title
K BX-H-00842 ZK 11/29/11	angles	lines	INCH/MM	1X4 LNL RT ANGLE HEADER ASSEMBLY
E M05-0033 ERE 2/25/05	0±2'	XXX.01/XXX.03	scale 2:1	dwg no 69273 sheet 1 of 2 size A3
F M05-0052 MHT 3/16/05	dr J. LINN	7/17/90	FCI	type Product Customer Drawing
G M06-0285 AGS 7/28/06	engr D. HORCHLER	7/17/90		
H M06-0368 AGS 9/20/06	chr D. HORCHLER	7/17/90		
J M09-0048 MHT 3/12/08	app D. HORCHLER	7/17/90		
sheet revision	K			
index sheet	1	2		

PDS: Rev :K

STATUS: released

Printed: Sep 10, 2013

FCI
FCIconnect.com
Copyright FCI

69273-XXXLF

LEAD FREE OPTION (6) (7)

COLOR (4)		
1	70343	LT GRAY OBS
2	80166	OFF WHITE
3	70634	DK GRAY OBS
4	701	BLACK
5	70541	SLATE GRAY OBS
7	70455	SILVER GRAY
8	80189	PEARL WHITE OBS
9	70419	PEBBLE GRAY

PLATING (3)	
0	30u" MIN OVER 50u"MIN Ni
3	30u" MIN OVER 50u"MIN Ni
5	50u" MIN OVER 50u"MIN Ni

PIN LENGTH	
	DIM L
0	.150/3.81
1	.110/2.79

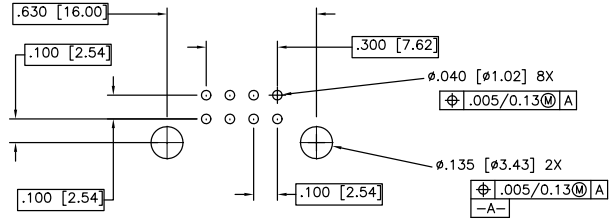

RECOMMENDED PCB LAYOUT

NOTES:

- HEADER SHROUD
MAT'L: HIGH TEMPERATURE THERMOPLASTIC.
UL-94V-0 RATED.
- GROUND CONTACT
MAT'L: COPPER ALLOY
PLATING: 100-150u"/2.54-4.06u TIN.
- SIGNAL CONTACT
MAT'L: COPPER ALLOY
PLATING: PERFORMANCE PLATING WILL BE EITHER GOLD OR GXT ON CONTACT AREA OR TAIL, OPTIONALLY (78-295u") TIN ON TAIL.
- NUMBERS SHOWN ARE FOR G.E. LEXAN AND ARE FOR REFERENCE ONLY.
- THIS ASSEMBLY U.L. APPROVED PER FILE E66906 VOL. 1, SEC 84 AND CSA APPROVED PER MASTER FILE LR 46923
- ADD LF SUFFIX AT THE END OF PART NUMBER FOR LEAD FREE OPTION.
- THE HOUSING WILL WITHSTAND EXPOSURE TO 260°C PEAK TEMPERATURE FOR 15 SECONDS IN A WAVE SOLDER APPLICATION WITH A 1.5mm MINIMUM THICK CIRCUIT BOARD. SEE APPLICATION NOTES/PROCEDURES IF THEY ARE AVAILABLE.
- THIS PRODUCT MEETS EUROPEAN UNION DIRECTIVES AND OTHER COUNTRY REGULATION AS DESCRIBED IN GS-22-008.
- PRODUCT SPEC: GS-12-003

mat'l. code	surface ISO 1302 ✓	tolerance ISO 406 ISO 1101	projection INCH/MM	product family LATCH-N-LOK
ltr	ecn	nddr	date	tolerances unless otherwise specified
K				angles linear 0±2'
				dr J. LINN 7/17/90
				engn D. HORCHLER 7/17/90
				chr D. HORCHLER 7/17/90
				app'd D. HORCHLER 7/17/90
sheet	revision			
index	sheet			
				title 1X4 LNL RT ANGLE HEADER ASSEMBLY
				scale 2:1
				dwg no 69273
				sheet 2 of 2
				size A3
				type Product Customer Drawing

4 PDS: Rev :K

STATUS: Released

Printed: Sep 10, 2013