

Excellent Integrated System Limited

Stocking Distributor

Click to view price, real time Inventory, Delivery & Lifecycle Information:

[FCI](#)
[86093247313H50013E1](#)

For any questions, you can email us directly:
sales@integrated-circuit.com

DIMENSIONS

GENERAL CHARACTERISTICS : SEE DRAWING REF. C-8609-0000

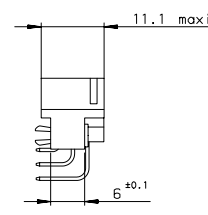
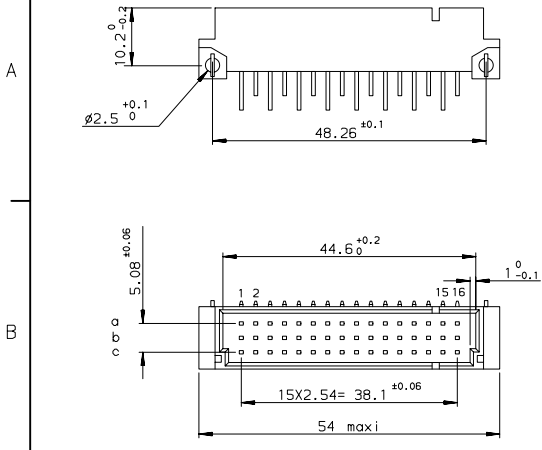

TERMINATION

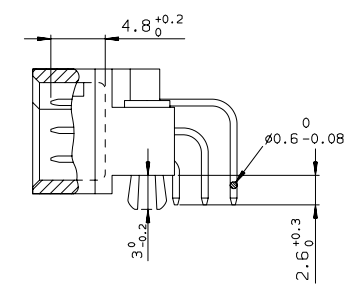

P.C. CARD DRILLING (Component side view)

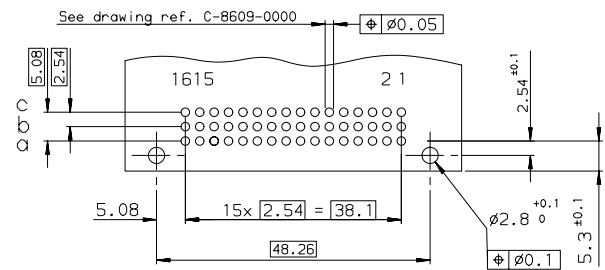

SPECIFICATION 013 = 24 contacts in position ;
row : a cavity : 1-3-5-7-9-11-13-15
row : b cavity : 2-4-6-8-10-12-14-16
row : c cavity : 1-3-5-7-9-11-13-15

Part number: **8609-324-73-13-H50-013-E1**

European Views

www.fciconnect.com		surface ISO 1302	tolerance std 150 406 ISO 1101	projection	mm
		TOLERANCES UNLESS OTHERWISE SPECIFIED			
Dr	ROUILLARD	2001/02/14	ANGULAR	size	Scale
Eng	ROUILLARD	2001/02/14	LINEAR	A3	1.5
Chr	H LEGALLIC	2001/02/14	0.XX ±0.1	ECN	LS06-0208
Appr	H LEGALLIC	2001/02/14	0.XXX ±0.1	Product family	DIN STD
		title		Spec ref	Rev.
		STANDARD MALE 3 ROW C/2		C-8609-1000	B
		catalog no		CUSTOMER	sheet 1 of 1

rev	ecn no	dr	date
A	-	-	2001/02/14
B	LS06-0208	LG0	2006/12/16
-	-	-	-
-	-	-	-
-	-	-	-
-	-	-	-

REV F - 2006-04-17