



Distributor of FCI: Excellent Integrated System Limited

Datasheet of D09P24A4PX00LF - D-Sub Connector Plug, Male Pins 9 Position Through Hole Solder

Contact us: sales@integrated-circuit.com Website: www.integrated-circuit.com

Excellent Integrated System Limited

Stocking Distributor

Click to view price, real time Inventory, Delivery & Lifecycle Information:

[FCI](#)

[D09P24A4PX00LF](#)

For any questions, you can email us directly:

sales@integrated-circuit.com

Contact us: sales@integrated-circuit.com Website: www.integrated-circuit.com

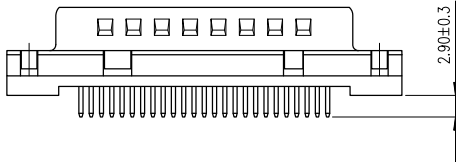
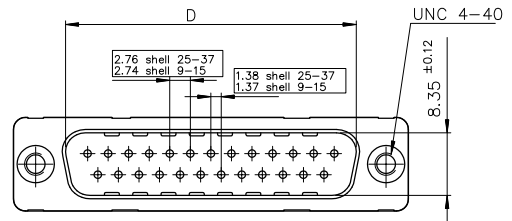
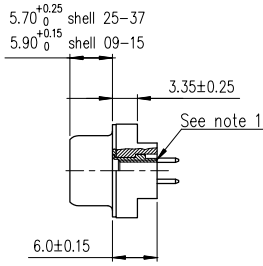
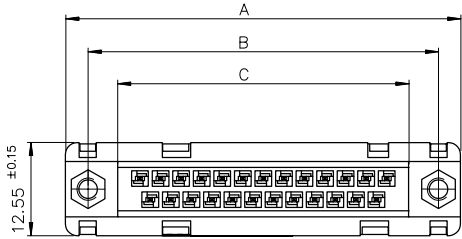

LEAD FREE PART NUMBER

SHELL	A±0.38	B±0.12	C±0.10	D±0.25	E±0.07	PART NUMBER
09	30.81	24.99	16.96	16.79	10.96	D09P24A.PX00LF
15	39.14	33.32	25.18	25.12	19.18	D15P24A.PX00LF
25	53.03	47.04	39.12	38.84	33.12	D25P24A.PX00LF
37	69.32	63.50	55.68	55.30	49.68	D37P24A.PX00LF

Plating: 4 --> flash Au
Plating: 6 --> 0.76 μ Au

PC card drilling dimensions(after plating)
(thickness 1.60±0.20mm)

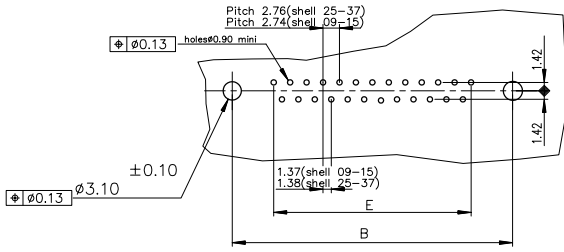

Notes:

- The nut can protrude above the surface of insulator but maintaining the footprint dimension 6.0±0.15 mm.

GENERAL CHARACTERISTICS AND ROHS INFORMATIONS:
SEE DRAWING C01-8646-0000

mat'l. code	surface	tolerance	projection	product family
	ISO 1302	ISO 406 ISO 1101		D-SUB
lfr	ecn no	dr	date	title
H	ELX-I-22878	AB	2015/01/06	MALE CONNECTOR DELTA-D STRAIGHT - SOLDER TYPE
				dwg no
				C01-8646-0097
				type
				Product Customer Drawing
sheet index	revision sheet	H		
	1			