

Excellent Integrated System Limited

Stocking Distributor

Click to view price, real time Inventory, Delivery & Lifecycle Information:

[FCI](#)
[HM1S49FERB09H6LF](#)

For any questions, you can email us directly:
sales@integrated-circuit.com

BILL OF MATERIAL

COMPLETE ASSY
 CATALOG NO
 HM1S49FERB09H6
 HM1S49FERB09H6

ITEM	PART NO	DESCRIPTION	DRAWING	1	1	QNTY
A	8626-6084	4 ROW GUIDE 24 POS. GUIDE	PE96542	1	20	---
B	8626-2845S23	CONTACT PRESS FIT	PE96091	---	---	20

CATALOG NUMBER DESCRIPTION

HM1 S 4 9 F E R B09 H -

PRODUCT FAMILY
 HM1 = METRAL HM1

PRODUCT TYPE
 S = FEMALE SIGNAL,
 STRAIGHT

NUMBER OF ROWS
 4 = 4 ROW

BODY LENGTH
 9 = NON-STANDARD

MATING CONTACT
 F = FLAT FEMALE

PERFORMANCE LEVEL
 6 = 0.75 MICRONS MIN GOLD,
 OVER NICKEL
 9 = 0.64 MICRONS MIN Pd/Ni WITH
 0.05-0.18 MICRONS GOLD FLASH,
 OVER NICKEL

INSULATING MATERIAL
 H = HIGH TEMPERATURE MATERIAL

VARIATIONS
 B09 = GUIDE, 20 SIG, GUIDE
 POS A2, B2, C2, D2 OMITTED

BOARD ATTACHMENT
 R = STANDARD STRAIGHT

PCB TERMINATION TYPE
 E = PRESS-FIT TAIL

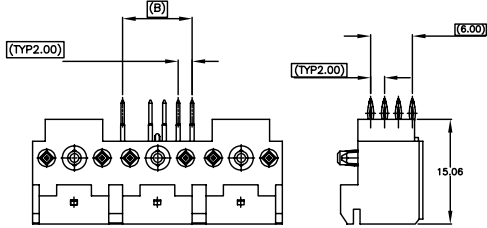

CATALOG NO. HM1S49FERB09H_ SHOWN

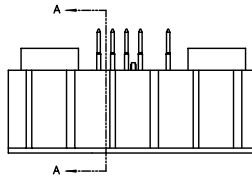

NOTES: UNLESS OTHERWISE SPECIFIED;

1 MARK PER DRAWING FD96005, COLOR-BLACK,

2 CONTACTS MUST WITHSTAND AN AXIAL LOAD OF 5N
 MIN IN DIRECTION SHOWN.

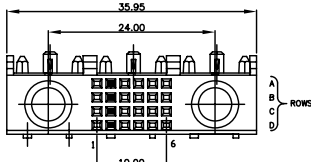

CONFIDENTIAL

mat'l. code		tolerances unless otherwise specified		INSPECTION COPY		FCI www.fciconnect.com	
ltr	ecn no	dr	date	NONE ±3[±.1]	projection	title	code
J	V12680	TAB	11/19/01	.X ±.5[±.02]		F SERIES STRAIGHT RECEPTACLE	210
K	V05-0456	VS	07/14/05	.XX ±.13[±.005]		MM	4 ROW, 3 MOD, W/GUIDES, PF
				angles	0° ±1°	product family	1 of 2
				dr	V.SEBASTIAN 07/14/05	METRAL	
				engr	J.VOLSTROF 07/14/05	size	
				chr	J.VOLSTROF 07/14/05	dwg no	
				appd	J.VOLSTROF 07/14/05	A	
sheet	revision	K	K	scale	4:1	FE96797	
index	sheet	1	2				

ACAD

PDM: Rev:K

STATUS: Released

cage code 22526
 Printed: Jun 04, 2008

Tous droits strictement réservés. Reproduction ou communication à des tiers interdite sans quelque forme que ce soit sans autorisation écrite du propriétaire. Propriété de c FCI. Droits de reproduction FCI.

FCI

All rights strictly reserved. Reproduction or issue to third parties in any form whatever is not permitted without written authority from the proprietor. Property of FCI. Copyright FCI.

Tous droits strictement réservés. Reproduction ou communication à des tiers interdite sans quelque forme que ce soit sans autorisation écrite du propriétaire. Property of FCI. Droits de reproduction FCI.

FCI

All rights strictly reserved. Reproduction or issue to third parties in any form whatever is not permitted without written authority from the proprietor. Property of FCI. Copyright FCI.

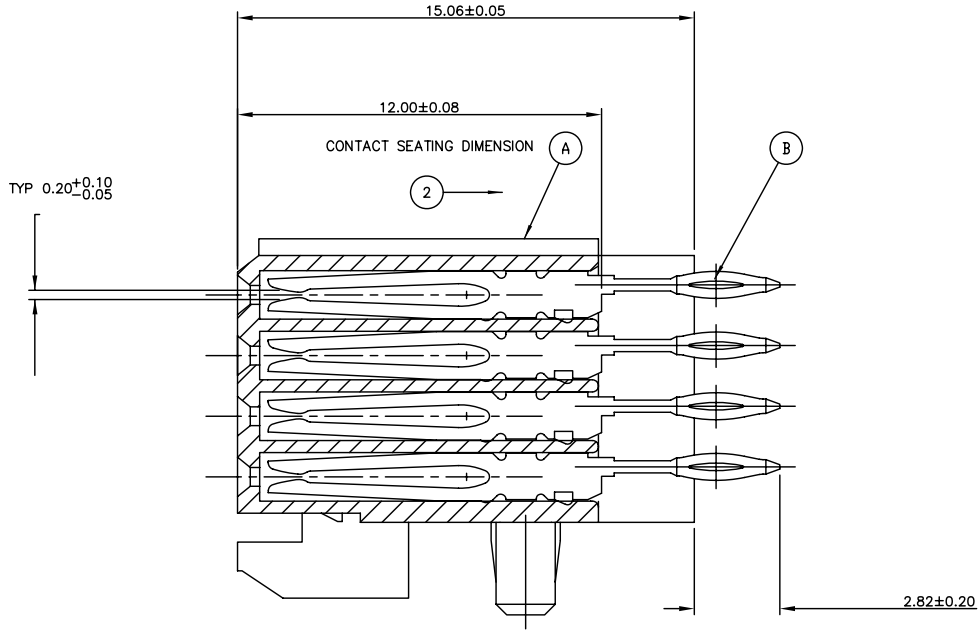

SECTION A-A

CONFIDENTIAL

mat'l. code				tolerances unless otherwise specified		INSPECTION COPY		www.fciconnect.com	
ltr	ecn no	dr	date	linear	NONE±3[±.1]	projection		title	
K					.X±.5[±.02]			F SERIES STRAIGHT RECEPTACLE	
				angles	.XX±.13[±.005]			4 ROW, 3 MOD, W/GUIDES, PF	
					0° ±1°	MM		product family	METRAL
				dr	V.SEBASTIAN 07/14/05	scale	10:1	size	A
				enrg	J.VOLSTROF 07/14/05			dwg no	FE96797
				chr	J.VOLSTROF 07/14/05			code	210
				appd	J.VOLSTROF 07/14/05			sheet	2 of 2
sheet index	revision sheet							cage code	22526

ACAD

PDM: Rev:K

STATUS: **Released**

Printed: Jun 04, 2008