

Excellent Integrated System Limited

Stocking Distributor

Click to view price, real time Inventory, Delivery & Lifecycle Information:

[FCI](#)
[86093488315755000E1](#)

For any questions, you can email us directly:
sales@integrated-circuit.com

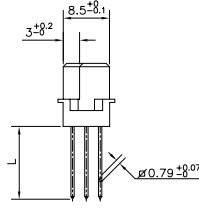
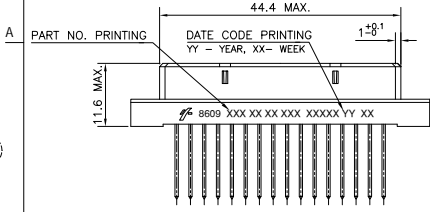
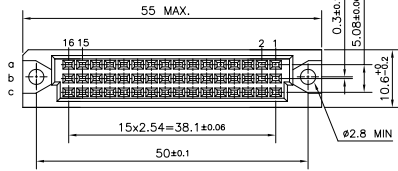

P.C.B DRILLING DETAILS

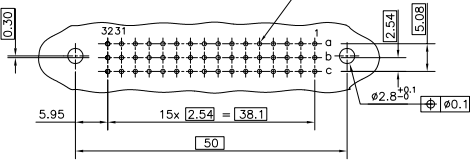

45	9.75 ^{+0.5}
35	7.06 ^{+0.7}
15	13.1 ^{+0.5}
TERM. STYLE	L

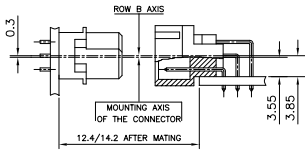

TECHNICAL SPECIFICATION

HOUSING MATERIAL : THERMOPLASTIC POLYESTER UL94V-0, GREY
 HOUSING CAN WITHSTAND EXPOSURE TO LEAD FREE WAVE SOLDERING TEMPERATURE OF 260-265°C FOR STRAIGHT CONNECTORS AS IT IS IN CLASSICAL LEAD WAVE SOLDERING AT 235-250°C

CONTACT MATERIAL : COPPER ALLOY
CONTACT ACTIVE ZONE PLATING : GOLD OVER NICKEL
CONTACT TERMINATION ZONE :
 TIN LEAD VERSION : TIN LEAD OVER NICKEL
 LEAD FREE VERSION : TIN (PURE MATTE) OVER NI

ELECTRICAL DATA
 CURRENT RATING AT 20°C : 1.5 A
 CURRENT (I MAX) : 2 A
 TEMPERATURE RANGE : -55°C/+125°C
 CONTACT RESISTANCE : ≤ 20mΩ
 INSULATION RESISTANCE : ≥ 10¹⁰ MΩ
 TEST VOLTAGE (rms) : 1000V

MECHANICAL DATA
 INSERTION FORCE PER CONTACT : ≤ 0.94N
 EXTRACTION FORCE PER CONTACT : ≥ 0.15N

REFERENCE SPECIFICATIONS : DIN 41612 / IEC 603-2

SERIES	8609	3	4	8	3	4	5	7	5	5	000E1
ROWS FITTED WITH CONTACTS											
Rows a - - - - -	1 16										
Rows a b c - - - - -	3 48										
Rows a - c - - - - -	4 32										
NUMBER OF CONTACTS											
TYPE OF INSULATOR	3 ROW FEMALE INSULATOR - - - - - 8										
METHOD OF MOUNTING	STANDARD MOUNTING - STYLE C/2 - - - - - 3										
TERMINATION											
WIRE WRAP (L- SEE TABLE)	45										
WIRE WRAP (L- SEE TABLE)	35										
WIRE WRAP (L- SEE TABLE)	15										
OPTIONS											
NO OPTION - - - - -	7										
PERFORMANCE CLASS											
DIN 41612 CLASS 3 - - - - -	4										
DIN 41612 CLASS 2 - - - - -	5										
DIN 41612 CLASS 1 - - - - -	6										
AS PER MIL C 55302/ JSS 50808 - - - - -	8										
PITCH PER ROW	2.54 - - - - - 5										
000E1 - - - - -	TIN LEAD VERSION										
E1LF - - - - -	LEAD FREE VERSION										

NOTES:-
 1. THE "LF" PRODUCTS MEET EUROPEAN UNION DIRECTIVES AND OTHER COUNTRY REGULATIONS AS DESCRIBED IN GS-22-008
 2. THE HOUSING WILL WITHSTAND EXPOSURE TO 260°C PEAK TEMPERATURE FOR 3.5 SECONDS IN A WAVE SOLDER APPLICATION WITH A 1.6 MM MINIMUM THICK CIRCUIT BOARD
 3. LEAD FREE OR RoHS DIRECTIVE LABELING TO BE PROVIDED AS PER GS-14-920 FOR LEAD FREE VERSION.

mat'l. code	surface	tolerance	projection	product family
	ISO 1302	ISO 406 ISO 1101		8609
ltr	ecn no	dr	date	title
A	104-0100	MINI	22/09/2004	DIN STANDARD RECEPTACLE
B	105-0089	MINI	19/05/2005	WIRE WRAP DIN 41612 STYLE-C/2
C	106-0082	MINI	01/06/2006	
	angles	linear	mm	scale
	dr	MINI K VANDAMTH	22/09/2004	dwg no
	enrg	RAKHEE GEORGE	22/09/2004	C-8609-2018
	chr	RAKHEE GEORGE	01/06/2006	sheet 1 of 1
	app	RAKHEE GEORGE	01/06/2006	size A3
sheet index	revision	C	1	type Product Customer Drawing