

## Excellent Integrated System Limited

Stocking Distributor

Click to view price, real time Inventory, Delivery & Lifecycle Information:

[FCI](#)  
[10009634-001LF](#)

For any questions, you can email us directly:  
[sales@integrated-circuit.com](mailto:sales@integrated-circuit.com)

PRODUCT NUMBER  
10009634-001/10009634-001LF

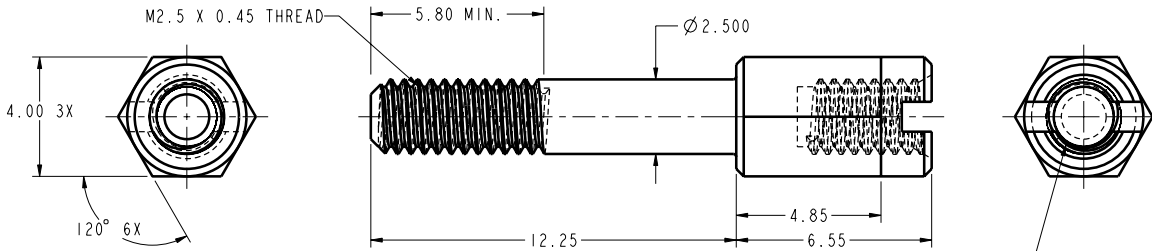
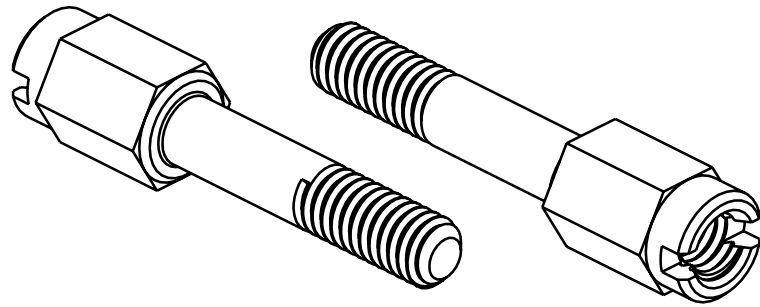

NOTES

1. MATERIAL: STAINLESS STEEL
2. MAXIMUM TORQUE OF 0.45 N-m (4 lbf-in) ALLOWED FOR THREADED STANDOFF AT ASSEMBLY TO RECEPTACLE GROUND PLATE.
3. LF SUFFIX ADDED TO THE PARTNUMBER FOR ROHS COMPLIANT VERSIONS
4. LF PRODUCTS MEET EUROPEAN UNION DIRECTIVES AND OTHER COUNTRY REGULATIONS AS DESCRIBED IN GS-12-083
5. LEAD FREE OR ROHS DIRECTIVE LABELLING TO BE PROVIDED AS PER GS-14-920 FOR LEAD FREE VERSION

M2.5 X 0.45 THREADS  
X 4.50 DEEP MIN.



Copyright FCI.

D

www.fciconnect.com				surface 3.200	tolerance std	projection	mm
TOLERANCES UNLESS OTHERWISE SPECIFIED				ANGULAR	LINEAR	size	Scale
				0.x	±.30	A4	1:1
				0.xx	±.10	ECN	106-0123
				0° ±z	0.xxx	Spec ref	
				Product family EYEMAX(tm)			
Dr	G. PETERS	2003/08/21		THREADED		Part no	10009634
Eng	D. BRANN	2003/08/21		STANDOFF		Rev.	D
Chr	HIRAN V N	2006/09/28		catalog no		CUSTOMER	sheet 1 of 1
Appr	HIRAN V N	2006/09/28					

rev	ech no	dr	date
A	V03-0936	SIP	2003/08/21
B	V03-0998	SIP	2003/09/23
C	106-0123	HVN	2006/07/26
D	106-0181	HVN	2006/09/28

REV. F - 2006-04-17