

## Excellent Integrated System Limited

Stocking Distributor

Click to view price, real time Inventory, Delivery & Lifecycle Information:

[JKL Components Corporation](#)

[LE-0503-03G](#)

For any questions, you can email us directly:

[sales@integrated-circuit.com](mailto:sales@integrated-circuit.com)

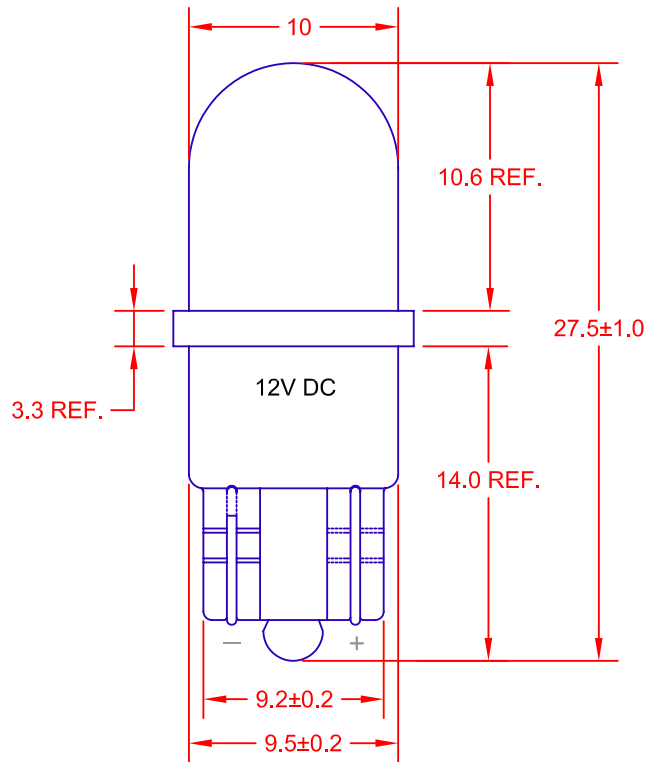

NOTES:

1. LED includes integrated diode for reverse voltage protection.
2. LED includes integrated resistor for current limiting.

Operating Temperature Range	-30°C to +85°C
Storage Temperature Range	-40°C to +100°C

TYPICAL ELECTRICAL & OPTICAL OPERATING CHARACTERISTICS

(Ta = 25 degree C)

PART NUMBER	EMITTING COLOR	AMPERAGE mA	VOLTAGE Vdc	LUMENS	μW/cm <sup>2</sup>	DOMINANT WAVELENGTH	VIEWING ANGLE DEGREES
LE-0503-03R	RED	15mA	12.0	0.70	—	630nm	20
LE-0503-03Y	YELLOW	15mA	12.0	0.70	—	595nm	20
LE-0503-03G	GREEN	15mA	12.0	2.00	—	525nm	20
LE-0503-03B	BLUE	15mA	12.0	0.70	—	470nm	20
LE-0503-03W	9000°K WHITE	15mA	12.0	2.50	—	x = 0.30 y = 0.29	20
LE-0503-03UV	ULTRA VIOLET	15mA	12.0	—	235	405	20

<b>METRIC</b> 		DIMENSIONS ARE IN MILLIMETERS TOLERANCE UNLESS OTHERWISE SPECIFIED 1 PL +/- 0.2 2 PL +/- 0.20 ANGLE +/- 0					
TITLE <b>T-3 1/4 WEDGE BASE LED</b>		DRAWN BY L. WENGSTROM	APPV'D BY DATE L.R. 6/16/10	SIZE <b>A</b>	FSCM NO. <b>55335</b>	DRAWING NO. <b>LE-0503-03</b>	
REV. NO. <b>E</b>	ADD 9000° WHITE 6/16/10	CHANGE MOL TO 27.5 ± 1.0 1/22/09	CHANGE CHARTS 8/25/08	ADDITIONAL ELECT INFO & CHNG DIMS 8/11/08	CHNG. LUMENS & ADD NOTES 1 & 2 9/14/06	ENGR RELEASE & CANCEL PL-0503-03-1 TO -6 3/3/05	
<b>- CAD DRAWING -</b> MANUAL REVISIONS NOT PERMITTED				SCALE NONE	RELEASED DATE 7/03/06	REVISION DATE 6/16/10	
					REV. NO. <b>E</b>	SHEET 1 OF 1	