

Excellent Integrated System Limited

Stocking Distributor

Click to view price, real time Inventory, Delivery & Lifecycle Information:

[TE Connectivity AMP Connectors](#)
[552230-1](#)

For any questions, you can email us directly:

sales@integrated-circuit.com

DRAWING MADE IN THIS AREA IS UNLESS OTHERWISE SPECIFIED.
 THIS DRAWING IS UNLESS OTHERWISE SPECIFIED.
 © COPYRIGHT 19 BY AMP INCORPORATED. ALL INTERNATIONAL RIGHTS RESERVED.

REV. NO.		DATE	DESCRIPTION	BY	CHKD
AA	20	9-28-94	REDWN; REV EC 0210-0834-94		

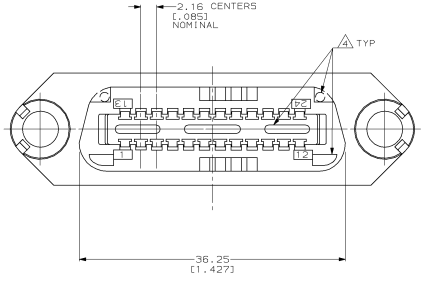
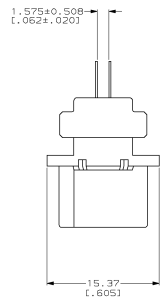
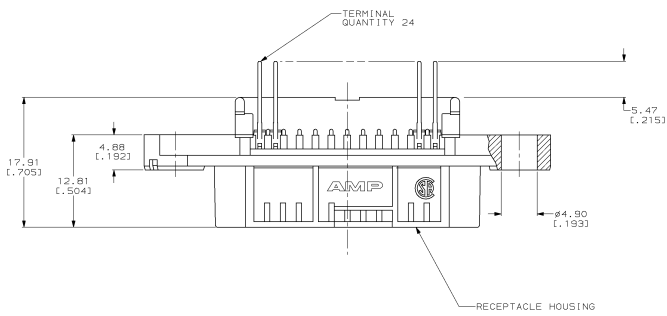
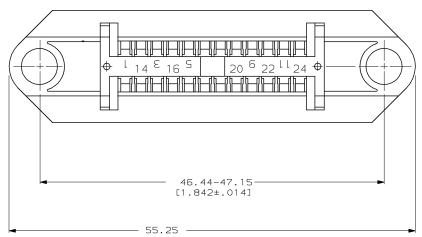

- △ DIMENSIONS ARE MAXIMUM UNLESS OTHERWISE SPECIFIED.
- 2. THE CONTACT SURFACES OF THE TERMINALS ARE COATED WITH LUBRICANT.
- △ MATERIAL: HOUSING- THERMOPLASTIC, BLACK. TERMINALS- TAILS- TIN LEAD OVER NICKEL PLATED HIGH STRENGTH COPPER ALLOY. MATING SURFACE- LOCALIZED GOLD OVER NICKEL PLATED HIGH STRENGTH COPPER ALLOY.
- △ THIS FEATURE IS A CORED AREA AND IS OPTIONAL ON PART.

DO NOT SCALE PRINT. UNLESS SPECIFIED DIMENSIONS IN MM (INCHES) TOLERANCES ON C. UNLT		DR 7-28-94 B. SIMPSON CHK 10-26-94 APPD 10-26-94 APRD 11-22-94 J. HARRIS	AMP Incorporated Harrisburg, PA 17105-3609
MATERIAL	FINISH	PRODUCT SPEC	NAME
			RECEPTACLE ASSEMBLY, 24 POSITION, EDGE MOUNTING, CHAMP-LOK®
			PART NO
			552230-1
			STATE
			PA
			CASE CODE
			00779
			DRAWING NO
			552230
			WEIGHT
			SCALE
			4:1
			SHEET
			1 OF 1

THIS DRAWING IS A CONTROLLED DOCUMENT FOR AMP INCORPORATED. IT IS SUBJECT TO CHANGE AND THE CONTROLLED DRAWING NUMBER SHOULD BE CONTACTED FOR THE LATEST REVISION.