

## Excellent Integrated System Limited

Stocking Distributor

Click to view price, real time Inventory, Delivery & Lifecycle Information:

[CUI Inc.](#)  
[CLF0251MP](#)

For any questions, you can email us directly:

[sales@integrated-circuit.com](mailto:sales@integrated-circuit.com)



**Part No: CLF0251MP**

**Date: 7/2/2007**

**Description: speaker**

**Unit: mm**

**Page No: 1 of 2**

**Specifications**

Nominal Size	25mm		
Impedance	8 Ohm $\pm$ 15%	at	1.2 KHz 1 V
Resonant frequency	650 Hz $\pm$ 130 Hz	at	1 V
Sound pressure level	70dB/w $\pm$ 3 dB	0.1 w 50 cm ave. at	1K, 1.2K, 1.5K, 2K Hz
Response	Fo Hz ~ 5 KHz max 10 dB		
Input power	Nominal 0.1 W	Handling capacity	0.2 W
Operation	must be normal at program source 0.1 W		
Buzz, rattle, etc.	must be normal at sine wave 0.9 V		
Magnet	Size: 18 x 7 x 2.5 mm		
Load test	White noise 0.1 W	for	24 hours
Heat test	70 $\pm$ 2° C	20-50% R.H.	24 hours
Humidity test	40 $\pm$ 2° C	90-95% R.H.	24 hours

**Frequency Response Curve**

Potentiometer range	50 dB
Rectifier	RMS
Lower limit frequency	20 Hz
Wr. speed	100 mm/sec

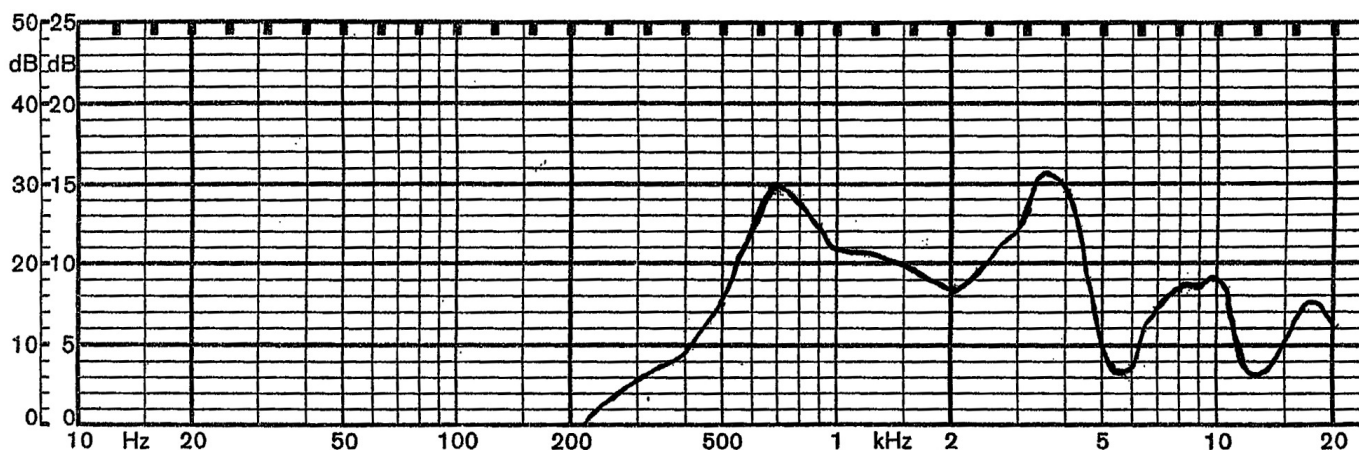

Zero level 50 dB

REV.	DESCRIPTION	DATE
A	NEW DRAWING	7/3/2007

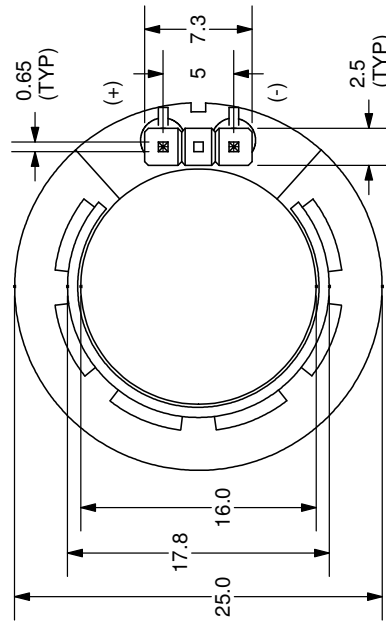
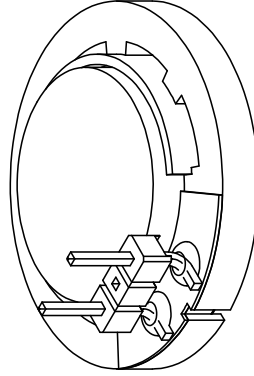
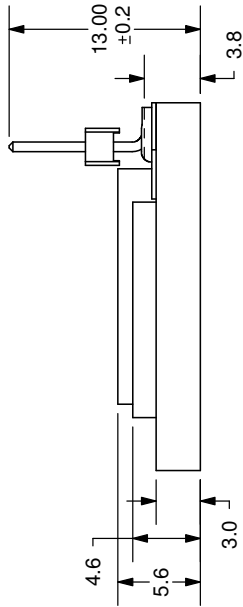

TOLERANCE:  
±0.5mm UNLESS OTHERWISE  
SPECIFIED



20050 SW 112th Ave.  
Tualatin, OR 97062  
Phone: 503-612-2300  
800-275-4899  
Fax: 503-612-2383  
Website: www.cui.com

TITLE: LOW PROFILE SPEAKER	REV: A
PART NO: CLF0251MP	UNITS: MM [INCHES]
DRAWN BY: ZRJ	APPROVED BY:
	SCALE: 2:1