

Excellent Integrated System Limited

Stocking Distributor

Click to view price, real time Inventory, Delivery & Lifecycle Information:

[Molex Connector Corporation](#)
[0009508051](#)

For any questions, you can email us directly:

sales@integrated-circuit.com

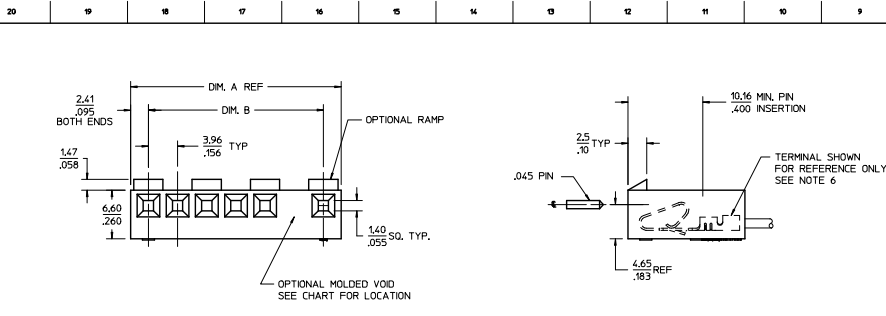

- NOTES:
1. MATERIAL: N - GLASS FILLED POLYESTER, UL94V-0, MOLDED NATURAL
 2. FINISH: SEE TERMINAL DRAWINGS
 3. PRODUCT SPECIFICATION: PS-08-50, PS-40-02, AND PS-45570-001
 4. PACKAGING INFORMATION: SEE LEGEND
 5. MATES WITH (3.96)/.156 CENTER HEADERS AND (1.14)/.045 SQUARE OR ROUND PINS
 6. HOUSING ACCEPTS STANDARD TERMINAL NOS.:
2478 (18-24 AWG) WITH (2.79)/.110 MAX. INSULATION DIA.
2578 (22-26 AWG) WITH (1.65)/.065 MAX. INSULATION DIA.
OR TRIFURCON TERMINAL NOS.:
6838 (18-24 AWG) WITH (2.79)/.110 MAX. INSULATION DIA.
7258 (22-26 AWG) WITH (1.65)/.065 MAX. INSULATION DIA.
OR MARK: TERMINAL NO.
45570 (18-20 AWG) WITH (3.12)/.123 MAX. INSULATION DIA.
 7. BOW (0.06 MM MAX) / .006 IN MIN.
 8. (0.13)/.005 MAX. FLASH ALLOWED ALONG DIMENSION B AND IN LOCKING WINDOW.
 9. THIS PART CONFORMS TO CLASS B REQUIREMENTS OF COSMETIC SPECIFICATION PS-45499-002.
 10. ALL 7-14 CIRCUIT PARTS AND 2-6 CIRCUIT PARTS MANUFACTURED BEFORE 9/21/2013 HAVE GEOMETRY ON THIS SHEET. SEE SHEET 2 FOR 2-6 CIRCUIT PARTS MANUFACTURED AFTER 9/21/2013.

| NO. OF CKTS | DIM. A | DIM. B |
|-------------|---------|--------------|
| 2 | (8.79) | (3.96)(.05) |
| | .346 | .56(.002) |
| 3 | (12.75) | (7.92)(.08) |
| | .502 | .815(.003) |
| 4 | (16.71) | (11.89)(.08) |
| | .656 | .468(.003) |
| 5 | (20.67) | (15.85)(.08) |
| | .814 | .624(.003) |
| 6 | (24.64) | (19.81)(.10) |
| | .970 | .780(.004) |
| 7 | (28.60) | (23.77)(.10) |
| | 1.126 | .936(.004) |
| 8 | (32.56) | (27.74)(.10) |
| | 1.282 | 1.092(.004) |
| 9 | (36.53) | (31.70)(.10) |
| | 1.438 | 1.248(.004) |
| 10 | (40.49) | (35.66)(.15) |
| | 1.594 | 1.404(.008) |
| 11 | (44.45) | (39.62)(.15) |
| | 1.750 | 1.560(.008) |
| 12 | (48.41) | (43.59)(.15) |
| | 1.906 | 1.716(.008) |
| 13 | (52.37) | (47.55)(.15) |
| | 2.062 | 1.872(.008) |
| 14 | (56.34) | (51.51)(.18) |
| | 2.218 | 2.028(.007) |

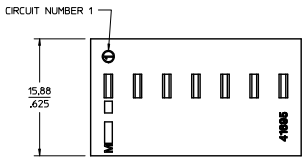

OPTION CODE D

RAMP WITH POLARIZING RIBS

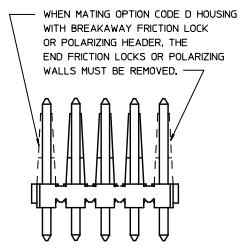
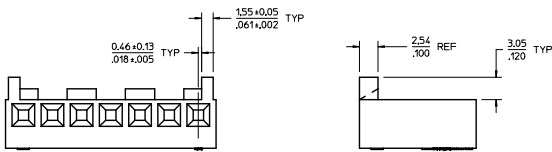

41695 - * - * N - ##
MATERIAL CODE
N = MOLDED NATURAL

| OPTION CODE | RAMP | POLARIZING RIBS | PACKAGING |
|-------------|------|-----------------|-----------------------|
| A | NO | NO | BULK PER PK-41695-001 |
| B | YES | NO | BULK PER PK-41695-001 |
| D | YES | YES | BULK PER PK-41695-001 |

VOID CODE
BLANK-NO VOIDS
NO-NO, CORRESPONDS TO CKT. NO. VOIDED
MULT. VOIDS-START WITH 51
NO. OF CKTS.

| <p>LOREX ENGRAVING</p> <p>EC NO. LCP2015-04-20</p> <p>KZ</p> <p>DRN/DFX: 20/07/18</p> <p>CHKM/PPR: 28/07/18</p> <p>APPR/MLR: 20/07/18</p> <p>CHKM/PPR: 28/07/18</p> | <p>QUALITY SYMBOLS</p> <p>∇=0 4 PLACES ±--- ±---</p> <p>∇=0 3 PLACES ±--- ±---</p> <p>∇=0 2 PLACES ±0.13 ±---</p> <p>∇=0 1 PLACE ±0.25 ±---</p> <p>∇=0 0 PLACE ±--- ±---</p> | <p>GENERAL TOLERANCES (UNLESS SPECIFIED)</p> <table border="1"> <tr><th>mm</th><th>INCH</th></tr> <tr><td>±---</td><td>±---</td></tr> <tr><td>±0.13</td><td>±---</td></tr> <tr><td>±0.25</td><td>±---</td></tr> </table> | mm | INCH | ±--- | ±--- | ±0.13 | ±--- | ±0.25 | ±--- | <p>DIMENSION STYLE</p> <p>MM ONLY</p> <p>DRAWN BY: MK HPPER DATE: 2012/10/25</p> <p>CHECKED BY: BANDERSON DATE: 2012/10/26</p> <p>APPROVED BY: FSMITH DATE: 2013/10/04</p> | <p>SCALE: 4:1</p> <p>DESIGN UNITS: METRIC</p> <p>THIRD ANGLE PROJECTION</p> | <p>TITLE: KK (3.96)/.156 CRIMP TERMINAL HOUSING</p> <p>molex</p> <p>DOCUMENT NO. SD-41695</p> <p>SHEET NO. 1 OF 2</p> |
|---|--|--|----|------|------|------|-------|------|-------|------|--|---|--|
| | mm | INCH | | | | | | | | | | | |
| | ±--- | ±--- | | | | | | | | | | | |
| | ±0.13 | ±--- | | | | | | | | | | | |
| ±0.25 | ±--- | | | | | | | | | | | | |
| <p>ANGULAR ±1/2°</p> <p>DRAFT WHERE APPLICABLE</p> <p>SIZE D</p> | <p>SEE CHART</p> <p>THIS DRAWING CONTAINS INFORMATION THAT IS PROPRIETARY TO MOLEX INCORPORATED AND SHOULD NOT BE USED WITHOUT WRITTEN PERMISSION</p> | | | | | | | | | | | | |

OPTION CODE A

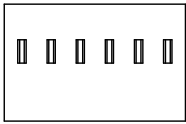
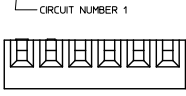
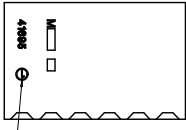

OPTION CODE B

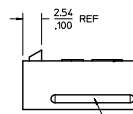
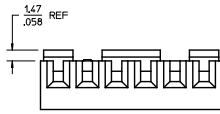

GROOVE MAY BE PRESENT (BOTH SIDES)



GROOVE MAY BE PRESENT (BOTH SIDES)

OPTION CODE D

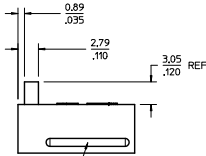
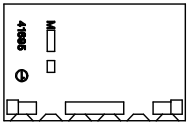

GROOVE MAY BE PRESENT (BOTH SIDES)

NOTES:
1. 2-6. CIRCUIT PARTS MANUFACTURED AFTER 9/21/2013
HAVE GEOMETRY ON THIS SHEET. SEE SHEET 1
FOR 7-14. CIRCUIT PARTS AND 2-6. CIRCUIT PARTS
MANUFACTURED PRIOR TO 9/21/2013.

| 41695-N-AN** | | |
|--------------|--------------|-------|
| PART NO. | ENG. NO. | VOIDS |
| 09-50-8020 | 41695-N-A2 | |
| 09-50-8030 | 41695-N-A3 | |
| 09-50-8040 | 41695-N-A4 | |
| 09-50-8050 | 41695-N-A5 | |
| 09-50-8060 | 41695-N-A6 | |
| 09-50-8070 | 41695-N-A7 | |
| 09-50-8080 | 41695-N-A8 | |
| 09-50-8090 | 41695-N-A9 | |
| 09-50-8100 | 41695-N-A10 | |
| 09-50-8110 | 41695-N-A11 | |
| 09-50-8120 | 41695-N-A12 | |
| 41695-0001 | 41695-N-A6-3 | 3 |
| 41695-0002 | 41695-N-A5-4 | 4 |

| 41695-N-BN** | | |
|--------------|----------------|-------|
| PART NO. | ENG. NO. | VOIDS |
| 09-50-8021 | 41695-N-B2 | |
| 09-50-8031 | 41695-N-B3 | |
| 09-50-8041 | 41695-N-B4 | |
| 09-50-8051 | 41695-N-B5 | |
| 09-50-8061 | 41695-N-B6 | |
| 09-50-8071 | 41695-N-B7 | |
| 09-50-8081 | 41695-N-B8 | |
| 09-50-8091 | 41695-N-B9 | |
| 09-50-8101 | 41695-N-B10 | |
| 09-50-8111 | 41695-N-B11 | |
| 09-50-8121 | 41695-N-B12 | |
| 09-50-8131 | 41695-N-B13 | |
| 09-50-8141 | 41695-N-B14 | |
| 09-50-9030 | 41695-N-B3-2 | 2 |
| | 41695-N-B4-2 | 2 |
| | 41695-N-B5-2 | 2 |
| | 41695-N-B6-2 | 2 |
| | 41695-N-B7-2 | 2 |
| | 41695-N-B8-2 | 2 |
| | 41695-N-B9-2 | 2 |
| | 41695-N-B10-2 | 2 |
| | 41695-N-B11-2 | 2 |
| | 41695-N-B12-2 | 2 |
| 09-50-9121 | 41695-N-B12-2 | 2 |
| | 41695-N-B14-2 | 2 |
| 09-50-9060 | 41695-N-B6-5 | 5 |
| 09-50-9070 | 41695-N-B7-6 | 6 |
| 09-50-9071 | 41695-N-B7-2 | 2 |
| 09-50-9040 | 41695-N-B4-3 | 3 |
| 09-50-9090 | 41695-N-B9-7 | 7 |
| | 41695-N-B14-13 | 13 |
| 09-50-9136 | 41695-N-B15-5 | 5 |
| 09-50-9137 | 41695-N-B13-8 | 8 |
| 09-50-9050 | 41695-N-B5-51 | 2,4 |
| 09-50-9061 | 41695-N-B6-3 | 3 |
| 09-50-9080 | 41695-N-B8-2 | 2 |
| 41695-0005 | 41695-N-B7-3 | 3 |
| 41695-0006 | 41695-N-B14-51 | 5,9 |

| 41695-N-DN** | | |
|--------------|---------------|-------|
| PART NO. | ENG. NO. | VOIDS |
| 09-50-8023 | 41695-N-D2 | |
| 09-50-8033 | 41695-N-D3 | |
| 09-50-8043 | 41695-N-D4 | |
| 09-50-8053 | 41695-N-D5 | |
| 09-50-8063 | 41695-N-D6 | |
| 09-50-8073 | 41695-N-D7 | |
| 09-50-8083 | 41695-N-D8 | |
| 09-50-8093 | 41695-N-D9 | |
| 09-50-8103 | 41695-N-D10 | |
| 09-50-8113 | 41695-N-D11 | |
| 09-50-8123 | 41695-N-D12 | |
| 09-50-8133 | 41695-N-D13 | |
| 09-50-8143 | 41695-N-D14 | |
| 09-50-9053 | 41695-N-D5-2 | 2 |
| 09-50-9094 | 41695-N-D9-3 | 3 |
| 09-50-9033 | 41695-N-D3-2 | 2 |
| 09-50-9043 | 41695-N-D4-2 | 2 |
| 09-50-9063 | 41695-N-D6-2 | 2 |
| 09-50-9073 | 41695-N-D7-2 | 2 |
| 09-50-9044 | 41695-N-D4-3 | 3 |
| 41695-0003 | 41695-N-D07-5 | 5 |

| QUALITY SYMBOLS | GENERAL TOLERANCES (UNLESS SPECIFIED) | DIMENSION STYLE | | SCALE | DESIGN UNITS | THIRD ANGLE PROJECTION |
|-----------------|--|-----------------|--------|-------|--------------|------------------------|
| | | MM ONLY | METRIC | | | |
| ∇=0 | 4 PLACES ±.005 | INCH | DATE | 4:1 | METRIC | THIRD ANGLE PROJECTION |
| ∇=0 | 3 PLACES ±.010 | INCH | DATE | | | |
| ∇=0 | 2 PLACES ±0.13 | INCH | DATE | | | |
| ∇=0 | 1 PLACE ±0.25 | INCH | DATE | | | |
| ∇=0 | 0 PLACE ±.000 | INCH | DATE | | | |
| | ANGULAR ±1/2° | | | | | |
| | DRAFT WHERE APPLICABLE MUST REMAIN WITHIN DIMENSIONS | | | | | |

moLEX
 KK (3.96)/.156 CRIMP TERMINAL HOUSING
 SEE CHART
 MATERIAL NO. SD-41695
 DOCUMENT NO. SD-41695
 SHEET NO. 2 OF 2