

Excellent Integrated System Limited

Stocking Distributor

Click to view price, real time Inventory, Delivery & Lifecycle Information:

[Schurter](#)
[4840.1220](#)

For any questions, you can email us directly:
sales@integrated-circuit.com

DC Plug/Socket
www.schurter.com/PG12_2

DC Connector, Plug, 5.5x3.3 mm, 2-pole, solder terminal



Description

- Solder terminal:
for cable mounting
- Low Voltage DC Plug and Socket
- DC Plug: 2-pole, straight

Technical Data

Diameter	5.5 mm / 3.3 mm / 1 mm
Number of Poles	2-pole
Ratings DC	2A / 13.5VDC
Dielectric Strength	500VDC
Insulation Resistance	> 100 MΩ @ 500VDC

Allowable Operation Temp.	-20°C to 70°C
Terminal	solder terminal nickel-plated
Style	straight
Lifetime	5000 Insertions

Dimensions

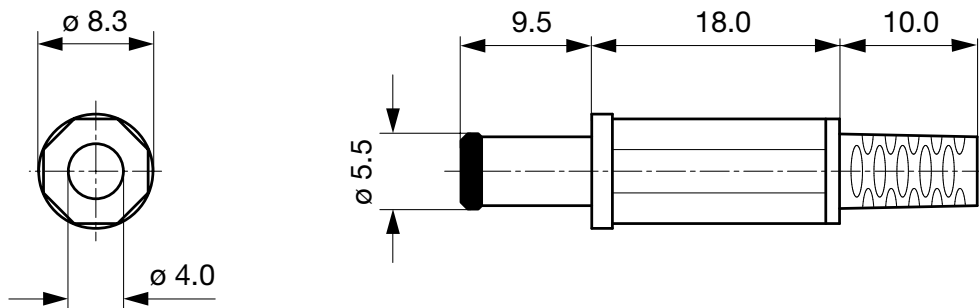

Cable diameter max. 4.0 mm

All Variants

Product group	Diameter [mm]	Number of Poles	Terminal	Order Number
DC Plug/Socket	5.5	2-pole	solder terminal	4840.1220

Availability for all products can be searched real-time: <http://www.schurter.com/Stock-Check/Stock-Check-SCHURTER>

Packaging unit 100 Pcs

Mating Outlets/Connectors

Category / Description



[DC Plug/Socket Overview complete](#)

4840, solder terminal, Socket, 5.9 mm, 2-pole, DC Plug/Socket

[4840.2220](#)

4840, PCB terminals, Socket, 6.0 mm, 2-pole, DC Plug/Socket

[4840.2221](#)

[DC Plug/Socket further types to 4840.1220](#)