



Distributor of Molex Connector Corporation: Excellent Integrated System Limited
Datasheet of 0474910001 - Connector Receptacle USB micro B 5 Position Board Cutout,
Surface Mount, Right Angle

Contact us: sales@integrated-circuit.com Website: www.integrated-circuit.com

Excellent Integrated System Limited

Stocking Distributor

Click to view price, real time Inventory, Delivery & Lifecycle Information:

[Molex Connector Corporation](#)
[0474910001](#)

For any questions, you can email us directly:
sales@integrated-circuit.com

Contact us: sales@integrated-circuit.com Website: www.integrated-circuit.com

- NOTE :
- MATERIAL :
 HOUSING : LCP, BLACK, UL94V-0
 TERMINAL : COPPER ALLOY THICKNESS = 0.15 MM
 SHIELD CASE : STAINLESS STEEL THICKNESS = 0.30 MM
 - PLATING :
 TERMINAL:
 CONTACT AREA : GOLD FLASH OVER MINIMUM 0.75 MICRON Pd/Ni
 SOLDER TAIL AREA : GOLD FLASH
 UNDER PLATING : NICKEL 2.0 MICRON MINIMUM.
 SHIELD :
 MATTE TIN 3.8 MICRON MINIMUM.
 UNDER PLATING : NICKEL 1.27 MICRON MINIMUM.
 - TAIL & NAIL COPLANARITY 0.08 mm MAXIMUM.
 - PACKAGING SPECIFICATION : PK-47491-001
 - PRODUCT SPECIFICATION : PS-47642-001
 - COMPLIANT TO RoHS DIRECTIVE 2011/65/EU AND ELV DIRECTIVE 2000/53/EC.

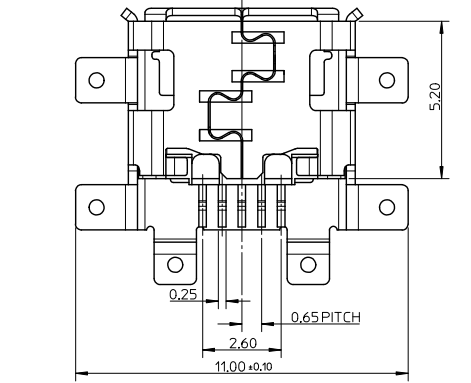
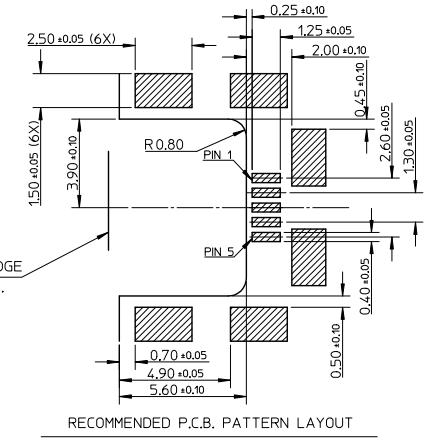
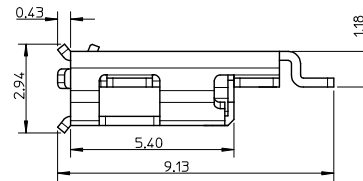
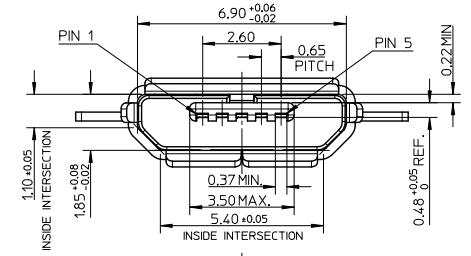
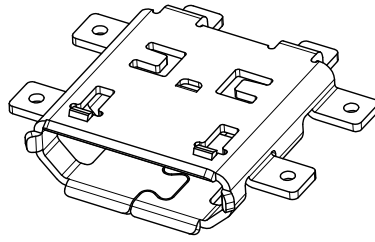
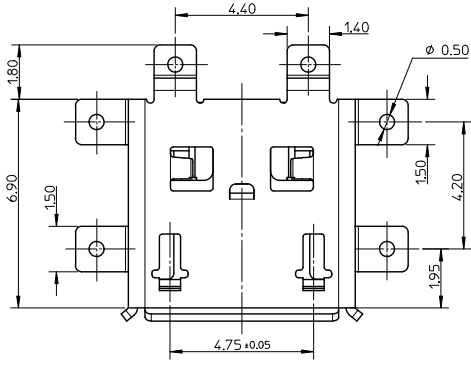

OBS 47491-0002 EC NO: SH2016-0284 DRAWN: ZHANG 2016/04/14 CHKD: ZHANG 2016/04/14 APPR: ATIN 2016/04/18	DESCRIPTION REV	QUALITY SYMBOLS	GENERAL TOLERANCES (UNLESS SPECIFIED)		DIMENSION STYLE MM ONLY		SCALE 8:1	DESIGN UNITS METRIC	THIRD ANGLE PROJECTION		
		▽=0	4 PLACES ±	---	---	DRAWN BY XJSONG	DATE 2006/04/28	TITLE MICRO USB B REC. MIDDLE MOUNT ASS'Y molex DOCUMENT NO. SD-47491-001 SHEET NO. 1 OF 1			
		▽=0	3 PLACES ±	---	---	CHECKED BY WANG	DATE 2006/04/28				
		▽=0	2 PLACES ±	0.25	---	APPROVED BY JNCHEN	DATE 2006/04/28				
	1 PLACE ±	0.25	---	MATERIAL NO. 47491-0001							
		0 PLACE ±									
ANGULAR ± 3 °			DRAFT WHERE APPLICABLE MUST REMAIN WITHIN DIMENSIONS		SIZE A3		THIS DRAWING CONTAINS INFORMATION THAT IS PROPRIETARY TO MOLEX INCORPORATED AND SHOULD NOT BE USED WITHOUT WRITTEN PERMISSION				