

## Excellent Integrated System Limited

Stocking Distributor

Click to view price, real time Inventory, Delivery & Lifecycle Information:

[E-Switch](#)  
[TL3303F100QG](#)

For any questions, you can email us directly:

[sales@integrated-circuit.com](mailto:sales@integrated-circuit.com)

SHEET 1 OF 1

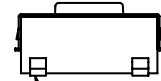
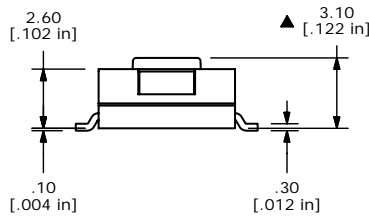
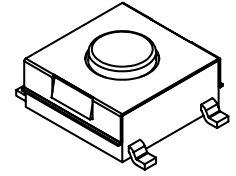
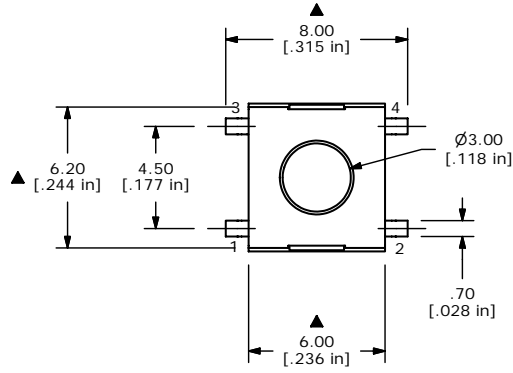
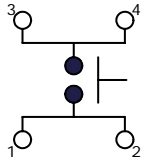
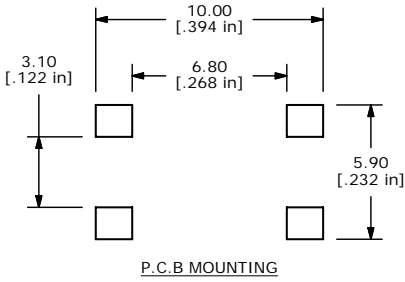

TERMINALS TO BE COPLANAR WITH IN 0.10mm

- NOTES:
1. ALL DIMENSIONS IN MM [INCH]
  2. GENERAL TOLERANCE: X.X=±0.4  
X.XX=±0.25
  3. TERMINAL NUMBERS FOR REF ONLY.
  4. TRAVEL: 0.25mm +0.2/-0.1
  5. RATING: 50mA, 12VDC
  - ▲ 6. OPERATING FORCE: 100±50gf
  7. CONTACT RESISTANCE: 100M OHM MAX.
  - ▲ 8. ACTUATOR COLOR: BROWN
  9. ▲DENOTES CRITICAL PARAMETER
  - ▲ 10. PACKAGING: TAPE AND REEL 1,500 PCS PER
  - ▲ 11. 2002/95/EC (ROHS) COMPLIANT

**E-SWITCH®**

D	16024	UPDATE ACTUATOR COLOR	5/16/06	CT
C	15915	REVISED REDRAWN	3/29/06	PH
REV	PCR NO	DESCRIPTION	DATE	BY

TITLE TL3303F100QG				
SCALE 4:1	DATE 3/29/2006	DR --	DWG P010425	REV D

THE INFORMATION CONTAINED IN THIS DOCUMENT IS PROPRIETARY TO E-SWITCH AND IS NOT TO BE COPIED OR TRANSFERRED