

Excellent Integrated System Limited

Stocking Distributor

Click to view price, real time Inventory, Delivery & Lifecycle Information:

[E-Switch](#)
[TL58VF160Q](#)

For any questions, you can email us directly:

sales@integrated-circuit.com

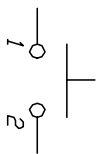
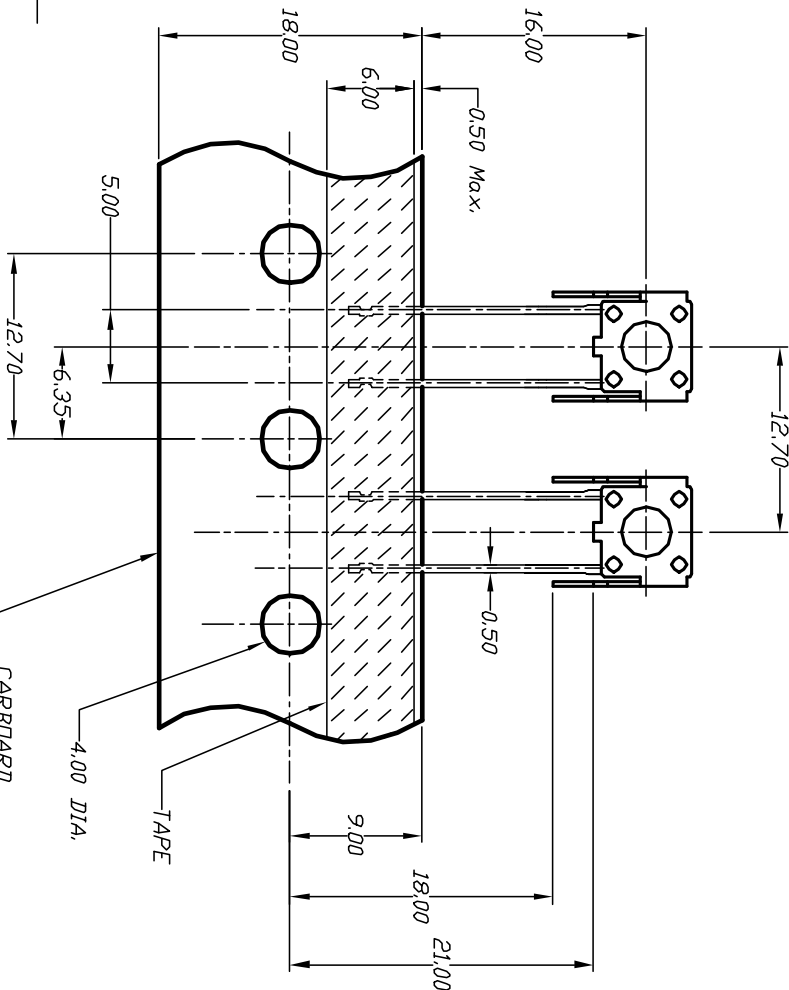
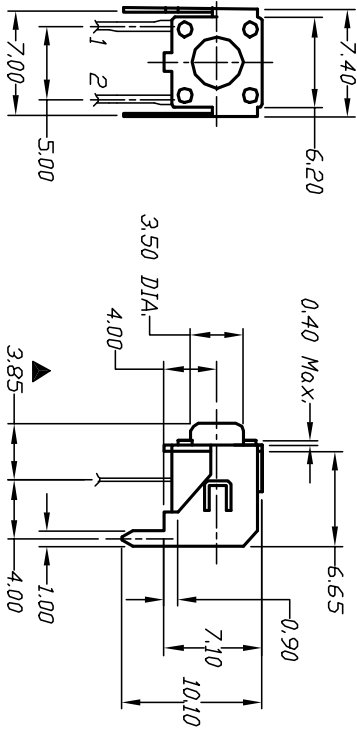
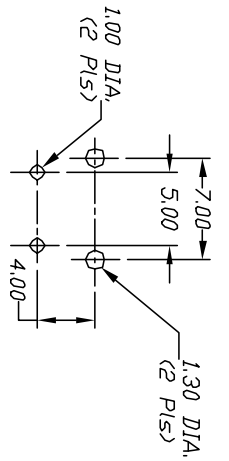

CIRCUIT: SPST

CONTACT CONFIGURATION

- NOTES:
1. ALL DIMENSIONS IN MM
 2. GENERAL TOLERANCE: $X.XX = \pm 0.4$
 $X.XXX = \pm 0.25$
 3. TERM. NOS. FOR REF. ONLY
 4. CONTACT RATING: 50mA, @12VDC
 5. OPERATING FORCE: $160 \pm 50gf$
 6. TRAVEL: $0.25 + 0.2 / - 0.1mm$
 7. CONTACT RESISTANCE: 100 milliohms Max.
 8. CARRIER IS FOLDED EVERY 25 PITCHES
(24 SWITCHES PER FOLD)
 9. 700 SWITCHES PER BOX
 10. DESIGNATE MAJOR DIMENSIONS

B	13210	NOTE 9 WAS 1000	6/13/03	AR
A	12650	RELEASED FOR PRODUCTION	12/20/02	
REV.	ECV No.	DESCRIPTION	DATE	CHKD

TITLE		SCALE		DATE		DR		DWG		REV	
TL 58 V F160 Q		2:1		12/20/02		CB		P010683		B	

E-SWITCH®

THE INFORMATION CONTAINED IN THIS DOCUMENT IS PROPRIETARY TO E-SWITCH AND IS NOT TO BE COPIED OR TRANSMITTED