

Excellent Integrated System Limited

Stocking Distributor

Click to view price, real time Inventory, Delivery & Lifecycle Information:

[E-Switch](#)
[100AWSP1T2B4M2RE](#)

For any questions, you can email us directly:

sales@integrated-circuit.com

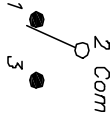
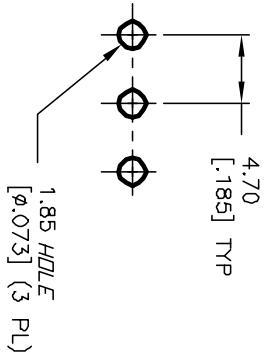

| SWITCH FUNCTION | | |
|-----------------|--------|--------|
| POS. 1 | POS. 2 | POS. 3 |
| DN | NONE | DN |
| 2-3 | OPEN | 2-1 |

NOTES:

1. ALL DIMENSIONS IN MM [INCH]
2. GENERAL TOLERANCE: X.X=±0.4
X.XX=±0.25
3. TERMINAL NUMBERS FOR REF ONLY
4. RATING: 0.4VA @20V ACor DC max.
5. FIXED TERM. & MOVING CONTACT:
Copper Alloy w/Gold plate over
Nickel plate.
6. ELECTRIC LIFE: 40,000 make-and-break cycles
at full load.
7. INSULATION RESISTANCE: 1,000 Mega-ohm min.
8. DIELECTRIC STRENGTH: 1,000 V RMS @sea level.
9. OPERATING TEMP.: -30°C to 85°C

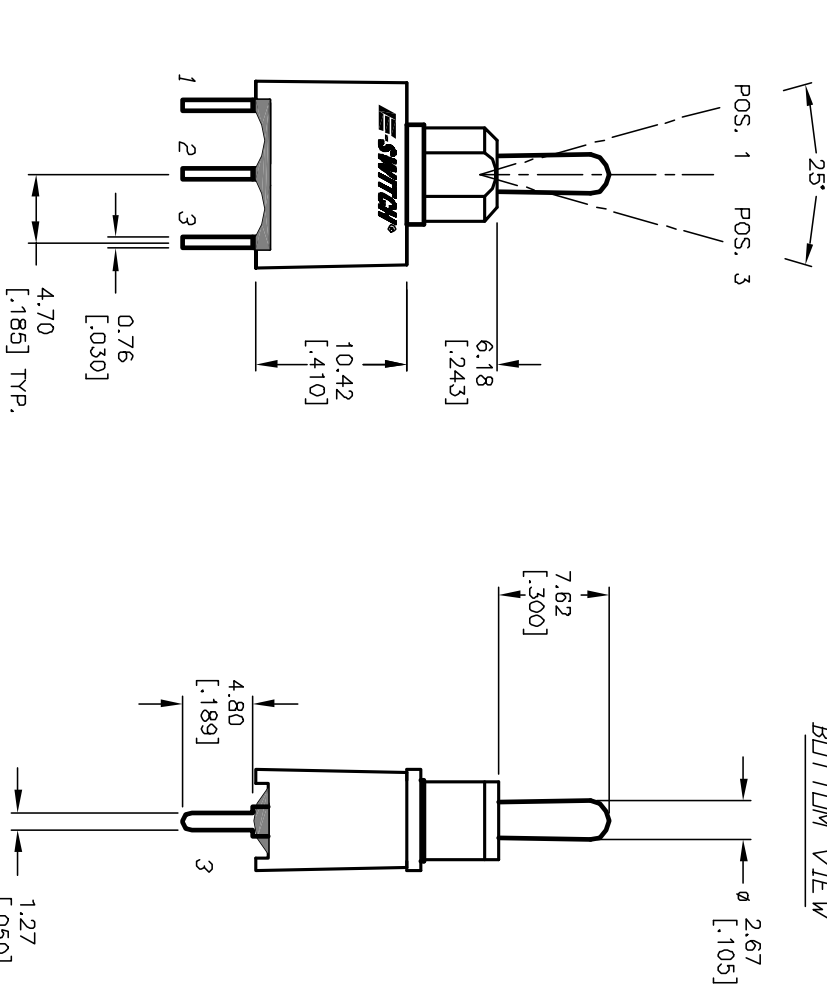
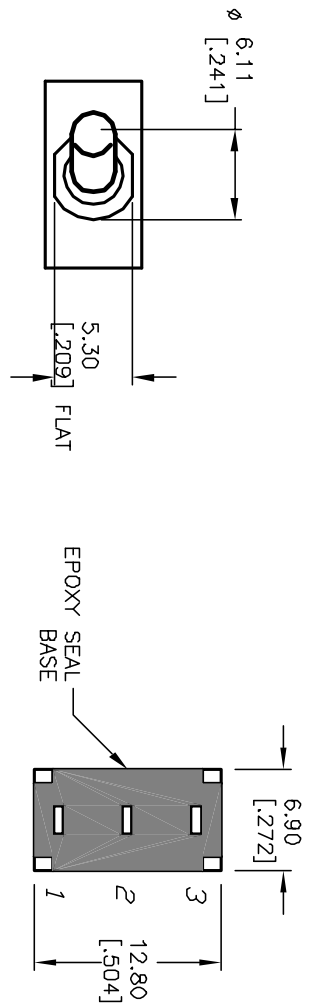

| | | | | | |
|------|---------|----------|-------------|---------|------|
| REV. | ECN No. | RELEASED | DESCRIPTION | DATE | CHKD |
| A | I2363 | | | 9/20/02 | CB |

| | | | | | | | | | | | |
|---|--|-------|--|---------|--|----|--|---------|--|-----|--|
| TITLE | | SCALE | | DATE | | DR | | DWG | | REV | |
| 100A WSP-1 T2 B4 M2 R E (GOLD CONTACTS) | | 2:1 | | 9/20/02 | | CB | | T101032 | | A | |

E-SWITCH®

THE INFORMATION CONTAINED IN THIS DOCUMENT IS PROPRIETARY TO E-SWITCH AND IS NOT TO BE COPIED OR TRANSMITTED