

Excellent Integrated System Limited

Stocking Distributor

Click to view price, real time Inventory, Delivery & Lifecycle Information:

[E-Switch](#)
[200MSP2T5B2VS2RE](#)

For any questions, you can email us directly:

sales@integrated-circuit.com

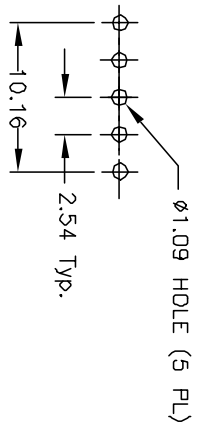
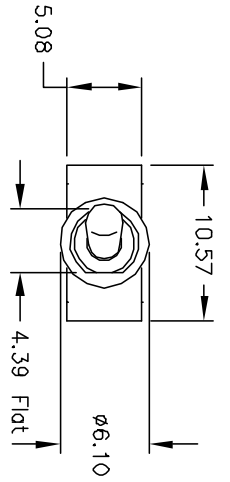

RECOMMENDED P.C.B. LAYOUT

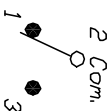
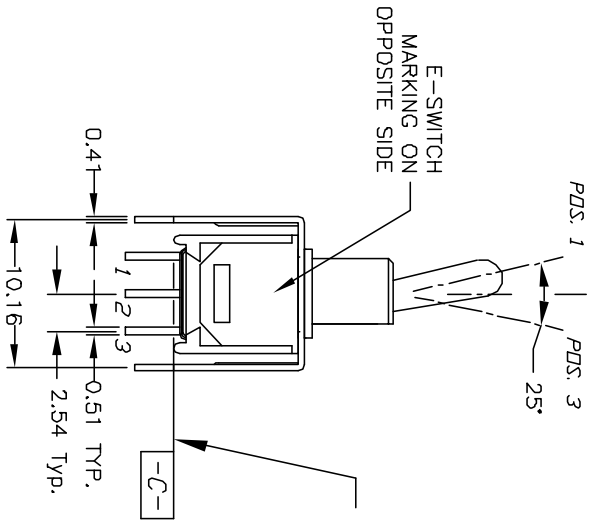
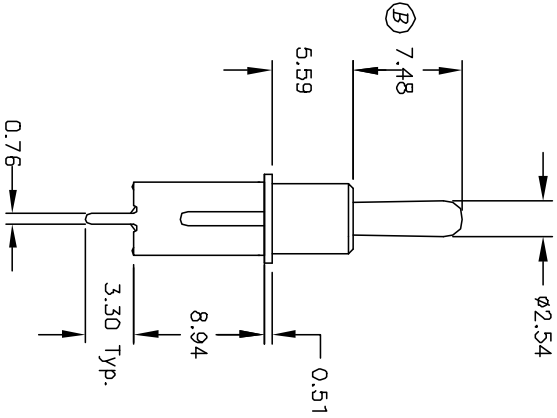

CIRCUIT: SPDT CONTACT CONFIGURATION

SWITCH FUNCTION			
PDS: 1	PDS: 2	PDS: 3	
DN	NONE	(DN)	
2-3	OPEN	2-1	

() =Momentary

- NOTES:
1. ALL DIMENSIONS IN MM
 2. GENERAL TOLERANCE: X.X=±0.4
X.XX=±0.25
 3. TERM. NOS. FOR REF. ONLY
 4. CONTACT RATING: 0.4 (VA) max. @20 VAC or DC max.
 5. FIXED TERMINAL & MOVING CONTACT: Cu alloy w/ Gold plate over Ni plate.
 6. ELECTRIC LIFE: 30,000 make-and-break cycles at full load.
 7. INSULATION RESISTANCE: 1,000 M ohm min.
 8. DIELECTRIC STRENGTH: 1,000 V RMS @sea level.
 9. OPERATING TEMP.: -30°C to 85°C

REV.	ECN No.	DESCRIPTION	DATE	CHKD
B	11538	REVISED PART DESCRIPTION	6/11/01	CJB
		THE INFORMATION CONTAINED IN THIS DOCUMENT IS PROPRIETARY TO E-SWITCH AND IS NOT TO BE COPIED OR TRANSFERRED		

TITLE		SCALE		DATE		DR		DWG		REV	
200 MSP-2 T5 B2 VS2 R E		2:1		6/11/01		CJB		T213010		B	
E-SWITCH®											