

Excellent Integrated System Limited

Stocking Distributor

Click to view price, real time Inventory, Delivery & Lifecycle Information:

[E-Switch](#)
[300AWSP3J5M2QE](#)

For any questions, you can email us directly:

sales@integrated-circuit.com

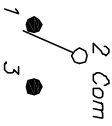

SWITCH FUNCTION		
POS. 1	POS. 2	POS. 3
DN	DFP	DN
2-3	DPEN	2-1

NOTES:

1. ALL DIMENSIONS IN MM [INCH]
2. GENERAL TOLERANCE: X.X=±0.4
X.XX=±0.25
3. TERM. NOS. FOR REF. ONLY
4. RATING: 5A @120VAC or 28VDC
2A @250VAC
5. MATERIAL: FIXED TERMINAL & MOVING CONTACT
Copper Alloy w/Silver plate
6. CONTACT RESISTANCE: 10mILLI Ohms max initial
@2-4VDC, 100mA for AG & AU
7. ELECTRICAL LIFE: 30,000 make-and-break
cycles at full load.
8. INSULATION RESISTANCE: 1,000M ohm min.
9. DIELECTRIC STRENGTH: 1000V RMS @sea level
10. OPERATING TEMP.: -30°C to 85°C

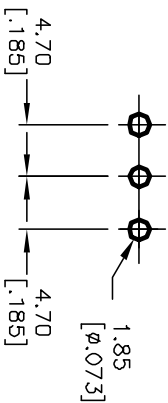
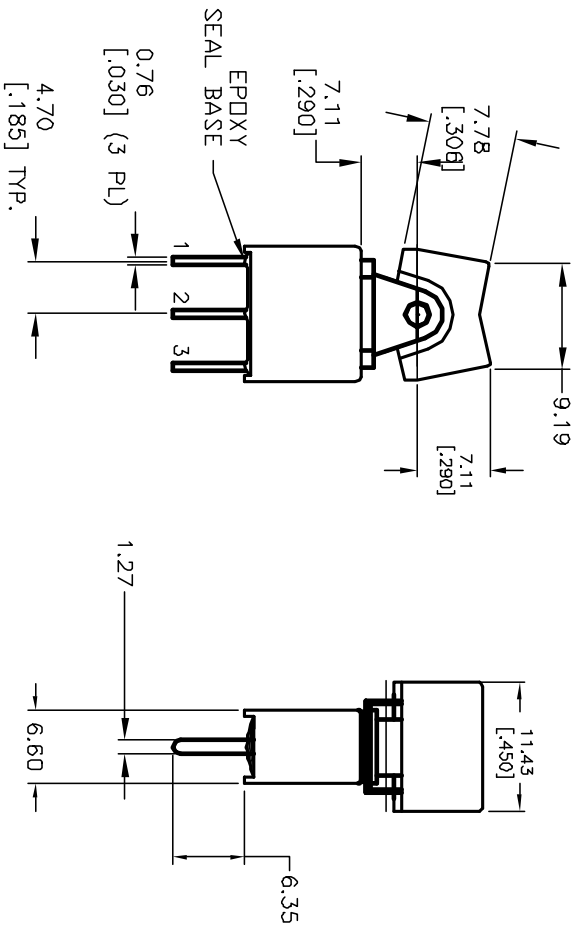

RECOMMENDED PCB LAYOUT
 NOT TO SCALE

REV.	ECN NO.	DESCRIPTION	DATE	CHKD
A	12784	RELEASED	2/3/03	CJB

TITLE	SCALE	DATE	DR	DWG	REV
300A WSP-3 J5M2 QE	2:1	2/3/03	CJB	T301352	A



THE INFORMATION CONTAINED IN THIS DOCUMENT IS PROPRIETARY TO E-SWITCH AND IS NOT TO BE COPIED OR TRANSMITTED