

## Excellent Integrated System Limited

Stocking Distributor

Click to view price, real time Inventory, Delivery & Lifecycle Information:

[E-Switch](#)  
[320.2E11WHTGRNLED](#)

For any questions, you can email us directly:

[sales@integrated-circuit.com](mailto:sales@integrated-circuit.com)

SHEET OF

PARTS LIST				
Item	Qty.	Dwg. No.	Part No.	
1	1	D062006	GRN LED	
2	1	B01ME11	320 E1-1 BODY	
3	1	B042001	320.2 CAP WHT	
4	1	B050001	320 E1-1 CONTACT DOME	
5	1	B070001	320.2 LED HOLDER	

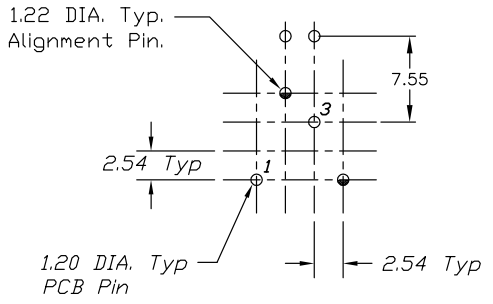
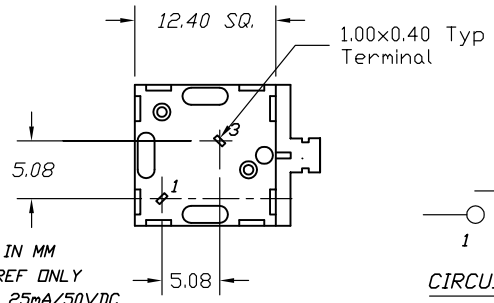
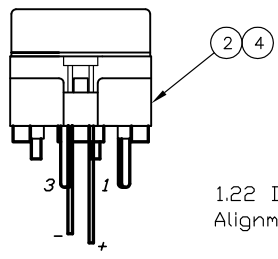
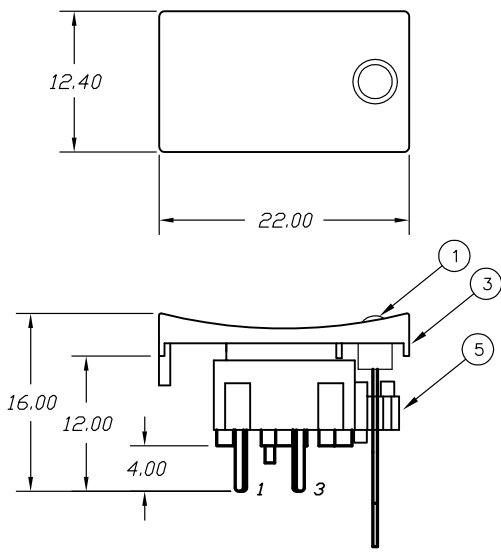

RECOMMEND P.C.B LAYOUT

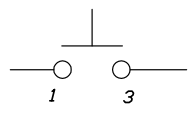

CIRCUIT: SPST  
CONTACT CONFIGURATION

- NOTES:
1. ALL DIMENSIONS IN MM
  2. TERM. NOS. FOR REF ONLY
  3. CONTACT RATING: 25mA/50VDC
  4. TRAVEL: .7mm (.028")
  5. OPERATING FORCE: 120gf

REV.	ECN No.	DESCRIPTION	DATE	CHKD
A	14423	RELEASED FOR PRODUCTION	10/25/04	AR

<b>E-SWITCH®</b>				
TITLE 320.2E11WHTGRNLED				
SCALE	DATE	DR	DWG	REV
2:1	10/25/04	AR	XB0908A	A

THE INFORMATION CONTAINED IN THIS DOCUMENT IS PROPRIETARY TO E-SWITCH AND IS NOT TO BE COPIED OR TRANSFERRED