

Excellent Integrated System Limited

Stocking Distributor

Click to view price, real time Inventory, Delivery & Lifecycle Information:

[E-Switch](#)
[400MDP3R6WHTM1QE](#)

For any questions, you can email us directly:

sales@integrated-circuit.com

SHEET OF

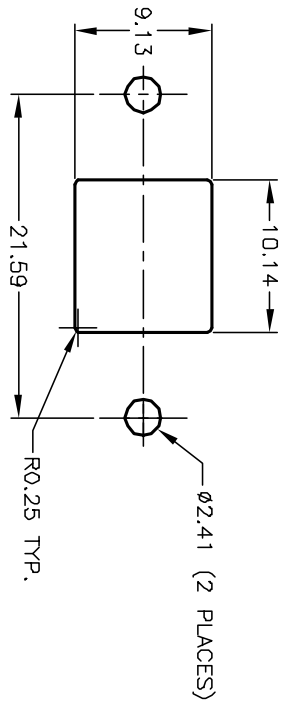

RECOMMEND PANEL MOUNTING

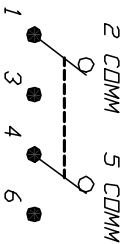

CONTACT CONFIGURATION

SWITCH FUNCTION		
PDS. 1	PDS. 2	PDS. 3
DN	OFF	DN
2-3-5-6	DPEN	2-1-5-4

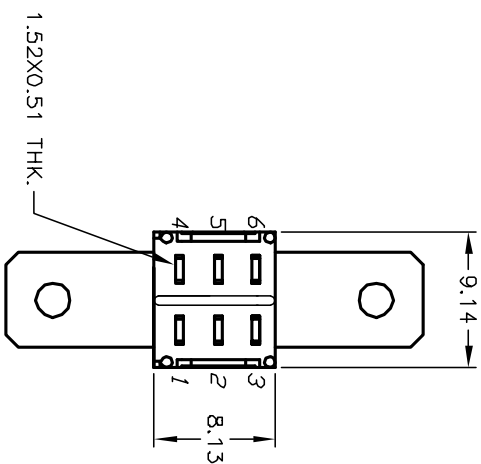
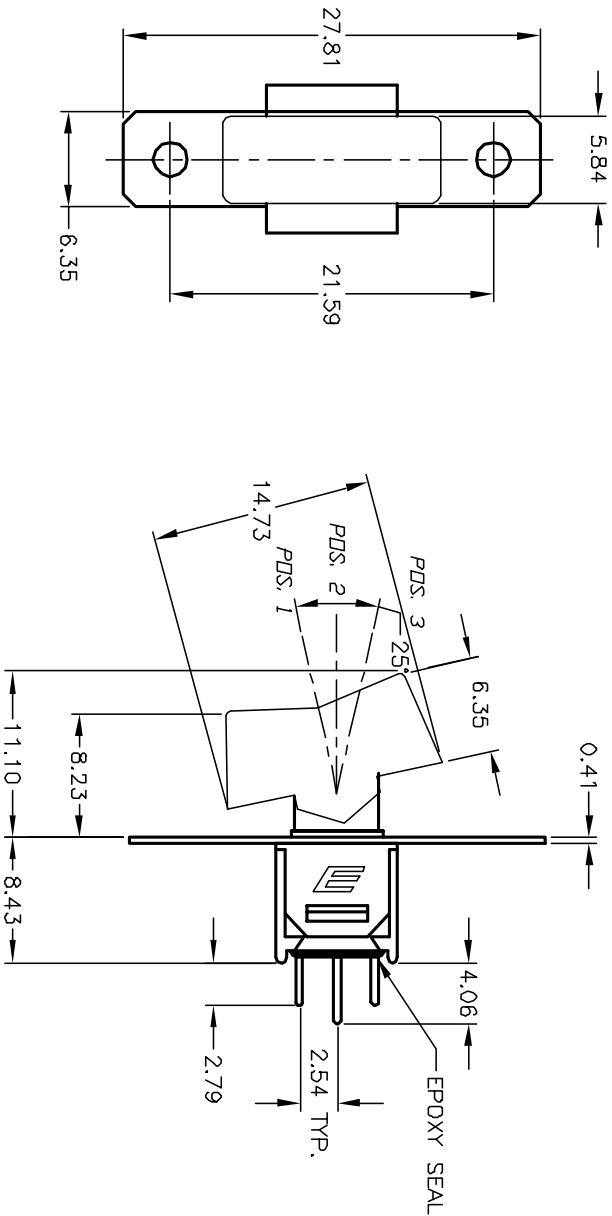

NOTES:

1. ALL DIMENSIONS IN MM
2. GENERAL TOLERANCE: X.X=±0.4
X.XX=±0.25
3. TERM. NOS. FDR REFERENCE ONLY.
4. RATING: 3 Amps @120 VAC or 28 VDC; 1 Amp @250 VAC.

REV. A		RELEASED FOR PRODUCTION		TITLE	
ECN No.		DESCRIPTION		400MDP3R6WHTM1QE	
A		3/28/03		E-SWITCH®	
REV.		DATE		DR	
12972		3/28/03		AR	
A		AR		DVG	
A		T427001		REV	
A		A		A	

SCALE 2:1 DATE 3/28/03 DR AR DVG T427001 REV A

THE INFORMATION CONTAINED IN THIS DOCUMENT IS PROPRIETARY TO E-SWITCH AND IS NOT TO BE COPIED OR TRANSMITTED