

Excellent Integrated System Limited

Stocking Distributor

Click to view price, real time Inventory, Delivery & Lifecycle Information:

[E-Switch](#)
[D16OAR12KGRNGRN](#)

For any questions, you can email us directly:

sales@integrated-circuit.com

SHEET 1 OF 1

PARTS LIST			
ITEM	QTY	PART NUMBER	DESCRIPTION
1	1	F040027	D16OAR12
2	1	F050422	50-004-22 24VDC GREEN LED
3	1	F050102	50-001-02 ROUND GREEN LENS

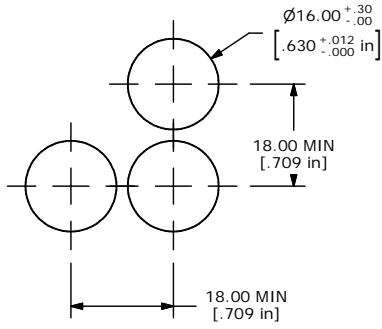

PANEL MOUNTING

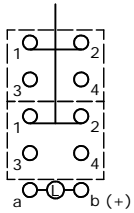

DPDT CONTACT CONFIGURATION

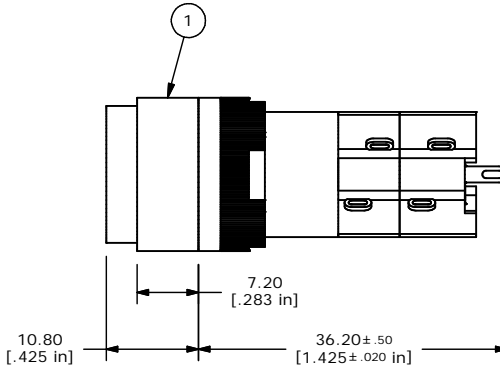
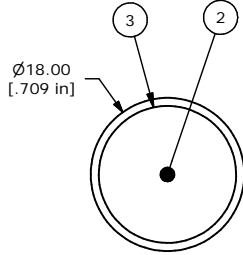
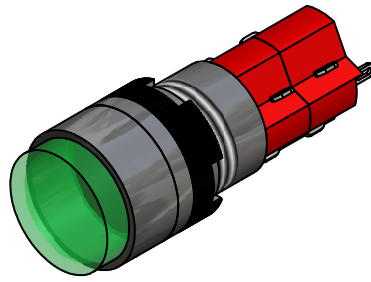

- NOTE:
1. ALL DIMENSIONS IN MM [INCH]
 2. GENERAL TOLERANCE: X.X=±0.4
X.XX=±0.25
 3. TERMINAL NUMBERS FOR REF ONLY
 4. MECHANICAL LIFE: 2,000,000 OPERATIONS
 5. INSULATION RESISTANCE: 1,000 MILLI-OHM MIN.
 6. OPERATING TEMP.: -25°C to 70°C
 - ▲ 7. LAMP VOLTAGE: 24VDC GREEN LED
 8. ▲ DENOTES CRITICAL PARAMETER.



A	14521	RELEASED FOR PRODUCTION	11/18/004	AR
REV	PCR NO	DESCRIPTION	DATE	BY

THE INFORMATION CONTAINED IN THIS DOCUMENT IS PROPRIETARY TO E-SWITCH AND IS NOT TO BE COPIED OR TRANSFERRED

TITLE D16OAR12KGRNGRN				
SCALE	DATE	DR	DWG	REV
2:1	11/18/04	AR	XF0614P	A