

Excellent Integrated System Limited

Stocking Distributor

Click to view price, real time Inventory, Delivery & Lifecycle Information:

[E-Switch](#)
[LASEEU14AWHT](#)

For any questions, you can email us directly:

sales@integrated-circuit.com

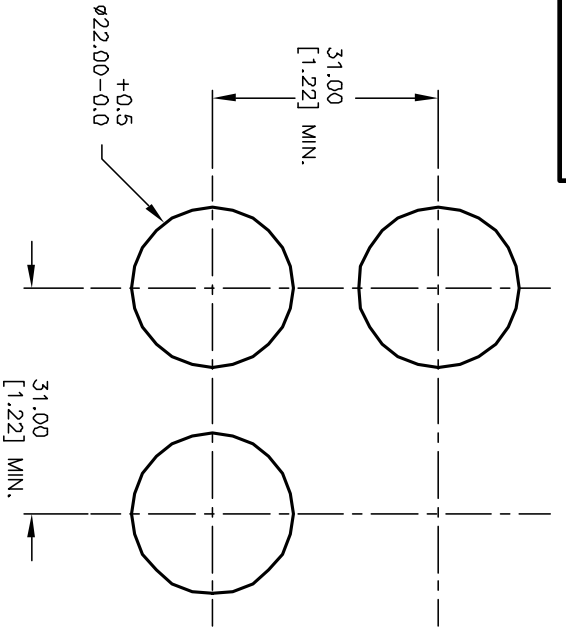

RECOMMENDED PANEL MOUNTING

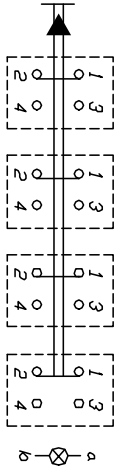

CONTACT CONFIGURATION

NOTES:

1. ALL DIMENSIONS IN MM [INCH]
2. GENERAL TOLERANCE: X.X=±0.4
X.XX=±0.25
3. RATINGS: 5A@250V AC,
8A@125V AC
4. CONTACT MATERIAL: COPPER ALLOY W/Gold Plating
5. MECHANICAL LIFE: >100,000 Cycles
6. ELECTRICAL LIFE: >50,000 Cycles
7. INSULATION RESISTANCE: >1000 MILLI-OHMS
8. OPERATING TEMP: -20°C to 55°C
9. LAMP VOLTAGE: 6V AC/DC 200mA (Incandescent)

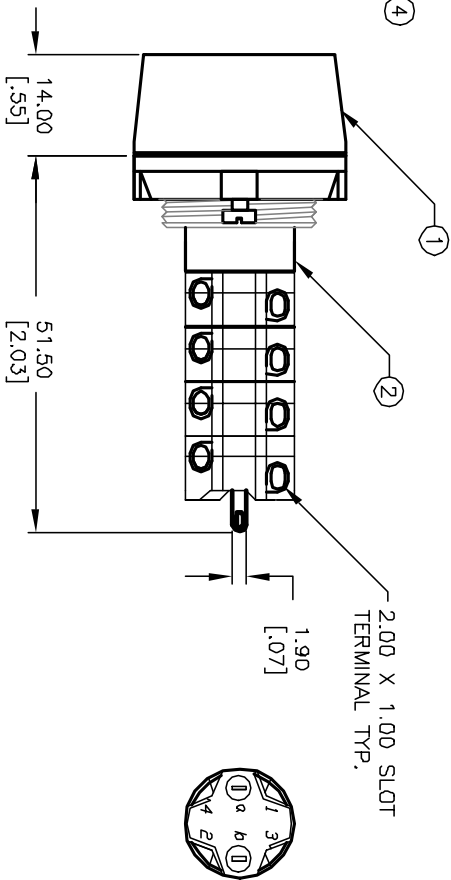
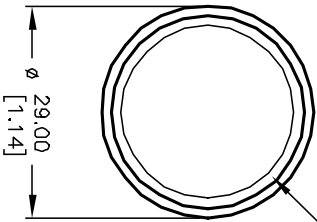

PARTS LIST		
Item	Qty.	Dwg. No. Part No.
1	1	F051701 29mm RING FOR LA SERIES
2	1	F060618 LASEEU14
3	1	F050402 50-004-02
4	1	F060293 29mm WHT LENS

REV.	ECN No.	DESCRIPTION	DATE	CHKD
A	11197	RELEASED FOR PRODUCTION	1/23/03	CJB

TITLE	SCALE	DATE	DR	DWG	REV
LASEEU14AWHT	1:1	--	--	XF0481P	A



THE INFORMATION CONTAINED IN THIS DOCUMENT IS PROPRIETARY TO E-SWITCH AND IS NOT TO BE COPIED OR TRANSMITTED