

Excellent Integrated System Limited

Stocking Distributor

Click to view price, real time Inventory, Delivery & Lifecycle Information:

[E-Switch](#)
[P16OAS110YEL](#)

For any questions, you can email us directly:

sales@integrated-circuit.com

SHEET OF

| PARTS LIST | | | |
|------------|------|----------|----------------------|
| ITEM | QTY. | PART NO. | PART DESCRIPTION |
| 1 | 1 | F040010 | P16 OA S11 |
| 2 | 1 | F052316 | 50-003-16 (YEL LENS) |

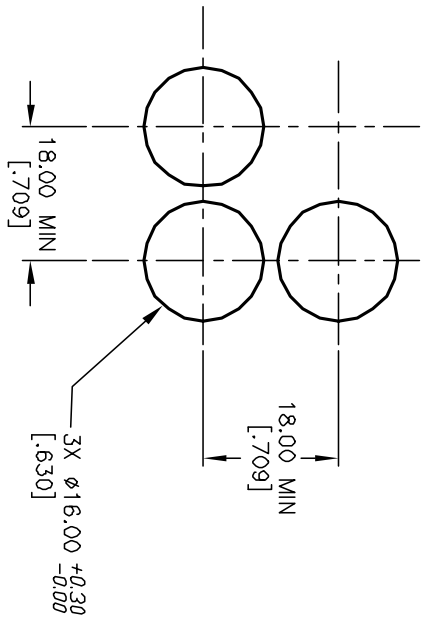

RECOMMENDED
 PANEL MOUNTING

1.0 ±0.2
 3.0 ±0.4
 a-L-b (+)

SPST
 CONTACT CONFIGURATION

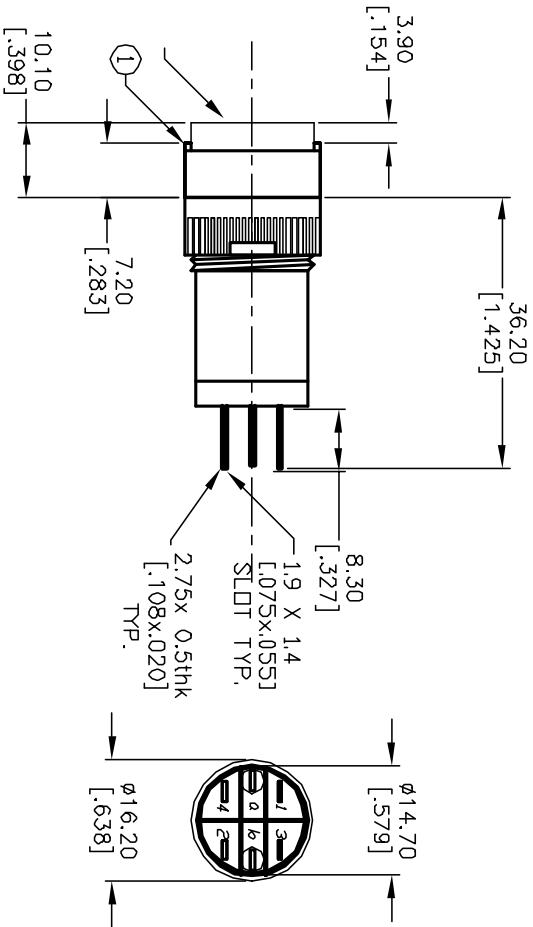
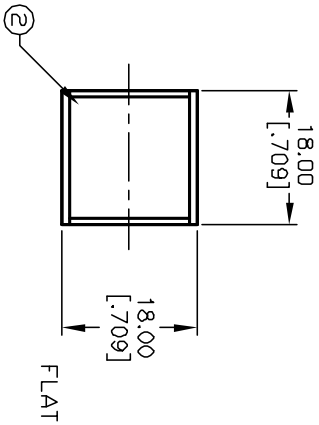

NOTES:

1. ALL DIMENSIONS IN MM [INCH]
2. GENERAL TOLERANCE: X.XX=±0.4
X.XX=±0.25
3. TERM. NOS. FOR REFERENCE ONLY.
4. RATING: 5A@250V AC / 8A@125V AC
5. MECHANICAL LIFETIME: >2 MILLION OPERATIONS
6. TRAVEL: 3.0MM
7. CONTACT MATERIAL: COPPER ALLOY W/SILVER PLATING

| REV. | ECN No. | RELEASED FOR PRODUCTION DESCRIPTION | DATE | CHKD |
|------|---------|-------------------------------------|---------|------|
| A | 12440 | RELEASED FOR PRODUCTION | 9/20/02 | CJC |

| TITLE | SCALE | DATE | DR | DWG | REV |
|------------------|-------|---------|----|---------|-----|
| P16 OA S11 0 YEL | 1.5:1 | 9/20/02 | CB | XF0509P | A |

E-SWITCH®

THE INFORMATION CONTAINED IN THIS DOCUMENT IS PROPRIETARY TO E-SWITCH AND IS NOT TO BE COPIED OR TRANSMITTED