

## Excellent Integrated System Limited

Stocking Distributor

Click to view price, real time Inventory, Delivery & Lifecycle Information:

[E-Switch](#)  
[R1966FBLKBLKFP](#)

For any questions, you can email us directly:

[sales@integrated-circuit.com](mailto:sales@integrated-circuit.com)

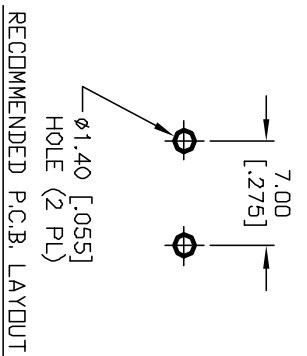
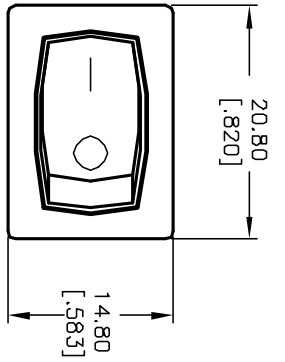

PANEL THICKNESS	X dimension
0.75-1.25 [0.30-0.49]	19.2-0.1 [0.756]
1.25-2.0 [0.49-0.79]	19.4-0.1 [0.764]
2.0-3.0 [0.79-1.18]	19.8-0.1 [0.780]

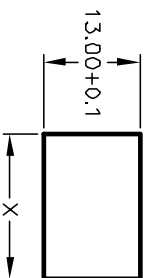

POS. 1

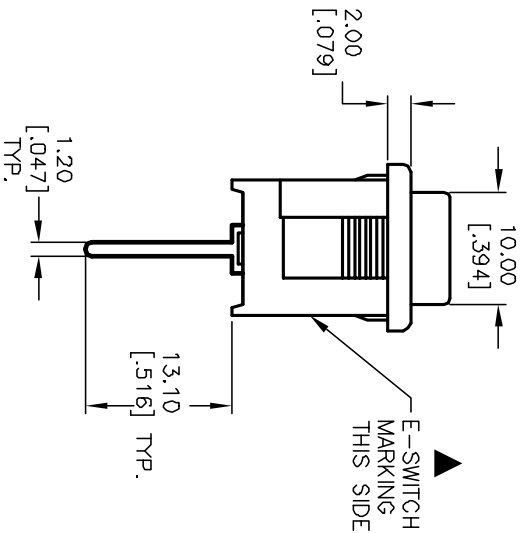
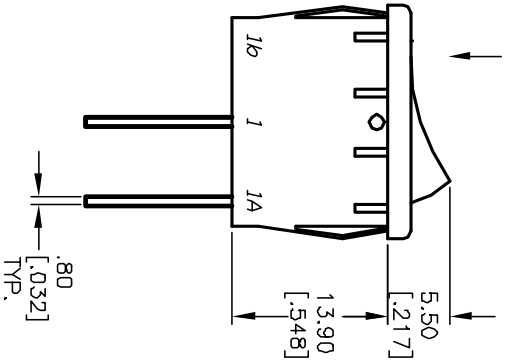

SWITCH FUNCTION	POS. 1	POS. 2
<ON>	ON	OFF
1-1a	OPEN	

( ) =Momentary

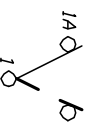

CIRCUIT: SPST

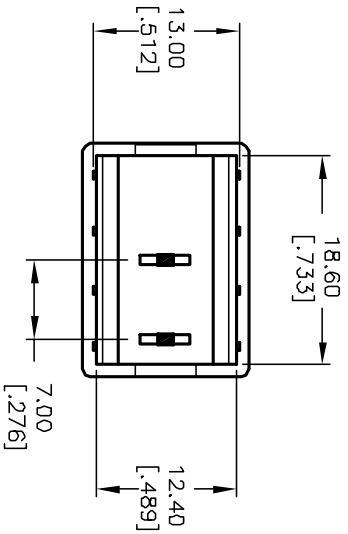

REV.	ECN No.	DESCRIPTION	DATE	CHKD
A	12252	RELEASED FOR PRODUCTION	6/19/02	CJB

THE INFORMATION CONTAINED IN THIS DOCUMENT IS PROPRIETARY TO E-SWITCH AND IS NOT TO BE COPIED OR TRANSMITTED

TITLE	SCALE	DATE	DR	DWG	REV
R1966F BLK BLK FP	1.5:1	6/19/02	CB	M304211	A

**E-SWITCH®**

- NOTES:
1. ALL DIMENSIONS IN MM [INCH]
  2. GENERAL TOLERANCE: X.X=±0.4  
X.XX=±0.25
  3. TERMINAL NUMBERS FOR REF ONLY
  4. RATING: 15A @ 125VAC OR  
6A @ 250VAC
  5. MATERIALS: TERMINALS: Silver Plated Copper Alloy  
CONTACTS: Coin Silver, Silver Plated
  6. ELECTRICAL LIFE: 10,000 cycles
  7. CONTACT RESISTANCE: <20 Mega Ω
  8. INSULATION RESISTANCE: >1000 Mega Ω
  9. DIELECTRIC STRENGTH: >1500 V 1 minute  
>3000 V between poles