

Excellent Integrated System Limited

Stocking Distributor

Click to view price, real time Inventory, Delivery & Lifecycle Information:

[E-Switch](#)
[TL1100F160Q4JWHT](#)

For any questions, you can email us directly:

sales@integrated-circuit.com

SHEET OF

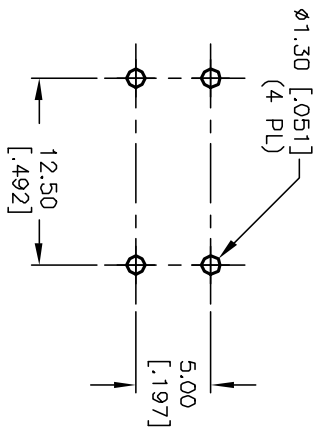

RECOMMENDED P.C.B. LAYOUT

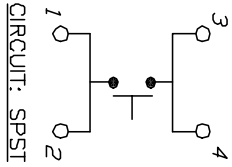
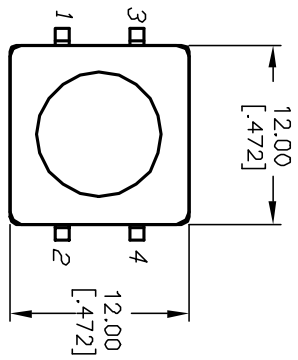

NOTES:

1. ALL DIMENSIONS IN MM [INCH]
2. GENERAL TOLERANCE: X.X=±0.4
X.XX=±0.25
3. TERM. NOS. FOR REF. ONLY
4. RATING: 50mA, @12V DC
5. TRAVEL: 0.30±0.15mm
6. OPERATING FORCE: 160±50gf
7. CONTACT RESISTANCE: 100 MILLIOHMS Max.
8. ELECTRICAL LIFE: 100,000 CYCLES MIN.

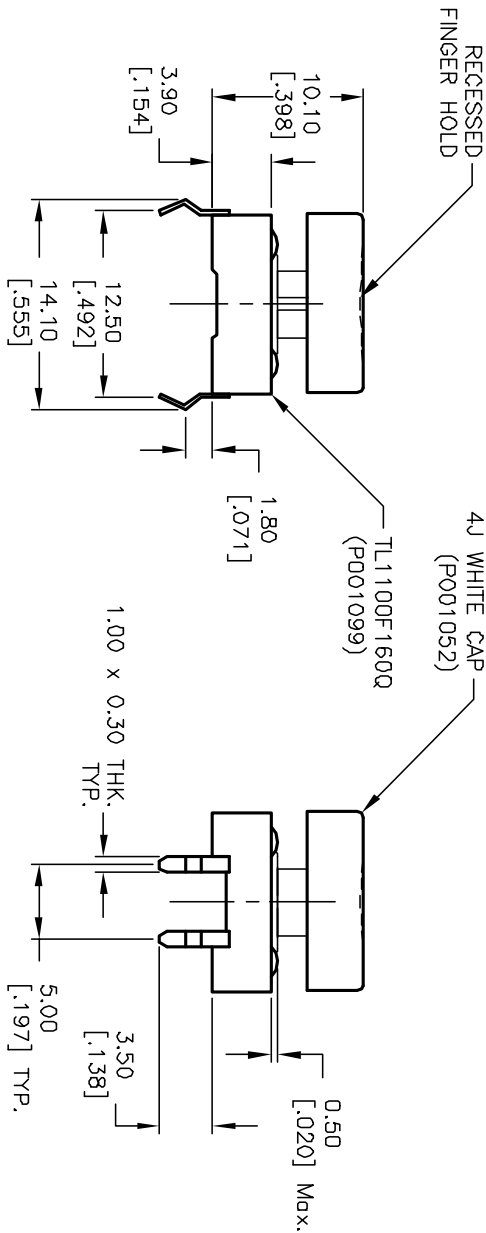

REV.	ECN No.	DESCRIPTION	DATE	CHKD
A	11263	RELEASED FOR PRODUCTION	2/22/01	CJB

TITLE	SCALE	DATE	DR	DWG	REV
TL 1100 F160 Q (4J WHT)	2:1	2/22/01	CJB	XP0144A	A

E-SWITCH®

THE INFORMATION CONTAINED IN THIS DOCUMENT IS PROPRIETARY TO E-SWITCH AND IS NOT TO BE COPIED OR TRANSMITTED