

Excellent Integrated System Limited

Stocking Distributor

Click to view price, real time Inventory, Delivery & Lifecycle Information:

[TE Connectivity AMP Connectors
3-640992-1](#)

For any questions, you can email us directly:

sales@integrated-circuit.com

THIS DRAWING IS UNPUBLISHED.

RELEASED FOR PUBLICATION

LOC DIST

REVISIONS

© COPYRIGHT BY TYCO ELECTRONICS CORPORATION. ALL RIGHTS RESERVED.

CM 00

P	LTR	DESCRIPTION	DATE	DWN	APVD
D		EC 0G3B 0202 05	30JUL05	BSV	DB

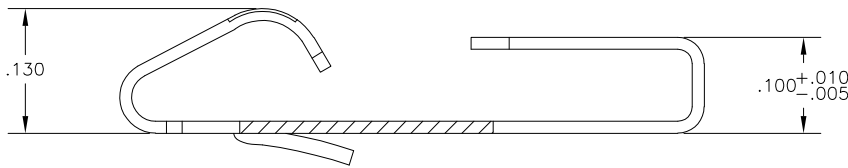
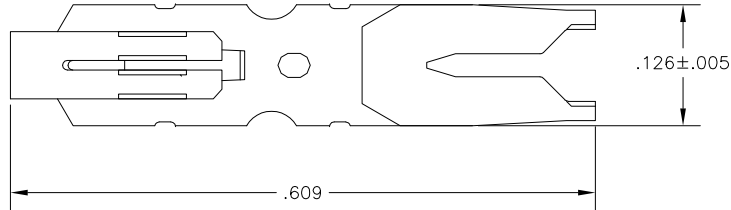

IN	MM
—	—
—	—
—	—
.609	15.47
.130	3.30
.126	3.20
.100	2.54
.012	0.30
.010	0.25
.005	0.13
IN	MM



3-640992-1
PART NUMBER

THIS DRAWING IS A CONTROLLED DOCUMENT.		DMN J. HUFFMAN 18APR96	Tyco Electronics Corporation Harrisburg, Pa 17105-3608	
DIMENSIONS: INCHES		CHK R. SWING 18APR96	Tyco Electronics Corporation	
TOLERANCES UNLESS OTHERWISE SPECIFIED:		APVD D. CLARK 22APR96	NAME CONTACT, LOOSE PIECE, #20AWG, EDGE CONNECTOR, MTA-156	
<ul style="list-style-type: none"> 0 PLC ± - 1 PLC ± - 2 PLC ± - 3 PLC ± - 4 PLC ± - ANGLES ± 0°30' 		APPLICATION SPEC	RESTRICTED TO	
MATERIAL .012 THK COPPER ALLOY		FINISH TIN PLATED	SIZE A3	CAGE CODE 00779
		DRAWING NO C=640992	SCALE 10:1	
		CUSTOMER DRAWING	SHEET 1 OF 1 REV D	