



Excellent Integrated System Limited

Stocking Distributor

Click to view price, real time Inventory, Delivery & Lifecycle Information:

[TE Connectivity AMP Connectors](#)
[3-641153-2](#)

For any questions, you can email us directly:

sales@integrated-circuit.com

1

2

3

4

LOC	DIST	REV	DATE	REV	DATE
CM	O	L	ECC-07-012878	20JUN07	KW DB
REVISIONS					
DESCRIPTION					

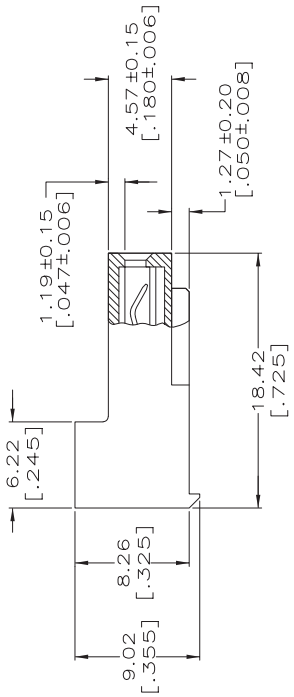
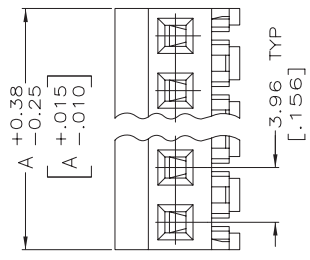
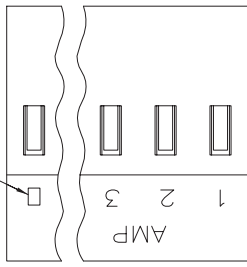

95.10	[3.744]	24	5-641153-4
91.14	[3.588]	23	5-641153-3
87.17	[3.432]	22	5-641153-2
83.21	[3.276]	21	5-641153-1
79.25	[3.120]	20	5-641153-0
75.29	[2.964]	19	4-641153-9
71.32	[2.808]	18	4-641153-8
67.36	[2.652]	17	4-641153-7
63.40	[2.496]	16	4-641153-6
59.44	[2.340]	15	4-641153-5
55.47	[2.184]	14	4-641153-4
51.51	[2.028]	13	4-641153-3
47.55	[1.872]	12	4-641153-2
43.59	[1.716]	11	4-641153-1
39.62	[1.560]	10	4-641153-0
35.66	[1.404]	9	3-641153-9
31.70	[1.248]	8	3-641153-8
27.74	[1.092]	7	3-641153-7
23.77	[.936]	6	3-641153-6
19.81	[.780]	5	3-641153-5
15.85	[.624]	4	3-641153-4
11.89	[.468]	3	3-641153-3
7.92	[.312]	2	3-641153-2
95.10	[3.744]	24	2-641153-4
91.14	[3.588]	23	2-641153-3
87.17	[3.432]	22	2-641153-2
83.21	[3.276]	21	2-641153-1
79.25	[3.120]	20	2-641153-0
75.29	[2.964]	19	1-641153-9
71.32	[2.808]	18	1-641153-8
67.36	[2.652]	17	1-641153-7
63.40	[2.496]	16	1-641153-6
59.44	[2.340]	15	1-641153-5
55.47	[2.184]	14	1-641153-4
51.51	[2.028]	13	1-641153-3
47.55	[1.872]	12	1-641153-2
43.59	[1.716]	11	1-641153-1
39.62	[1.560]	10	1-641153-0
35.66	[1.404]	9	641153-9
31.70	[1.248]	8	641153-8
27.74	[1.092]	7	641153-7
23.77	[.936]	6	641153-6
19.81	[.780]	5	641153-5
15.85	[.624]	4	641153-4
11.89	[.468]	3	641153-3
7.92	[.312]	2	641153-2

CONTRACT FINISH	DIM A	NO. OF CIRCUITS	PART NO.
TIN			
TIN-LEAD			

THIS DRAWING IS A CONTROLLED DOCUMENT. DATE: 2-12-91

DESIGNED BY: LEWIS

CHECKED BY: SWING

PRODUCT SPEC: 108-1051

APPLICATION SPEC: 114-1020

WEIGHT: -

CUSTOMER DRAWING

SCALE: 4:1

SHEET: 1 of 1

RESTRICTED TO: -

NAME: MTA-156 CONNECTOR ASSEMBLY, 18 AWG, STANDARD

SIZE: CODE DRAWING NO: A2/00779C=641153

DATE: -

REV: -

REV: -

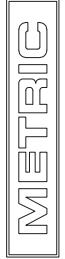

- CONNECTOR - NYLON UL94V-2 (ORANGE). CONTACTS - 0.30[.012] THICK COPPER ALLOY. PLATING - 0.00038[.000015] GOLD IN CONTACT AREA. 0.00203[.000080] MIN THICKNESS BRIGHT TIN LEAD IN SLOT AREA FOR 641153-2 THRU 2-641153-4 OR MATTE WHISKER MITIGATED TIN IN SLOT AREA FOR 3-641153-2 THRU 5-641153-4 OVER NICKEL UNDERPLATE.
- CONTACTS ACCEPT 18 AWG WIRE WITH 2.41[.095] MAX INSULATION DIAMETER.
- CONTACTS MUST ACCEPT 1.14±0.03[.045±.001] SQUARE POST AND REMAIN LOCKED IN POSITION.
- IDENTIFICATION NUMBER FOR LAST CIRCUIT MAY NOT APPEAR ON ALL ASSEMBLIES.
- DIMENSIONS IN BRACKETS ARE IN INCHES.
- HOUSING FEATURES ARE: CLOSED END WITHOUT LOCKING RAMP.