

## Excellent Integrated System Limited

Stocking Distributor

Click to view price, real time Inventory, Delivery & Lifecycle Information:

[Eaton \(formerly Cooper Bussmann\)](#)  
[AMI-40](#)

For any questions, you can email us directly:

[sales@integrated-circuit.com](mailto:sales@integrated-circuit.com)

## AMI SERIES

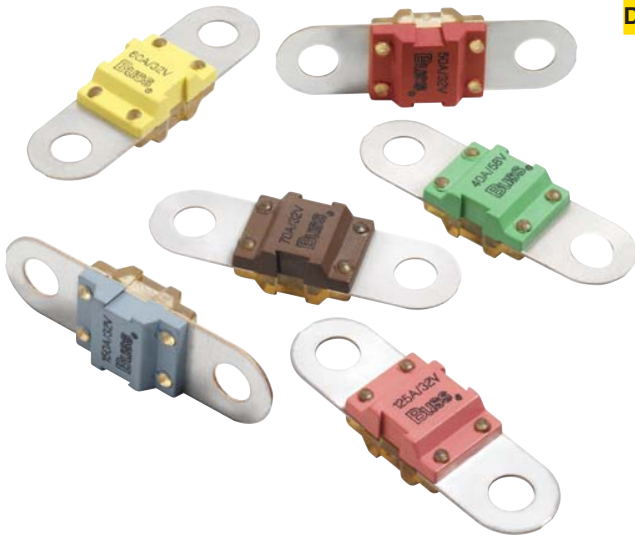

### DIMENSIONS (Dims. shown are for reference only. Consult factory for latest prints)

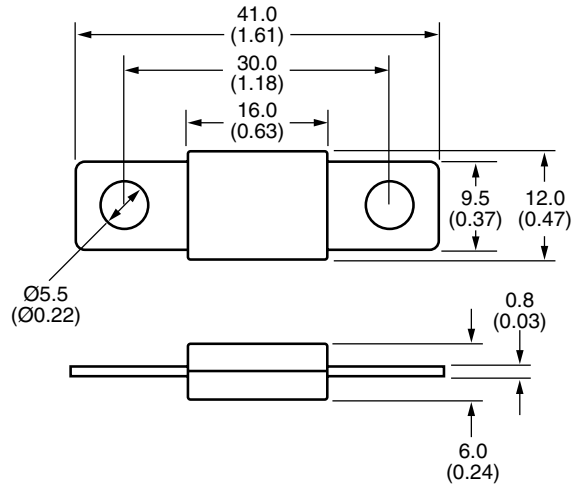

### BOLT IN AUTOMOTIVE FUSES

#### SPECIFICATIONS:

**Applications:** Power distribution protection for automotive systems. Consult factory for available fuse-holders.

**Current Rating:** 30-150A.

**Voltage Rating:** 32VDC.\*

**Interrupt Rating:** 2000A @ 32VDC.

**Housing Material:** UL-Rated 94V-0 thermoplastic.

**Terminal Material:** Tin-plated brass.

**Mounting:** Max torque of 35in-lb (4Nm).

**Marking:** Color-coded housings for each amperage.

\*Consult factory for higher voltage fuses.

#### TIME-CURRENT SPECIFICATIONS

% of Rating	Opening Time	
	Minimum	Maximum
100	100 hrs	
110	4 hrs	
150	90 s	3600 s
200	5 s	100 s
300	0.3 s	10 s
500	0.1 s	1 s

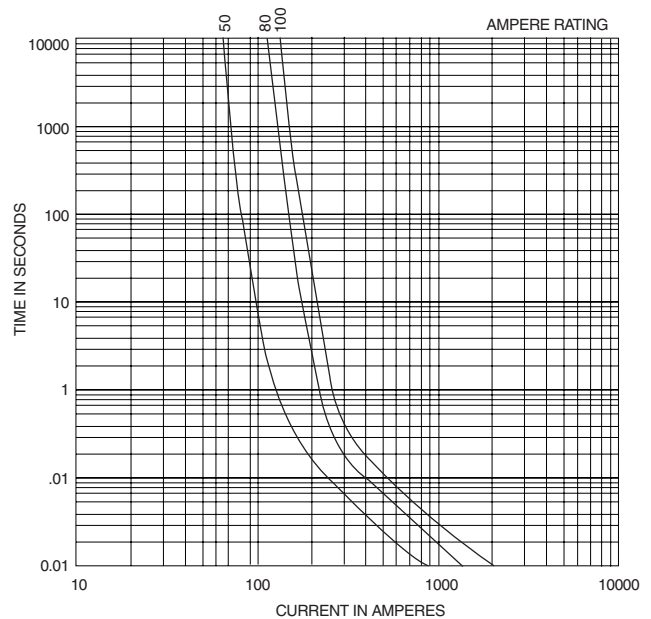

#### PART NUMBERING SYSTEM

##### Series

**B** **K** **/** **A** **M** **I** — **□** **□** **□**

##### Rating

- 030 – 30 amps (orange)
- 040 – 40 amps (lt. green)
- 050 – 50 amps (red)
- 060 – 60 amps (yellow)
- 070 – 70 amps (brown)
- 080 – 80 amps (white)
- 100 – 100 amps (blue)
- 125 – 125 amps (pink)
- 150 – 150 amps (gray)