



Excellent Integrated System Limited

Stocking Distributor

Click to view price, real time Inventory, Delivery & Lifecycle Information:

[TE Connectivity AMP Connectors](#)
[1-1478190-0](#)

For any questions, you can email us directly:

sales@integrated-circuit.com

THIS DRAWING IS UNPUBLISHED. RELEASED FOR PUBLICATION AUGUST, 2006.
 © COPYRIGHT 2006 BY TYCO ELECTRONICS CORPORATION. ALL RIGHTS RESERVED.

LOC		DIST		REVISIONS			
P	LTR	DESCRIPTION	DATE	DWN	APVD		
B		ECR-06-017552	02AUG06	JMS	FWK		

- NOTES:**
- 1. PACK IN ACCORDANCE WITH AMP SPEC 107-3275
 - 2. 100 TRAY PACK IN ACCORDANCE WITH AMP SPEC 107-3275
 - 3. Ag PLATING
 - 4. THIS ITEM MUST BE WHITE

5 ELECTRICAL CHARACTERISTICS

FREQUENCY RANGE:	DC - 11 GHz
NOMINAL IMPEDANCE:	50 Ohm
INSULATION RESISTANCE:	5000 MOhm
WORKING VOLTAGE:	1000 Volts RMS at Sea Level
DIELECTRIC WITHSTAND VOLTAGE:	2500 Volts RMS Max
CONTACT RESISTANCE:	1.00 mOhm Max
CENTRE CONTACT:	1.00 mOhm Max
OUTER CONTACT:	1.30:1 Max
VSWR @ 4GHz:	1.30:1 Max
INSERTION LOSS dB @ x 4 GHz:	0.30 Max

6 MECHANICAL CHARACTERISTICS

COUPLING NUT RETENTION FORCE:	N/A
CABLE RETENTION FORCE:	170N Min
CLAMP NUT RECOMMENDED TORQUE:	4N
DURABILITY:	500 Cycles Min

7 ENVIRONMENTAL CHARACTERISTICS

OPERATING TEMPERATURE:	-65 to +165 DegC
------------------------	------------------

8. FOR TECHNICAL DATA REFER TO YOUR LOCAL TYCO ELECTRONICS SALES OFFICE.
 9. ALL DIMENSIONS ARE NOMINAL FOR REFERENCE ONLY UNLESS OTHERWISE STATED.

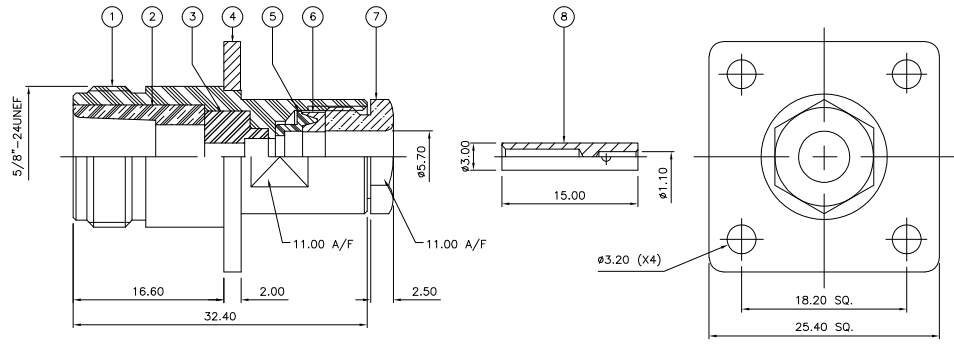

QTY	DESCRIPTION	ITEM
1	BRASS CONTACT	8
1	BRASS CLAMP NUT	7
1	SILICONE RUBBER GASKET	6
1	BRASS SLEEVE	5
1	BRASS FLANGE	4
1	PTFE INSULATION	3
1	BRASS CHASSIS	2
1	BRASS BODY	1
6-0	1-0	MATERIAL DESCRIPTION ITEM

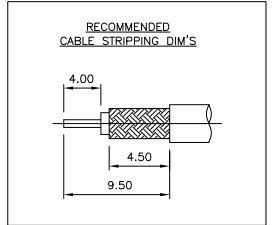

THIS DRAWING IS A CONTROLLED DOCUMENT.		DWN: J.SANDWELL 02AUG06	Tyco Electronics Corporation	
DIMENSIONS: mm		CHK: S.PARLOW 02AUG06	Bideford EX39 4HE	
TOLERANCES UNLESS OTHERWISE SPECIFIED:		APVD: F.WHEELER-KING 02AUG06	NAME: TYPE 'N' PANEL JACK SOLDER 50 OHM	
0 PLC ± .05		PRODUCT SPEC	RG55B/U, 142B/U, 223/U, 400/U, URM301, KX23	
1 PLC ± .05		APPLICATION SPEC	-	
2 PLC ± .05		411-3254	SIZE: A3	CAGE CODE: 00779
3 PLC ± .05		4	DRAWING NO: 1478190	RESTRICTED TO: -
4 PKG ANGLES ± .05		FINISH: -	SCALE: NTS	SHEET: 1 OF 1
MATERIAL: SEE TABLE		WEIGHT: -	CUSTOMER DRAWING	REV: B