

## Excellent Integrated System Limited

Stocking Distributor

Click to view price, real time Inventory, Delivery & Lifecycle Information:

[CUI Inc.](#)

[CUI-102E-10](#)

For any questions, you can email us directly:

[sales@integrated-circuit.com](mailto:sales@integrated-circuit.com)

REV.	DESCRIPTION	DATE
A	NEW DRAWING	5/29/2008

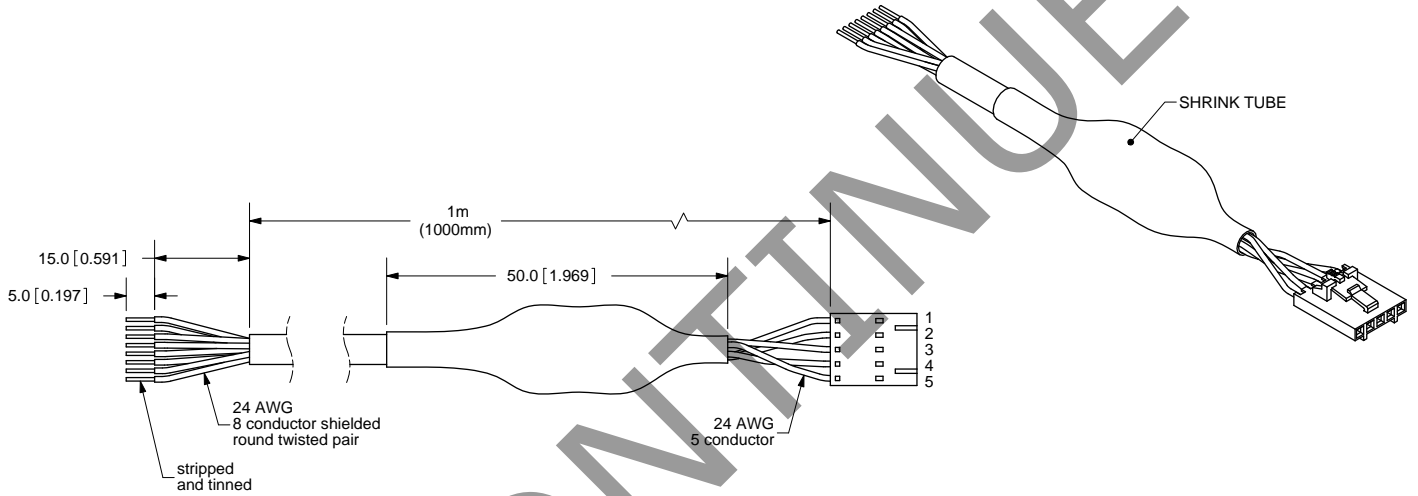

TOLERANCE:  
±0.3mm UNLESS OTHERWISE  
SPECIFIED

NOTE:  
OPERATING TEMPERATURE  
-40 ~ 85°C  
CHIP P/N: ST26C31B

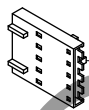

- ① HOUSING  
VENDOR: MOLEX  
PART NO: 50-57-9405  
DESCRIPTION: .1" PITCH CRIMP HOUSING  
QTY: 1
- ② TERMINAL  
VENDOR: MOLEX  
PART NO: 16-02-0086  
DESCRIPTION: .1" PITCH CRIMP TERMINAL  
QTY: 5



**CUI INC**

20050 SW 112th Ave.  
Tualatin, OR 97062  
Phone: 503-612-2300  
800-275-4899  
Fax: 503-612-2383  
Website: [www.cui.com](http://www.cui.com)

CABLE COLOR	BROWN	WHITE blue	BLUE	WHITE orange	ORANGE	WHITE brown	WHITE green	GREEN
OUTPUT TYPE	GND	X	X	A	A	5V	B	B
CABLE COLOR	BROWN (1)	PURPLE (2)	BLUE (3)	ORANGE (4)	YELLOW (5)	-	-	-
OUTPUT TYPE	GND	X	A	5V	B			

TITLE:	AMT102 LINE DRIVER CABLE	REV:	A
PART NO.	CUI-102E-10	UNITS:	MM [INCHES]
DRAWN BY:	ZRJ	APPROVED BY:	
		SCALE:	1:1

PC FILE NAME:  
CUI-102E-10

COPYRIGHT  
2008 BY CUI INC.