

Excellent Integrated System Limited

Stocking Distributor

Click to view price, real time Inventory, Delivery & Lifecycle Information:

[Molex Connector Corporation](#)
[5016164585](#)

For any questions, you can email us directly:

sales@integrated-circuit.com

10 9 8 7 6 5 4 3 2 1

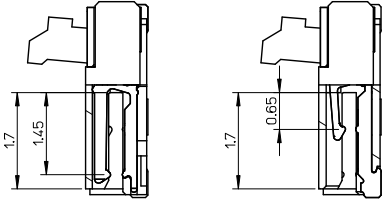
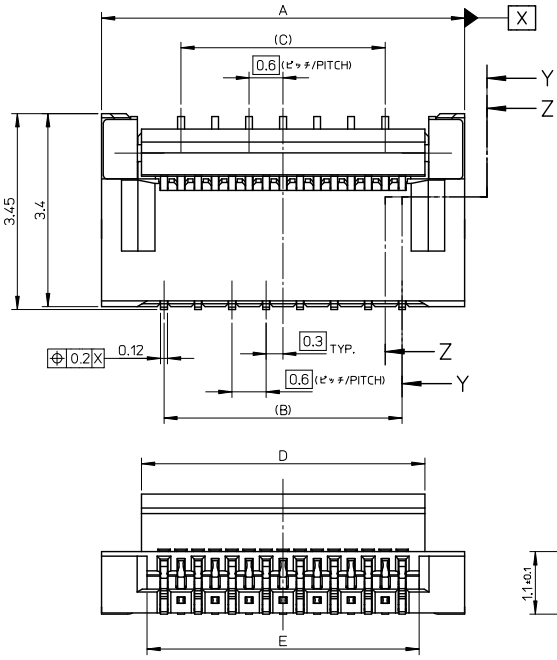

SECTION Z-Z SECTION Y-Y

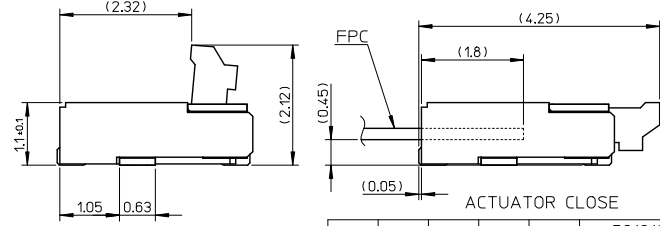

ACTUATOR CLOSE

15.6	15.8	14.4	15.0	17.2	501616-5185	501616-5150	51
13.8	14.0	12.6	13.2	15.4	501616-4585	501616-4550	45
12.6	12.8	11.4	12.0	14.2	501616-4185	501616-4150	41
12.0	12.2	10.8	11.4	13.6	501616-3985	501616-3950	39
10.8	11.0	9.6	10.2	12.4	501616-3585	501616-3550	35
E	D	(C)	(B)	A	EMBOSSED TAPE		MATERIAL NO. CIRCUIT
ORDER No.							

- 部品構成**
- ハウジング・・・材質：耐熱性樹脂 黒色 UL94V-0
HOUSING MATERIAL:HEAT RESISTANT POLYMER BLACK UL94-V0
 - 奇数ターミナル・・・材質：銅合金
ODD TERMINAL MATERIAL :COPPER ALLOY
処理：ニッケル下地部分金メッキ（接触部及びテール部）
FINISH :PARTLY GOLD(CONTACT,TAIL) OVER NICKEL PLATING
 - 偶数ターミナル・・・材質：銅合金
EVEN TERMINAL MATERIAL:COPPER ALLOY
処理：ニッケル下地部分金メッキ（接触部及びテール部）
FINISH :PARTLY GOLD(CONTACT,TAIL) OVER NICKEL PLATING
 - アクチュエータ・・・材質：耐熱性樹脂 灰色 UL94V-0
ACTUATOR MATERIAL :HEAT RESISTANT POLYMER GRAY UL94-V0
 - ネイル・・・材質：銅合金
NAIL MATERIAL:COPPER ALLOY
処理：ニッケル下地部分金メッキ
FINISH :TIN OVER NICKEL PLATING

REVISED EC NO: J2015-1263 DRAWN: TAKAHASHI 04/2015/03/17 CHKD: TAKAHASHI 2015/03/17 APPR: INOUE 2015/03/30	GENERAL TOLERANCES (UNLESS SPECIFIED)		DIMENSION STYLE		SCALE	DESIGN UNITS	THIRD ANGLE PROJECTION
	0.25 UNDER	±0.03	MM ONLY		15:1	METRIC	
	0.25 OVER 0.5 UNDER	±0.05	DRAWN BY DATE		TITLE		
	0.5 OVER 1.0 UNDER	±0.1	K. SATO 2007/01/26		0.3 FPC CONN. E/O H=1.1 HSG ASSY LONG ACTUATOR		
	1.0 OVER 10 UNDER	±0.2	CHECKED BY DATE		ORDER No.		
10 OVER 30 UNDER	±0.25	H. HIRATA 2007/01/26		MATERIAL NO.		SHEET NO. 1 OF 2	
30 OVER	±0.3	APPROVED BY DATE		DOCUMENT NO.			
ANGULAR	±3 °	M. SASAO 2007/01/26		SEE CHART		SD-501616-007	
DRAFT WHERE APPLICABLE MUST REMAIN WITHIN DIMENSIONS			THIS DRAWING CONTAINS INFORMATION THAT IS PROPRIETARY TO MOLEX INCORPORATED AND SHOULD NOT BE USED WITHOUT WRITTEN PERMISSION				

9 8 7 6 5 4 3 2 1

10 9 8 7 6 5 4 3 2 1

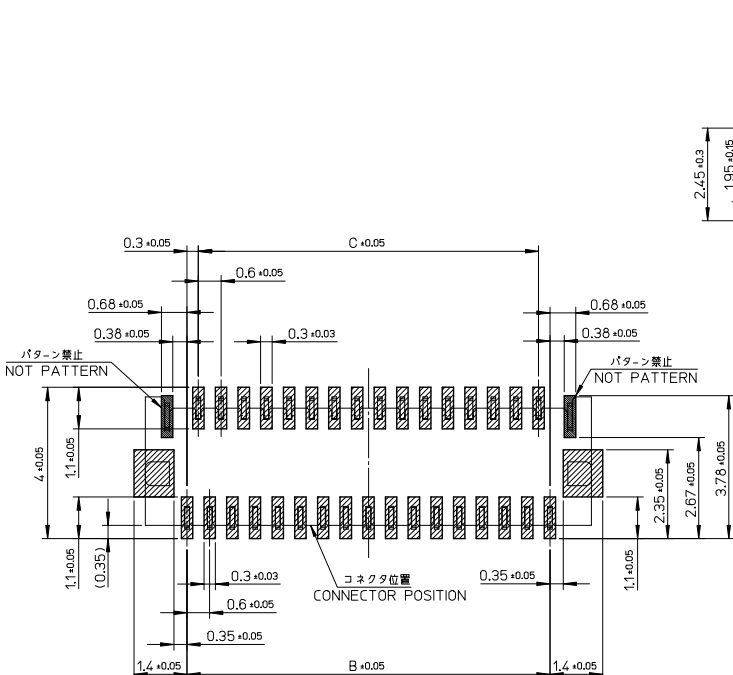

参考基板レイアウト(マウント面)
P.C. BOARD PATTERN DIM.(REF.)

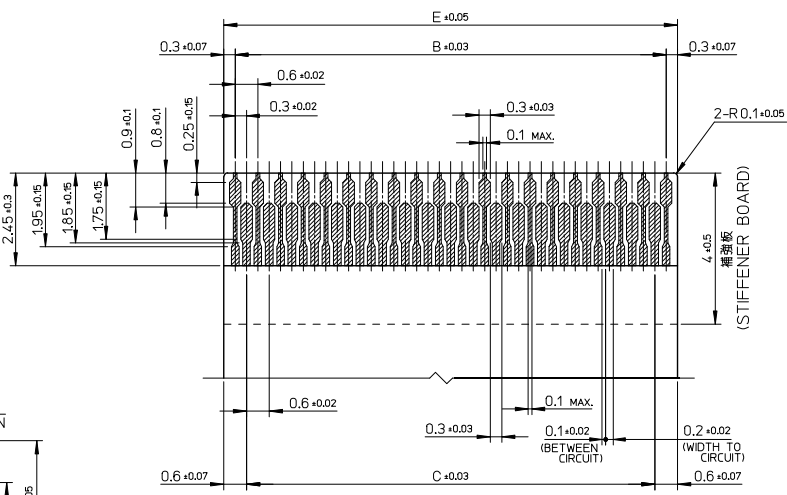

適合FPC推奨寸法
仕上がり厚さ : 0.2±0.03
APPLY FPC
RECOMMENDED DIM.
THICKNESS : 0.2±0.03

15.6	14.4	15.0	501616-5185	501616-5150	51
13.8	12.6	13.2	501616-4585	501616-4550	45
12.6	11.4	12.0	501616-4185	501616-4150	41
12.0	10.8	11.4	501616-3985	501616-3950	39
10.8	9.6	10.2	501616-3585	501616-3550	35

- 注記
- 基板実装前にアクチュエータを操作しないで下さい。
PLEASE DO NOT OPERATE THE ACTUATOR BEFORE MOUNTING.
必ず基板に実装し、FPCを挿入してからアクチュエータを操作して下さい。
PLEASE OPERATE THE ACTUATOR AFTER MOUNTING ON THE SUBSTRATE, AND MATING FPC.
 - ELV及びRoHS適合品
ELV AND RoHS COMPLIANT
 - 本製品は上面接触品です。下面接続で使用しないでください。
THIS CONNECTOR IS UPPER CONTACT TYPE.
PLEASE DO NOT USE AS LOWER CONTACT TYPE.

REVISED EC NO. J2015-1263 DRAWN TAKAHASHI 04/2015/03/27 CHKD TAKAHASHI 2015/03/27 APPR. YNOGAWA 2015/03/20	GENERAL TOLERANCES (UNLESS SPECIFIED)		DIMENSION STYLE		SCALE 10:1 DESIGN UNITS METRIC THIRD ANGLE PROJECTION
	0.25 UNDER	±0.03	MM ONLY	DRAWN BY DATE	
	0.25 OVER 0.5 UNDER	±0.05		K. SATO 2007/01/26	
	0.5 OVER 1.0 UNDER	±0.1		CHECKED BY DATE	
	1.0 OVER 10 UNDER	±0.2		H. HIRATA 2007/01/26	
			APPROVED BY DATE		TITLE 0.3 FPC CONN. E/O H=1.1 HSG ASSY LONG ACTUATOR
10 OVER 30 UNDER	±0.25		M. SASAO 2007/01/26		
30 OVER	±0.3		MATERIAL NO.		
ANGULAR ±3°			SEE CHART		
DRAFT WHERE APPLICABLE MUST REMAIN WITHIN DIMENSIONS			DOCUMENT NO. SD-501616-007		

9 8 7 6 5 4 3 2 1

10 9 8 7 6 5 4 3 2 1

NOTES

1. 製品 (501616-**50) の詳細寸法については、
図面 SD-501616-007 をご参照下さい。
IN THE PACKAGE, PART NO. 501616-**50 DETAILED DIMENSIONS,
REFER TO SALES DRAWING NO. SD-501616-007.

2. 梱包数量 : 3000個/リール
NUMBER OF CONNECTORS : 3000 PCS/REEL

3. リードテープ長さ
LEAD TAPE LENGTH

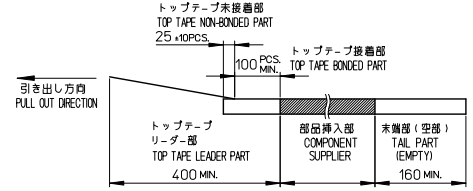

4. 材料
キャリアテープ: ポリスチレン (PS)
トップテープ : PET, PE, PEF
リール : ポリスチレン (PS) <リサイクル材を含む>

MATERIAL
CARRIER TAPE : POLYSTYRENE (PS)
TOP TAPE : PET, PE, PEF
REEL : POLYSTYRENE (PS) <RECYCLE MATERIAL CONTAINED>

5. ELV及びRoHS適合品
ELV AND RoHS COMPLIANT

37.4	33.4	32±0.3	28.4	14.2	15.4	17.4	501616-5185	51
					13.6	15.6	501616-4585	45
29.4	25.4	24±0.3	±	11.5	12.4	14.4	501616-4185	41
					11.8	13.8	501616-3985	39
					10.6	12.6	501616-3585	35

G F E キャリアテープ幅 EMBOSSED TAPE WIDTH D C B A

EMBOSSED PACKAGE 極数 ORDER No. CIRCUIT

SCALE --- DESIGN UNITS METRIC

THIRD ANGLE PROJECTION

0.3 FPC CONN. H=1.1 EMBSTP PKG (LONG-ACT)

MOLEX INCORPORATED

SD-501616-008 SHEET NO. 1 OF 1

THIS DRAWING CONTAINS INFORMATION THAT IS PROPRIETARY TO MOLEX INCORPORATED AND SHOULD NOT BE USED WITHOUT WRITTEN PERMISSION

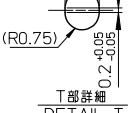
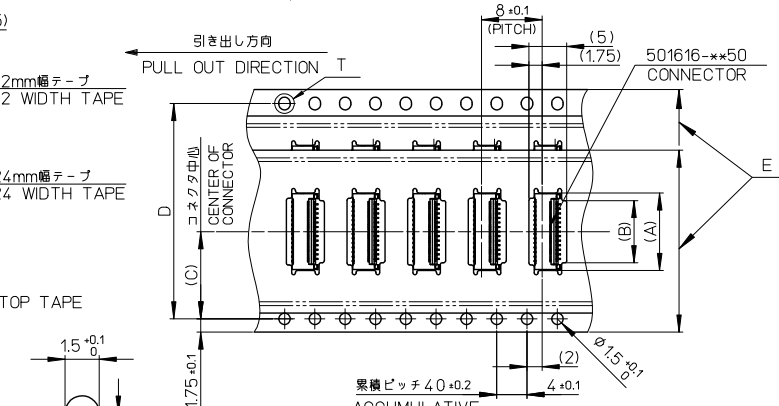
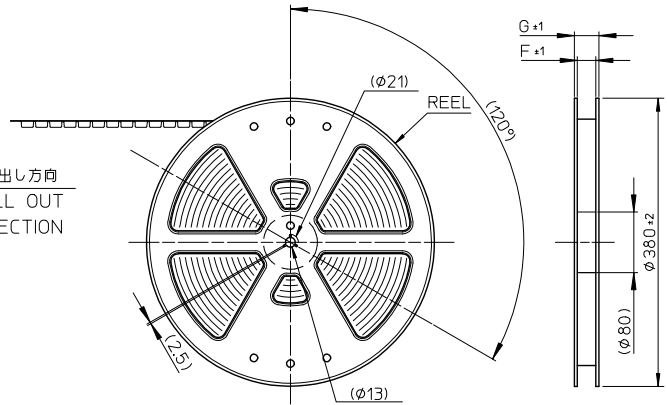

エンボステープ内の製品の向き
DIRECTION OF CONNECTOR IN EMBOSSED TAPE

REVISED
EC NO. J2009-1784
DRAWN BY: DRW/NKAWABATA 2009/01/26
CHECKED BY: CHK/DHSHIMOMIYAMA 2009/01/26
APPROVED BY: APPR/HSHIMOMIYAMA 2009/01/26

GENERAL TOLERANCES (UNLESS SPECIFIED)
10 UNDER ± ---
10 OVER 30 UNDER ± ---
30 OVER ± ---
ANGULAR ± --- °
DRAFT WHERE APPLICABLE MUST REMAIN WITHIN DIMENSIONS

DIMENSION STYLE MM ONLY
DRAWN BY: K. SATO DATE: 2007/05/14
CHECKED BY: H. HIRATA DATE: 2007/05/14
APPROVED BY: M. SASAO DATE: 2007/05/14
MATERIAL NO. SEE CHART

SCALE --- DESIGN UNITS METRIC
THIRD ANGLE PROJECTION
0.3 FPC CONN. H=1.1 EMBSTP PKG (LONG-ACT)
MOLEX INCORPORATED
SD-501616-008 SHEET NO. 1 OF 1
THIS DRAWING CONTAINS INFORMATION THAT IS PROPRIETARY TO MOLEX INCORPORATED AND SHOULD NOT BE USED WITHOUT WRITTEN PERMISSION