

Excellent Integrated System Limited

Stocking Distributor

Click to view price, real time Inventory, Delivery & Lifecycle Information:

[Amphenol RF](#)
[172313](#)

For any questions, you can email us directly:

sales@integrated-circuit.com

REV.	DATE	ECR NO.	DESCRIPTION
NC	04/29/04	XXXXXX	INITIAL RELEASE
A	08/31/12	2359	UPDATE DRAWING FORMAT, IMPROVE ELECTRICAL PERFORMANCE, MODIFY CRIMP TOOL

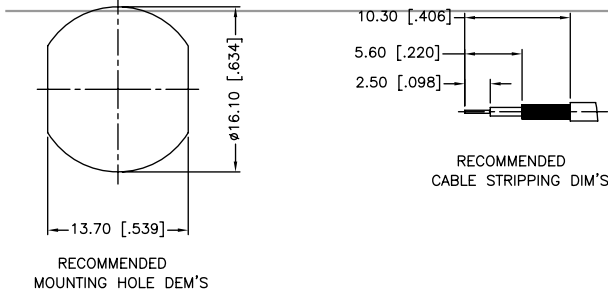

RECOMMENDED CABLE STRIPPING DIM'S

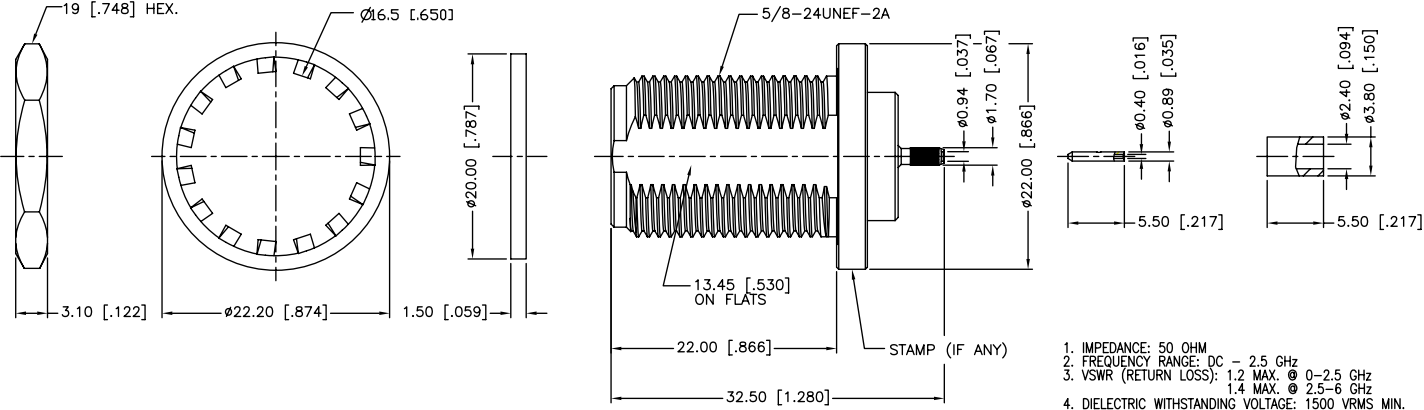
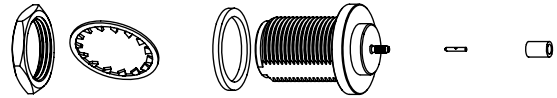

1. IMPEDANCE: 50 OHM
2. FREQUENCY RANGE: DC - 2.5 GHz
3. VSWR (RETURN LOSS): 1.2 MAX. @ 0-2.5 GHz
1.4 MAX. @ 2.5-6 GHz
4. DIELECTRIC WITHSTANDING VOLTAGE: 1500 VRMS MIN.
5. DURABILITY: 500 CYCLES MIN.
6. TEMPERATURE RANGE: -65°C TO +165°C
7. CRIMPED FERRULE
HEX. CRIMP SIZE 128"
8. CONTACT PIN CAN BE SOLDERED
OR USE 4-WAY INDENT TOOL #47025
9. MAX. PANEL THICKNESS=6.5mm

DESCRIPTION	MATERIAL	FINISH	QTY
9 FERRULE	COPPER	NEXCOTE	1
8 CONTACT PIN	BRASS	GOLD	1
7 HEX NUT	BRASS	NEXCOTE	1
6 LOCK WASHER	BRASS	NEXCOTE	1
5 GASKET	SILICON RUBBER	RED	1
4 BARREL	BRASS	NEXCOTE	1
3 CONTACT PIN	PHOSPHOR BRONZE	GOLD	1
2 INSULATOR	PTFE	NATURAL	1
1 BODY	BRASS	NEXCOTE	1

UNLESS OTHERWISE SPECIFIED DIMENSIONS ARE IN MILLIMETERS. DIMENSIONS IN [] ARE IN INCHES AND FOR CUSTOMER REFERENCE ONLY.

UNLESS OTHERWISE SPECIFIED TOLERANCES FOR MILLIMETERS ARE:
 0.5 - 8mm ± 0.20mm
 8 - 30mm ± 0.40mm
 30 - 120mm ± 0.50mm

UNLESS OTHERWISE SPECIFIED TOLERANCES FOR INCHES ARE:
 .020 - .315 = ± 0.007"
 .315 - 1.180 = ± 0.015"
 1.180 - 4.724 = ± 0.020"

DO NOT SCALE DRAWING

APPROVALS	DATE
DRAWN M.ZHANG	08/31/12
CHECKED	
ISSUED	
SHEET 1 OF 1	
CAD FILE C:/CONNEX/172313.DWG	

Amphenol Connex

PART DESCRIPTION
**N BULKHEAD CRIMP JACK
(FOR RG-178B/U, RG-196A/U CABLE)**

PART NO. **172313**

DWG. NO. 172313.DWG

REV. A	SIZE A	SCALE NA
--------	--------	----------