

Excellent Integrated System Limited

Stocking Distributor

Click to view price, real time Inventory, Delivery & Lifecycle Information:

[Amphenol RF](#)
[172317](#)

For any questions, you can email us directly:

sales@integrated-circuit.com

REV.	DATE	DESCRIPTION
NC	07/07/04	INITIAL RELEASE

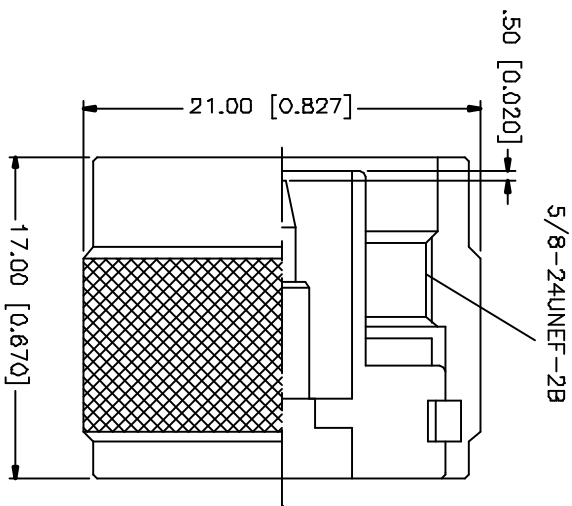

REV	DESCRIPTION	MATERIAL	FINISH	QTY	DO NOT SCALE DRAWING	APPROVALS	DATE	PART DESCRIPTION	DWG. NO.	REV.	SIZE	SCALE
B								<p>Amphenol Connex</p> <p>N SHORTING PLUG</p> <p>172317</p>	172317.DWG	NC	A	NA
7												
6												
5												
4												
3												
2	CONTACT BODY	BRASS	GOLD	1								
1	BODY	BRASS	NEXCOTE	1								
<p>UNLESS OTHERWISE SPECIFIED DIMENSIONS ARE IN INCHES AND FOR SUBSTITUTION REFERENCE ONLY.</p> <p>UNLESS OTHERWISE SPECIFIED TOLERANCES FOR MECHANICAL ARE:</p> <p>0.3 - 0.9mm ± 0.25mm</p> <p>0.9 - 3.0mm ± 0.40mm</p> <p>3.0 - 12.0mm ± 0.50mm</p> <p>UNLESS OTHERWISE SPECIFIED DIMENSIONS FOR METRIC ARE:</p> <p>0.20 - 0.318 = ± 0.0075</p> <p>0.318 - 1.180 = ± 0.015</p> <p>1.180 - 4.724 = ± 0.020</p>						<p>DO NOT SCALE DRAWING</p>		<p>APPROVALS</p> <p>DRAWN C.R.S. 07/07/04</p> <p>CHECKED</p> <p>ISSUED</p> <p>SHEET 1 OF 1</p>		<p>CAD FILE C:/172/172317.DWG</p>		