

## Excellent Integrated System Limited

Stocking Distributor

Click to view price, real time Inventory, Delivery & Lifecycle Information:

[FCI](#)  
[86093488314765V1LF](#)

For any questions, you can email us directly:  
[sales@integrated-circuit.com](mailto:sales@integrated-circuit.com)

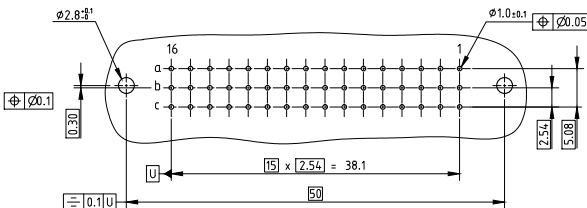
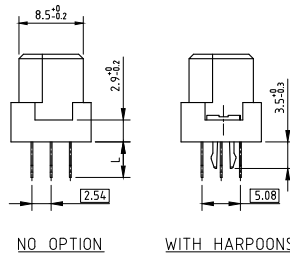
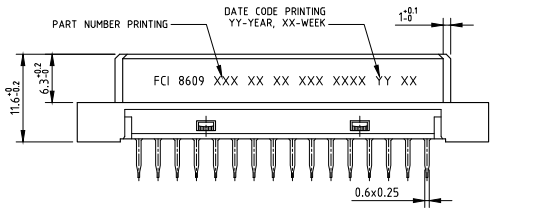
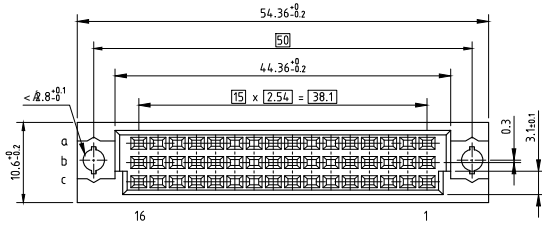

**TECHNICAL SPECIFICATION**

HOUSING MATERIAL	: THERMOPLASTIC POLYESTER UL94V0, GREY
HOUSING CAN WITHSTAND EXPOSURE TO LEAD FREE WAVE SOLDERING TEMPERATURE OF 260-285°C FOR STRAIGHT CONNECTORS AS IT IS IN CLASSICAL LEAD WAVE SOLDERING AT 235-250°C	
CONTACT & HARPOON MATERIAL	: COPPER ALLOY
CONTACT PLATING	
ACTIVE ZONE	: Au OVER Ni
TERMINATION ZONE	: Sn (PURE MATT) OVER Ni
HARPOON PLATING	: Sn (PURE MATT) OVER Ni

**ELECTRICAL DATA**

CURRENT RATING AT 20°C	: 15 A
CURRENT (I MAX)	: 2 A
TEMPERATURE RANGE	: -55°C TO +125°C
CONTACT RESISTANCE	: ≤ 20 mΩ
INSULATION RESISTANCE	: ≥ 10 <sup>10</sup> MΩ
TEST VOLTAGE (rms)	: 1000 V

**MECHANICAL DATA**

INSERTION FORCE PER CONTACT	: ≤ 0.94 N
EXTRACTION FORCE PER CONTACT	: ≥ 0.15 N
REFERENCE SPECIFICATION	: DIN 41612 / IEC 603-2

SERIES	8609	3	48	8	3	14	7	5	5	V1LF
ROWS FITTED WITH CONTACTS										
ROW a - b - c	3	48	8							
ROW 6 - c	4	32								
NO. OF CONTACTS										
TYPE OF INSULATOR										
3 ROW FEMALE INSULATOR	8									
METHOD OF MOUNTING										
STANDARD MOUNTING - STYLE C/2	3									
TERMINATION										
STRAIGHT SPILL LONG, L = 4.0±0.7	14									
STRAIGHT SPILL SHORT, L = 2.5±0.7	24									
OPTIONS										
NO OPTION	7									
WITH HARPOONS	H									
PERFORMANCE CLASS										
DIN 41612 CLASS 3	4									
DIN 41612 CLASS 2	5									
DIN 41612 CLASS 1	6									
AS PER MIL C 55302 / JIS 5000B	8									
PITCH PER ROW										
2.54 mm	5									
LEAD FREE VERSION	V1LF									

- NOTES:**
1. THE "LF" PRODUCTS MEET EUROPEAN UNION DIRECTIVES AND OTHER COUNTRY REGULATIONS AS DESCRIBED IN GS-22-008.
  2. THE HOUSING WILL WITHSTAND EXPOSURE TO 260°C PEAK TEMPERATURE FOR 3.5 SECONDS IN A WAVE SOLDER APPLICATION WITH A 1.6 MM MINIMUM THICK CIRCUIT BOARD.
  3. LEAD FREE OR RoHS DIRECTIVE LABELING TO BE PROVIDED AS PER GS-14-920 FOR LEAD FREE VERSION.

mat'l. code	SEE TECH. SPEC.	surface	ISO 1302	tolerance	ISO 406	ISO 1101	projection	product family	8609		
ltr	ecn no	dr	date	tolerances unless otherwise specified			mm	title	DIN STANDARD RECEPTACLE		
A	108-0171	KR	2008-12-19	angles	linear	0.1	scale 2:1	STRAIGHT SPILL DIN 41612 STYLE C/2			
B	ELX-010167	MJA	2012-02-07	0°±*				dwg no	C-8609-2140		
				dr	KESAVAN R	2008-04-15		sheet 1 of 1	size		
				emgr	KESAVAN R	2008-04-15		A3			
				chr	KESAVAN R	2008-04-15					
				appd	BIJU K. PAUL	2008-04-15					
sheet index	revision sheet	B	1							type	Product Customer Drawing