

## Excellent Integrated System Limited

Stocking Distributor

Click to view price, real time Inventory, Delivery & Lifecycle Information:

[Molex Connector Corporation](#)  
[46557-1145](#)

For any questions, you can email us directly:

[sales@integrated-circuit.com](mailto:sales@integrated-circuit.com)

10 9 8 7 6 5 4 3 2 1

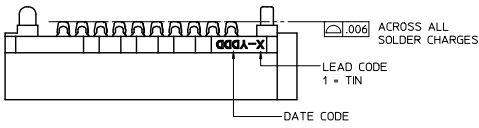

NOTE: THESE CODES MAY BE LOCATED ON EITHER SIDE OF THE HOUSING

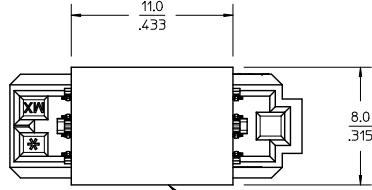
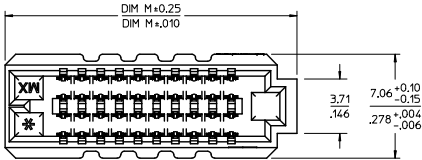

PICK AND PLACE PAD (SHOWN IN THIS VIEW ONLY)

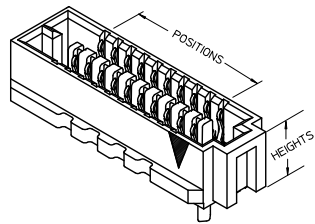
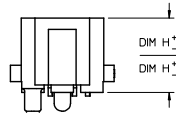
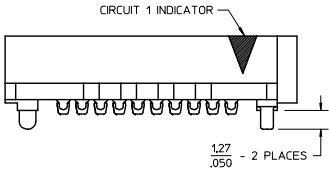

10 POSITION VERSION SHOWN IN THESE VIEWS

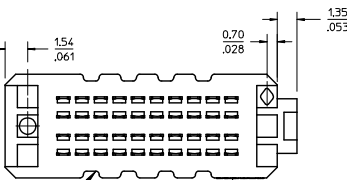

EDGE NOTCHES- SEE TABLE (THE NUMBER OF NOTCHES INCREASES AS THE NUMBER OF POSITIONS INCREASES)

NOTES:

- MATERIALS: HOUSING: GLASS FILLED LCP (LIQUID CRYSTAL POLYMER), UL94V-0, BLACK  
CONTACTS: COPPER ALLOY  
SOLDER CHARGE: 95.5% TIN, 3.8% SILVER, 0.7% COPPER
- FINISHES: 30 MICROINCH MINIMUM GOLD IN THE CONTACT AREA, 50 MICROINCH MINIMUM TIN IN THE TAIL AREA, OVERALL NICKEL UNDERPLATE.
- PRODUCT SPECIFICATION: PS-45970-001
- PACKAGING SPECIFICATION: PK-45971-002 (TAPE AND REEL)
- MATES WITH SEARAY SLIM PLUG ASSY SERIES 46556
- APPLICATION SPECIFICATION: AS-45970-001
- COSMETIC SPECIFICATION: PS-45499-002 CLASS B
- PART STATUS: CONTACT MOLEX

| POSITIONS | DIM M       |           | TOTAL NUMBER OF EDGE NOTCHES |
|-----------|-------------|-----------|------------------------------|
| 10        | 19.88/7.84  | 0.15/0.06 | 8                            |
| 15        | 26.23/1.034 | 0.15/0.06 | 14                           |
| 20        | 32.58/1.284 | 0.15/0.06 | 18                           |
| 25        | 38.93/1.534 | 0.15/0.06 | 24                           |
| 30        | 45.28/1.784 | 0.15/0.06 | 28                           |
| 35        | 51.63/2.034 | 0.15/0.06 | 34                           |
| 40        | 57.98/2.284 | 0.15/0.06 | 38                           |
| 45        | 64.33/2.534 | 0.23/0.09 | 44                           |
| 50        | 70.68/2.784 | 0.23/0.09 | 48                           |

|   |                     |   |      |                              |     |                       |                   |  |  |
|---|---------------------|---|------|------------------------------|-----|-----------------------|-------------------|--|--|
| CLARIFY OVERALL LENGTH<br>EC NO: IJCP2015-5493<br>DRWNSVANG01 2015/04/25<br>CHKD: IBARRA 2015/08/04<br>APPR: SMILLER 2015/08/07 | QUALITY SYMBOLS<br> | GENERAL TOLERANCES (UNLESS SPECIFIED)   |      | DIMENSION STYLE MM/IN        |     | SCALE 4:1             | DESIGN UNITS INCH | THIRD ANGLE PROJECTION   |  |
|   |                     | 4 PLACES ±  | ---  | ---                          | --- | DRAWN BY TGREGOR I    | DATE 2007/05/21   | TITLE<br>SEARAY SLIM (4 ROW) RECEPTACLE ASSEMBLY<br>1.27/0.50 PITCH<br><br>DOCUMENT NO. SD-46557-001<br>SHEET NO. 1 OF 3 |  |
|   |                     | 3 PLACES ±  | ---  | ±.010                        | --- | CHECKED BY JCOMERC I  | DATE 2007/05/21   |  |  |
|   |                     | 2 PLACES ±  | 0.25 | ±.015                        | --- | APPROVED BY JCOMERC I | DATE 2010/03/05   |  |  |
| 1 PLACE ±   | 0.38                | ---   | ---  | MATERIAL NO. SEE TABLE SHT 3 |     |                       |                   |  |  |
| ANGULAR ±---°<br>DRAFT WHERE APPLICABLE MUST REMAIN WITHIN DIMENSIONS   |                     | SIZE B<br>THIS DRAWING CONTAINS INFORMATION THAT IS PROPRIETARY TO MOLEX INCORPORATED AND SHOULD NOT BE USED WITHOUT WRITTEN PERMISSION |      |                              |     |                       |                   |  |  |

9 8 7 6 5 4 3 2 1

10 9 8 7 6 5 4 3 2 1

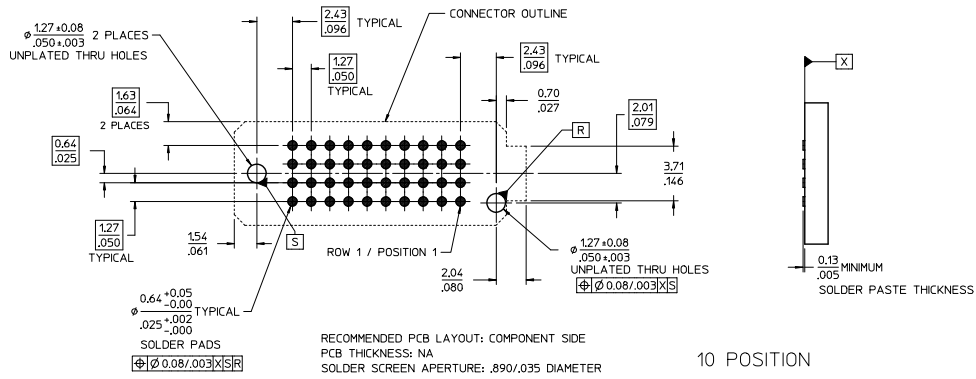

10 POSITION  
VERSION SHOWN

| DIM P<br>PLUG STACK HEIGHT | DIM R<br>RECEPTACLE STACK HEIGHT |      |      |      |      |     |
|----------------------------|----------------------------------|------|------|------|------|-----|
|                            | MM                               | 5.0  | 6.0  | 6.5  | 7.5  | 8.0 |
| 2.0                        | 7.0                              | 8.0  | 8.5  | 9.5  | 10.0 |     |
| 3.0                        | 8.0                              | 9.0  | 9.5  | 10.5 | 11.0 |     |
| 3.5                        | 8.5                              | 9.5  | 10.0 | 11.0 | 11.5 |     |
| 2.5                        | 7.5                              | 8.5  | 9.0  | 10.0 | 10.5 |     |
| 4.5                        | 9.5                              | 10.5 | 11.0 | 12.0 | 12.5 |     |
| 5.0                        | 10.0                             | 11.0 | 11.5 | 12.5 | 13.0 |     |
| 7.0                        | 12.0                             | 13.0 | 13.5 | 14.5 | 15.0 |     |

MATED STACK HEIGHTS  
GIVEN IN MILLIMETERS (MM) FOR REFERENCE ONLY

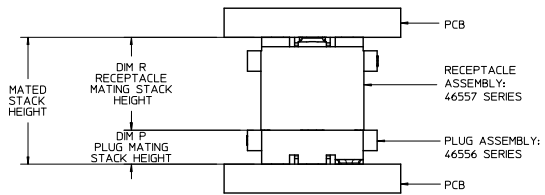

STACK HEIGHTS  
GIVEN IN MILLIMETERS (MM) FOR REFERENCE ONLY

|  |  |                                       |                 |                 |   |   |              |                        |
|--|--|---------------------------------------|-----------------|-----------------|---|---|--------------|------------------------|
| SEE SHEET 1<br>E.C. NO: ICP2015-5493<br>DR: WANG01 2015/06/25<br>CHK: IBARRA 2015/08/04<br>APPR: MILLER 2015/08/07<br>REV: | QUALITY SYMBOLS                                      | GENERAL TOLERANCES (UNLESS SPECIFIED) |                 | DIMENSION STYLE |   | SCALE   | DESIGN UNITS | THIRD ANGLE PROJECTION |
|  | $\nabla=0$<br>$\nabla=0$<br>$\nabla=0$               | mm                                    | INCH            | MM/IN           |   | 4:1   | INCH         |                        |
|  |  | 4 PLACES ± --- ± ---                  |                 | DRAWN BY        | DATE  | TITLE   |              |                        |
|  |  | 3 PLACES ± --- ± .010                 |                 | TGREGORI        | 2007/05/21  | SEARAY SLIM (4 ROW)<br>RECEPTACLE ASSEMBLY<br>1.27/.050 PITCH |              |                        |
|  | 2 PLACES ± 0.25 ± .015                               |                                       | CHECKED BY      | DATE            | <b>molex</b><br>DOCUMENT NO. SD-46557-001<br>SHEET NO. 2 OF 3   |   |              |                        |
|  | 1 PLACE ± 0.38 ± ---                                 |                                       | JCOMERC I       | 2007/05/21      |   |   |              |                        |
|  | 0 PLACE ± ±  |                                       | APPROVED BY     | DATE            |   |   |              |                        |
|  |  |                                       | JCOMERC I       | 2010/03/05      |   |   |              |                        |
|  | ANGULAR ± --- °                                      |                                       | MATERIAL NO.    |                 |   |   |              |                        |
|  | DRAFT WHERE APPLICABLE MUST REMAIN WITHIN DIMENSIONS |                                       | SEE TABLE SHT 3 |                 |   |   |              |                        |
|  |  |                                       | SIZE B          |                 | THIS DRAWING CONTAINS INFORMATION THAT IS PROPRIETARY TO MOLEX INCORPORATED AND SHOULD NOT BE USED WITHOUT WRITTEN PERMISSION |   |              |                        |

9 8 7 6 5 4 3 2 1

10 9 8 7 6 5 4 3 2 1

| DIM R: (REF) | 5.0 MM      | 6.0 MM      | 6.5 MM      | 7.5 MM      | 8.0 MM      |
|--------------|-------------|-------------|-------------|-------------|-------------|
| DIM H:       | 5.04/.199   | 6.04/.238   | 6.55/.258   | 7.54/.297   | 8.05/.317   |
| POSITIONS    | MATERIAL NO | MATERIAL NO | MATERIAL NO | MATERIAL NO | MATERIAL NO |
| 10           | 46557-1145  | 46557-1245  | 46557-1345  | 46557-1445  | 46557-1545  |
| 20           | 46557-2145  | 46557-2245  | 46557-2345  | 46557-2445  | 46557-2545  |
| 30           | 46557-3145  | 46557-3245  | 46557-3345  | 46557-3445  | 46557-3545  |
| 40           | 46557-4145  | 46557-4245  | 46557-4345  | 46557-4445  | 46557-4545  |
| 50           | 46557-5145  | 46557-5245  | 46557-5345  | 46557-5445  | 46557-5545  |
| 15           | 46557-6145  | 46557-6245  | 46557-6345  | 46557-6445  | 46557-6545  |
| 25           | 46557-7145  | 46557-7245  | 46557-7345  | 46557-7445  | 46557-7545  |
| 35           | 46557-8145  | 46557-8245  | 46557-8345  | 46557-8445  | 46557-8545  |
| 45           | 46557-9145  | 46557-9245  | 46557-9345  | 46557-9445  | 46557-9545  |

MATING STACK HEIGHTS (DIMENSION R)  
GIVEN IN MILLIMETERS (MM) FOR REFERENCE ONLY

|  |                 |                                       |       |                       |  |                 |   |                        |
|--|-----------------|---------------------------------------|-------|-----------------------|--|-----------------|---|------------------------|
| SEE SHEET 1<br>EC NO: UCP2015-5493<br>DRWNSVANG01 2015/04/25<br>CHKCDT IBARRA 2015/08/04<br>APPRESMILLER 2015/08/07<br>REV | QUALITY SYMBOLS | GENERAL TOLERANCES (UNLESS SPECIFIED) |       | DIMENSION STYLE MM/IN |  | SCALE 1:1       | DESIGN UNITS INCH   | THIRD ANGLE PROJECTION |
|  |                 | 4 PLACES ±                            | mm    | INCH                  | DRAWN BY T GREGOR I  | DATE 2007/05/21 | TITLE SEARAY SLIM (4 ROW) RECEPTACLE ASSEMBLY 1.27/.050 PITCH |                        |
|  |                 | 3 PLACES ±                            | ±.010 |                       | CHECKED BY JCOMERC I   | DATE 2007/05/21 | molex   |                        |
|  |                 | 2 PLACES ±                            | ±0.25 | ±.015                 | APPROVED BY JCOMERC I  | DATE 2010/03/05 | DOCUMENT NO. SD-46557-001                                     | SHEET NO. 3 OF 3       |
|  |                 | 1 PLACE ±                             | ±0.38 | ±                     | MATERIAL NO. SEE TABLE   |                 |   |                        |
|  |                 | 0 PLACE ±                             | ±     | ±                     | SIZE B THIS DRAWING CONTAINS INFORMATION THAT IS PROPRIETARY TO MOLEX INCORPORATED AND SHOULD NOT BE USED WITHOUT WRITTEN PERMISSION |                 |   |                        |

9 8 7 6 5 4 3 2 1