

## Excellent Integrated System Limited

Stocking Distributor

Click to view price, real time Inventory, Delivery & Lifecycle Information:

[TE Connectivity Raychem Circuit Protection  
TR600-150](#)

For any questions, you can email us directly:

[sales@integrated-circuit.com](mailto:sales@integrated-circuit.com)

**Tyco / Electronics**  
**Raychem Circuit Protection**  
 308 Constitution Drive  
 Menlo Park, CA 94025-1164  
 Phone: 800-227-4856  
 Fax: 800-227-4866

**PolySwitch®**  
**PTC Devices**  
 Overcurrent Protection Device

**PRODUCT: TR600-150**

DOCUMENT: SCD 22231  
 PCN: 050889  
 REV LETTER: L  
 REV DATE: MAY 15, 2003  
 PAGE NO.: 1 OF 1

**Specification Status: Released**

**Max Electrical Rating at 20°C**

**Operating Voltage: 60V<sub>DC</sub>**



**Fault Voltage: 600V<sub>RMS</sub>**

**Interrupt Current: 3A<sub>RMS</sub>**

Lead Material:

22 AWG Sn/Pb plated copper

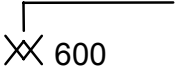
Marking:

- 
Raychem Logo and Voltage
- 150 — Part Identification
- 
Lot Identification

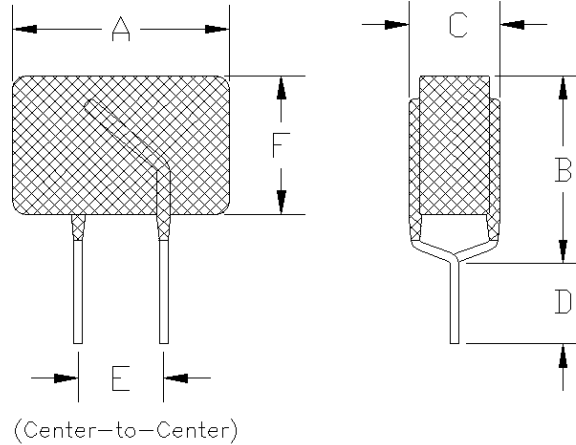

**TABLE I. DIMENSIONS:**

	A		B		C		D		E	F
	MIN	MAX	MIN	MAX	MIN	MAX	MIN	MAX	NOM	MAX
mm:	--	13.5	--	12.6	--	6.0	4.7	--	5.0	10.0
in:	--	(0.531)	--	(0.496)	--	(0.236)	(0.185)	--	(0.197)	(0.394)

**TABLE II. PERFORMANCE RATINGS @ 20°C (unless otherwise noted):**

IHOLD (A)		RESISTANCE (Ω)			TIME TO TRIP (s) @ 1A		OPERATING TEMPERATURE (°C)	
20°C	60°C	R MIN	R MAX	R <sub>1 MAX</sub> *	TYP	MAX	MIN	MAX
0.150	0.096	6.0	12.0	22.0	5.0	8.0	-40	85

\*Maximum device resistance at 20°C measured 1 hour post trip.

Agency Recognition:  
 Reference Documents:  
 Precedence:  
 Effectivity:  
 CAUTION:

UL, CSA  
 PS300  
 This specification takes precedence over documents referenced herein.  
 Reference documents shall be the issue in effect on the date of invitation for bid.  
 Operation beyond the rated voltage or current may result in rupture, electrical arcing or flame.