

## Excellent Integrated System Limited

Stocking Distributor

Click to view price, real time Inventory, Delivery & Lifecycle Information:

[Amphenol Commercial Products](#)  
[101-00158-64](#)

For any questions, you can email us directly:

[sales@integrated-circuit.com](mailto:sales@integrated-circuit.com)

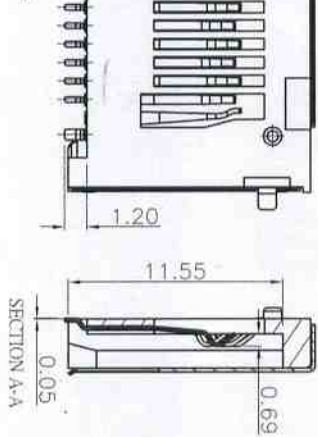
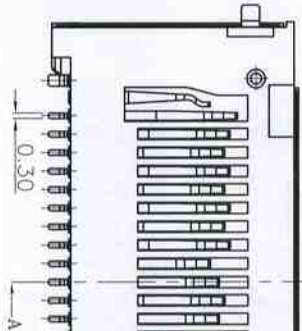
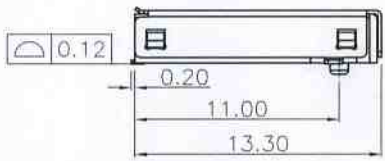
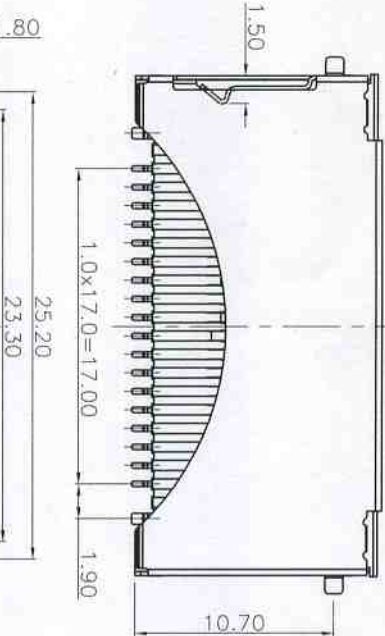
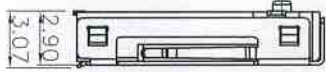
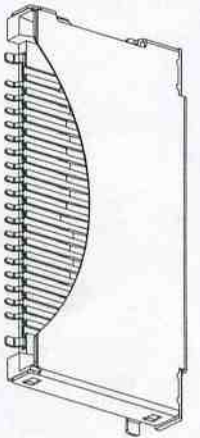
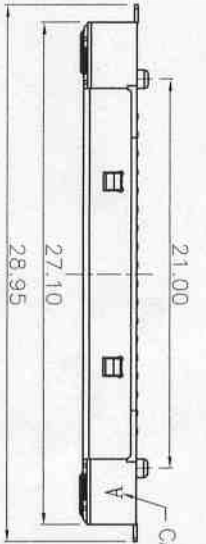

PIN NO.	FUNCTION
1	QW/CARD DETECT
2	READY/BSY
3	RD0 ENABLE
4	CARD ENABLE
5	COMMAND LATCH ENABLE
6	ADDRESS LATCH ENABLE
7	WRITE ENABLE
8	WRITE PROTECT
9	QND
10	DATA0
11	DATA1
12	DATA2
13	DATA3
14	DATA4
15	DATA5
16	DATA6
17	DATA7
18/20	VCC

NOTE:

- MECHANICAL CHARACTERISTICS
  - Insertion Force: 9.8 N (MAX)
  - Extraction Force: 1.47 N (MIN)
- ELECTRICAL CHARACTERISTICS
  - Current rating : 0.5 A
  - Operating voltage : 3.3V
  - Contact resistance: 40m ohms max.
  - Insulation resistance: 1000M ohms min. at 500 VDC
  - Dielectric withstanding voltage: 250 VAC/1minute
  - Operating Temperature: -0°C~+55°C
  - Storage Temperature: -20°C~+65°C
  - Operation/Storage humidity: 95% or less

THE PART NUMBER:  
101-00158-\*\*

- 功能區鍍金1u",錫腳鍍亮地鍍至少160u"
- 功能區鍍金3u",錫腳鍍亮地鍍至少160u"
- 功能區鍍金5u",錫腳鍍亮地鍍至少160u"
- 功能區鍍金10u",錫腳鍍亮地鍍至少160u"
- 功能區鍍金15u",錫腳鍍亮地鍍至少160u"
- 功能區鍍金30u",錫腳鍍亮地鍍至少160u"
- 功能區鍍金50u",錫腳鍍亮地鍍至少160u"
- 功能區鍍金100u",錫腳鍍亮地鍍至少160u"
- 功能區鍍金150u",錫腳鍍亮地鍍至少160u"
- 功能區鍍金300u",錫腳鍍亮地鍍至少160u"
- 功能區鍍金500u",錫腳鍍亮地鍍至少160u"
- 功能區鍍金1000u",錫腳鍍亮地鍍至少160u"
- 功能區鍍金1500u",錫腳鍍亮地鍍至少160u"
- 功能區鍍金3000u",錫腳鍍亮地鍍至少160u"
- 功能區鍍金5000u",錫腳鍍亮地鍍至少160u"

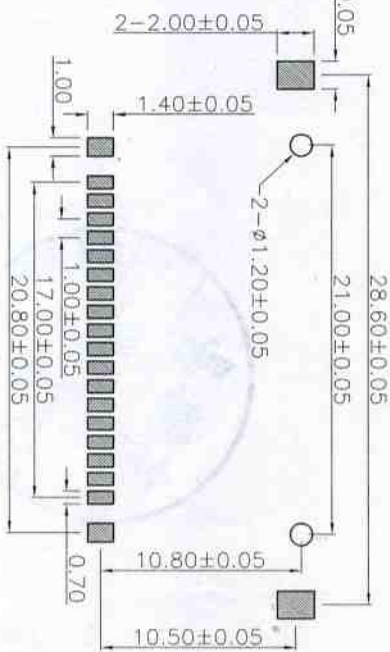

MATERIALS & PLATINGS TABLE

ITEM	DESCRIPTION	QTY	MATERIAL	FINISH
①	SHELL	1	STAINLESS STEEL	301-00857-10
②	TER	1	PHOSPHER	301-00858-**
③	HOUSING	1	LCP	201-00194-02

GENERAL	TOLERANCE	FILE NO.	PART NO.	DRAWN	CHECKED	APPROVED	MATERIAL	SCALE	NO SCALE
x:±0.50	x:±5°	101-00158	101-00158-**	LZH	楊	SM	3/17'07		
.x±0.38	.x'±2°	REV. A	XD NO PUSH CONN.-I		Jeffrey				
.xx±0.25	.xx±1°	SIZE A4	SHEET 1/1						

REV.	EQU. NO.	MODIFY. CONTENT	DATE
X1		新增規格	3/16'06
X2		更改鍍金電鍍規格	7/22'06
A	ES:10003.003	暫行改轉正式板	3/17'07

XD DEFINITION