

## Excellent Integrated System Limited

Stocking Distributor

Click to view price, real time Inventory, Delivery & Lifecycle Information:

[Weidmüller](#)  
[1944260000](#)

For any questions, you can email us directly:

[sales@integrated-circuit.com](mailto:sales@integrated-circuit.com)

Product catalogue | PCB connection systems | PCB plug-in connectors | Pitch 5.00 / 5.08 mm (0.197 / 0.200 inch) | Socket connectors, tension clamp connection, pitch 5.00/5.08 | BLZP 5.00/5.08/180 | BLZP 5.08/180F SN

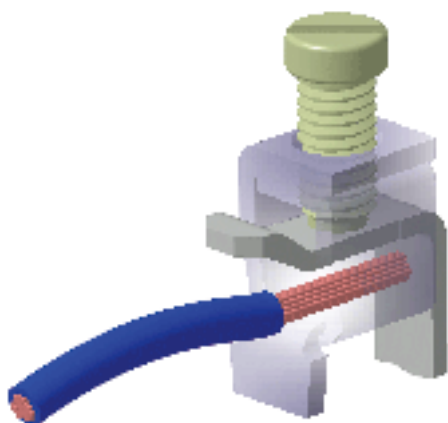
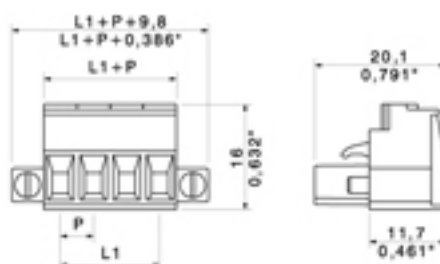

#### General ordering data

Order No.	1944260000
Part designation	BLZP 5.08/19/180F SN OR BX
Version	PCB plug-in connector, Clamping yoke connection, Clamping range, max.: 4 mm <sup>2</sup> , Pitch in mm: 5.08 mm, No. of poles: 19, 180°, Box
EAN	4032248618842
Qty.	18 pc(s).
Packaging	Box

#### System parameters

Conductor connection system	Clamping yoke connection
Outgoing direction of conductor	180°
Pitch in mm	5.08 mm
Pitch in inch	0.2 inch
No. of poles	19
No. of rows	1
Screwdriver blade	0.6 x 3.5

Product catalogue | PCB connection systems | PCB plug-in connectors | Pitch 5.00 / 5.08 mm (0.197 / 0.200 inch) | Socket connectors, tension clamp connection, pitch 5.00/5.08 | BLZP 5.00/5.08/180 | BLZP 5.08/180F SN

#### System parameters

Screwdriver blade standard	DIN 5264
Tightening torque, min.	0.4 Nm
Tightening torque, max.	0.5 Nm
Clamping screw	M 2.5
Stripping length	7 mm
L1 in mm	91.44 mm
L1 in inch	3.6 inch
Electric shock protection to DIN VDE 57 106	Safe from finger touch

#### Material data

Insulating material	PBT
Colour	Orange
Flammability class UL 94	V-0
CTI	>= 200
Contact material	Copper alloy
Contact surface	tinned
Contact base material	Copper alloy

#### Connectable conductors

Clamping range, min.	0.13 mm <sup>2</sup>
Clamping range, max.	4 mm <sup>2</sup>
Conductor connection cross-section AWG, min.	AWG 26
Conductor connection cross-section AWG, max.	AWG 12
Solid, min. H05(07) V-U	0.2 mm <sup>2</sup>
Solid, max. H05(07) V-U	4 mm <sup>2</sup>
Flexible, min. H05(07) V-K	0.2 mm <sup>2</sup>
Flexible, max. H05(07) V-K	4 mm <sup>2</sup>
w. wire end ferrule, DIN 46228 pt 1, min	0.2 mm <sup>2</sup>
with wire end ferrule, DIN 46228 pt 1, max.	4 mm <sup>2</sup>
w. plastic collar ferrule, DIN 46228 pt 4, min.	0.2 mm <sup>2</sup>
with plastic collar ferrule, DIN 46228 pt 4, max.	2.5 mm <sup>2</sup>
Gauge to EN 60999 a x b; ø	2.8 mm x 2.4 mm

#### DIN IEC rating data

Rated current, min. No. of poles (Tu=20°C)	19 A
Rated current, max. No. of poles (Tu=20°C)	15.5 A
Rated current, no. of poles (Tu=40°C), min.	16 A
Rated current, no. of poles (Tu=40°C), max.	13 A
Rated voltage for overvoltage class/pollution severity II/2	400 V
Rated voltage for overvoltage class/pollution severity III/2	320 V
Rated voltage at overvoltage category/pollution degree III/3	250 V
Rated impulse withstand voltage for overvoltage class/pollution severity II/2	4 kV
Rated impulse withstand voltage for overvoltage class/pollution severity III/2	4 kV
Rated impulse withstand voltage for overvoltage class/pollution severity III/3	4 kV
Short-time withstand current resistance	3 x 1s with 120 A

Product catalogue | PCB connection systems | PCB plug-in connectors | Pitch 5.00 / 5.08 mm (0.197 / 0.200 inch) | Socket connectors, tension clamp connection, pitch 5.00/5.08 | BLZP 5.00/5.08/180 | BLZP 5.08/180F SN

#### DIN IEC rating data

#### CSA rating data

Rated voltage (Use group B)	300 V
Rated current (use group B)	10 A
Rated voltage (Use group C)	50 V
Rated voltage (use group D)	300 V
Rated current (use group D)	10 A
Wire cross-section, AWG, min.	AWG 26
Wire cross-section, AWG, max.	AWG 12

#### UL 1059 rating data

Rated voltage (use group B)	300 V
Rated current (use group B)	10 A
Rated voltage (use group C)	50 V
Rated voltage	300 V
Rated current	10 A
Wire cross-section, AWG, min.	AWG 26
Wire cross-section, AWG, max.	AWG 12

#### Approvals

Approvals institutes	CURUS
----------------------	-------

#### Classifications

eClass 6.0	27-26-07-08
------------	-------------

#### Notes

Notes

#### Similar products

Order No.	Part designation	Version
1944090000	BLZP 5.08/02/180F SN OR BX	PCB plug-in connector, Clamping yoke connection, Clamping range, max.: 4 mm <sup>2</sup> , Pitch in mm: 5.08 mm, No. of poles: 2, 180°, Box
1944100000	BLZP 5.08/03/180F SN OR BX	PCB plug-in connector, Clamping yoke connection, Clamping range, max.: 4 mm <sup>2</sup> , Pitch in mm: 5.08 mm, No. of poles: 3, 180°, Box
1944110000	BLZP 5.08/04/180F SN OR BX	PCB plug-in connector, Clamping yoke connection, Clamping range, max.: 4 mm <sup>2</sup> , Pitch in mm: 5.08 mm, No. of poles: 4, 180°, Box
1944120000	BLZP 5.08/05/180F SN OR BX	PCB plug-in connector, Clamping yoke connection, Clamping range, max.: 4 mm <sup>2</sup> , Pitch in mm: 5.08 mm, No. of poles: 5, 180°, Box
1944130000	BLZP 5.08/06/180F SN OR BX	PCB plug-in connector, Clamping yoke connection, Clamping range, max.: 4 mm <sup>2</sup> , Pitch in mm: 5.08 mm, No. of poles: 6, 180°, Box
1944140000	BLZP 5.08/07/180F SN OR BX	PCB plug-in connector, Clamping yoke connection, Clamping range, max.: 4 mm <sup>2</sup> , Pitch in mm: 5.08 mm, No. of poles: 7, 180°, Box
1944150000	BLZP 5.08/08/180F SN OR BX	PCB plug-in connector, Clamping yoke connection, Clamping range, max.: 4 mm <sup>2</sup> , Pitch in mm: 5.08 mm, No. of poles: 8, 180°, Box
1944160000	BLZP 5.08/09/180F SN OR BX	PCB plug-in connector, Clamping yoke connection, Clamping range, max.: 4 mm <sup>2</sup> , Pitch in mm: 5.08 mm, No. of poles: 9, 180°, Box
1944170000	BLZP 5.08/10/180F SN OR BX	PCB plug-in connector, Clamping yoke connection, Clamping range, max.: 4 mm <sup>2</sup> , Pitch in mm: 5.08 mm, No. of poles: 10, 180°, Box

Product catalogue | PCB connection systems | PCB plug-in connectors | Pitch 5.00 / 5.08 mm (0.197 / 0.200 inch) | Socket connectors, tension clamp connection, pitch 5.00/5.08 | BLZP 5.00/5.08/180 | BLZP 5.08/180F SN

1944180000	BLZP 5.08/11/180F SN OR BX	PCB plug-in connector, Clamping yoke connection, Clamping range, max.: 4 mm <sup>2</sup> , Pitch in mm: 5.08 mm, No. of poles: 11, 180°, Box
1944190000	BLZP 5.08/12/180F SN OR BX	PCB plug-in connector, Clamping yoke connection, Clamping range, max.: 4 mm <sup>2</sup> , Pitch in mm: 5.08 mm, No. of poles: 12, 180°, Box
1944200000	BLZP 5.08/13/180F SN OR BX	PCB plug-in connector, Clamping yoke connection, Clamping range, max.: 4 mm <sup>2</sup> , Pitch in mm: 5.08 mm, No. of poles: 13, 180°, Box
1944210000	BLZP 5.08/14/180F SN OR BX	PCB plug-in connector, Clamping yoke connection, Clamping range, max.: 4 mm <sup>2</sup> , Pitch in mm: 5.08 mm, No. of poles: 14, 180°, Box
1944220000	BLZP 5.08/15/180F SN OR BX	PCB plug-in connector, Clamping yoke connection, Clamping range, max.: 4 mm <sup>2</sup> , Pitch in mm: 5.08 mm, No. of poles: 15, 180°, Box
1944230000	BLZP 5.08/16/180F SN OR BX	PCB plug-in connector, Clamping yoke connection, Clamping range, max.: 4 mm <sup>2</sup> , Pitch in mm: 5.08 mm, No. of poles: 16, 180°, Box
1944240000	BLZP 5.08/17/180F SN OR BX	PCB plug-in connector, Clamping yoke connection, Clamping range, max.: 4 mm <sup>2</sup> , Pitch in mm: 5.08 mm, No. of poles: 17, 180°, Box
1944250000	BLZP 5.08/18/180F SN OR BX	PCB plug-in connector, Clamping yoke connection, Clamping range, max.: 4 mm <sup>2</sup> , Pitch in mm: 5.08 mm, No. of poles: 18, 180°, Box
1944270000	BLZP 5.08/20/180F SN OR BX	PCB plug-in connector, Clamping yoke connection, Clamping range, max.: 4 mm <sup>2</sup> , Pitch in mm: 5.08 mm, No. of poles: 20, 180°, Box
1944280000	BLZP 5.08/21/180F SN OR BX	PCB plug-in connector, Clamping yoke connection, Clamping range, max.: 4 mm <sup>2</sup> , Pitch in mm: 5.08 mm, No. of poles: 21, 180°, Box
1944290000	BLZP 5.08/22/180F SN OR BX	PCB plug-in connector, Clamping yoke connection, Clamping range, max.: 4 mm <sup>2</sup> , Pitch in mm: 5.08 mm, No. of poles: 22, 180°, Box
1944300000	BLZP 5.08/23/180F SN OR BX	PCB plug-in connector, Clamping yoke connection, Clamping range, max.: 4 mm <sup>2</sup> , Pitch in mm: 5.08 mm, No. of poles: 23, 180°, Box
1944310000	BLZP 5.08/24/180F SN OR BX	PCB plug-in connector, Clamping yoke connection, Clamping range, max.: 4 mm <sup>2</sup> , Pitch in mm: 5.08 mm, No. of poles: 24, 180°, Box