

Excellent Integrated System Limited

Stocking Distributor

Click to view price, real time Inventory, Delivery & Lifecycle Information:

[Weidmüller](#)
[1946110000](#)

For any questions, you can email us directly:
sales@integrated-circuit.com

Product catalogue | PCB connection systems | PCB plug-in connectors | Pitch 5.00 / 5.08 mm (0.197 / 0.200 inch) | Socket connectors, tension clamp connection, pitch 5.00/5.08 | BLZP 5.08/225 | BLZP 5.08/225B SN

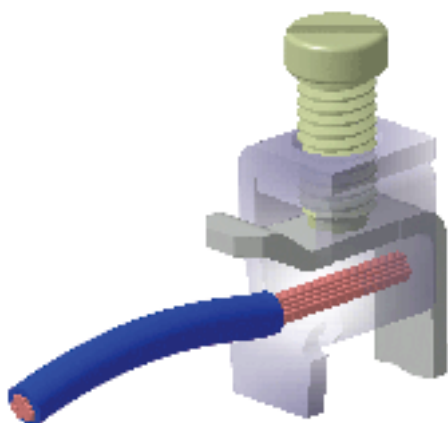
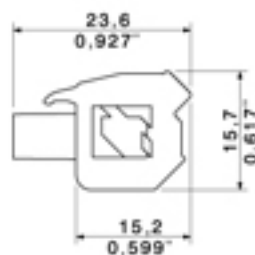
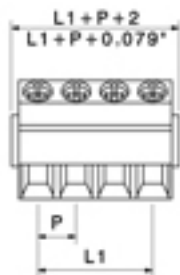

General ordering data

Order No.	1946110000
Part designation	BLZP 5.08/15/225B SN BK BX
Version	PCB plug-in connector, Clamping yoke connection, Clamping range, max.: 4 mm ² , Pitch in mm: 5.08 mm, No. of poles: 15, 225°, Box
EAN	4032248621675
Qty.	24 pc(s).
Packaging	Box

System parameters

Conductor connection system	Clamping yoke connection
Outgoing direction of conductor	225°
Pitch in mm	5.08 mm
Pitch in inch	0.2 inch
No. of poles	15
No. of rows	1
Screwdriver blade	0.6 x 3.5

System parameters

Screwdriver blade standard	DIN 5264
Tightening torque, min.	0.4 Nm
Tightening torque, max.	0.5 Nm
Clamping screw	M 2.5
Stripping length	7 mm
L1 in mm	71.12 mm
L1 in inch	2.8 inch
Electric shock protection to DIN VDE 57 106	Safe from finger touch

Material data

Insulating material	PBT
Colour	black
Flammability class UL 94	V-0
CTI	>= 200
Contact material	Copper alloy
Contact surface	tinned
Contact base material	Copper alloy

Connectable conductors

Clamping range, min.	0.13 mm ²
Clamping range, max.	4 mm ²
Conductor connection cross-section AWG, min.	AWG 26
Conductor connection cross-section AWG, max.	AWG 12
Solid, min. H05(07) V-U	0.2 mm ²
Solid, max. H05(07) V-U	4 mm ²
Flexible, min. H05(07) V-K	0.2 mm ²
Flexible, max. H05(07) V-K	4 mm ²
w. wire end ferrule, DIN 46228 pt 1, min.	0.2 mm ²
with wire end ferrule, DIN 46228 pt 1, max.	4 mm ²
w. plastic collar ferrule, DIN 46228 pt 4, min.	0.2 mm ²
with plastic collar ferrule, DIN 46228 pt 4, max.	2.5 mm ²
Gauge to EN 60999 a x b; ø	2.8 mm x 2.4 mm

DIN IEC rating data

Rated current, min. No. of poles (Tu=20°C)	17.5 A
Rated current, max. No. of poles (Tu=20°C)	14 A
Rated current, no. of poles (Tu=40°C), min.	14 A
Rated current, no. of poles (Tu=40°C), max.	12 A
Rated voltage for overvoltage class/pollution severity II/2	400 V
Rated voltage for overvoltage class/pollution severity III/2	320 V
Rated voltage at overvoltage category/pollution degree III/3	250 V
Rated impulse withstand voltage for overvoltage class/pollution severity II/2	4 kV
Rated impulse withstand voltage for overvoltage class/pollution severity III/2	4 kV
Rated impulse withstand voltage for overvoltage class/pollution severity III/3	4 kV
Short-time withstand current resistance	3 x 1s with 120 A

Product catalogue | PCB connection systems | PCB plug-in connectors | Pitch 5.00 / 5.08 mm (0.197 / 0.200 inch) | Socket connectors, tension clamp connection, pitch 5.00/5.08 | BLZP 5.08/225 | BLZP 5.08/225B SN

DIN IEC rating data
CSA rating data

Rated voltage (Use group B)	300 V
Rated current (use group B)	10 A
Rated voltage (Use group C)	50 V
Rated voltage (use group D)	300 V
Rated current (use group D)	10 A
Wire cross-section, AWG, min.	AWG 26
Wire cross-section, AWG, max.	AWG 12

UL 1059 rating data

Rated voltage (use group B)	300 V
Rated current (use group B)	10 A
Rated voltage (use group C)	50 V
Rated voltage	300 V
Rated current	10 A
Wire cross-section, AWG, min.	AWG 26
Wire cross-section, AWG, max.	AWG 12

Approvals

Approvals institutes	CURUS
----------------------	-------

Classifications

eClass 6.0	27-26-07-08
------------	-------------

Notes

Notes

Similar products

Order No.	Part designation	Version
1946080000	BLZP 5.08/12/225B SN BK BX	
1945750000	BLZP 5.08/02/225B SN OR BX	PCB plug-in connector, Clamping yoke connection, Clamping range, max.: 4 mm ² , Pitch in mm: 5.08 mm, No. of poles: 2, 225°, Box
1945760000	BLZP 5.08/03/225B SN OR BX	PCB plug-in connector, Clamping yoke connection, Clamping range, max.: 4 mm ² , Pitch in mm: 5.08 mm, No. of poles: 3, 225°, Box
1945770000	BLZP 5.08/04/225B SN OR BX	PCB plug-in connector, Clamping yoke connection, Clamping range, max.: 4 mm ² , Pitch in mm: 5.08 mm, No. of poles: 4, 225°, Box
1945780000	BLZP 5.08/05/225B SN OR BX	PCB plug-in connector, Clamping yoke connection, Clamping range, max.: 4 mm ² , Pitch in mm: 5.08 mm, No. of poles: 5, 225°, Box
1945790000	BLZP 5.08/06/225B SN OR BX	PCB plug-in connector, Clamping yoke connection, Clamping range, max.: 4 mm ² , Pitch in mm: 5.08 mm, No. of poles: 6, 225°, Box
1945800000	BLZP 5.08/07/225B SN OR BX	PCB plug-in connector, Clamping yoke connection, Clamping range, max.: 4 mm ² , Pitch in mm: 5.08 mm, No. of poles: 7, 225°, Box
1945810000	BLZP 5.08/08/225B SN OR BX	PCB plug-in connector, Clamping yoke connection, Clamping range, max.: 4 mm ² , Pitch in mm: 5.08 mm, No. of poles: 8, 225°, Box
1945820000	BLZP 5.08/09/225B SN OR BX	PCB plug-in connector, Clamping yoke connection, Clamping range, max.: 4 mm ² , Pitch in mm: 5.08 mm, No. of poles: 9, 225°, Box

Product catalogue | PCB connection systems | PCB plug-in connectors | Pitch 5.00 / 5.08 mm (0.197 / 0.200 inch) | Socket connectors, tension clamp connection, pitch 5.00/5.08 | BLZP 5.08/225 | BLZP 5.08/225B SN

1945830000	BLZP 5.08/10/225B SN OR BX	PCB plug-in connector, Clamping yoke connection, Clamping range, max.: 4 mm ² , Pitch in mm: 5.08 mm, No. of poles: 10, 225°, Box
1945840000	BLZP 5.08/11/225B SN OR BX	PCB plug-in connector, Clamping yoke connection, Clamping range, max.: 4 mm ² , Pitch in mm: 5.08 mm, No. of poles: 11, 225°, Box
1945850000	BLZP 5.08/12/225B SN OR BX	PCB plug-in connector, Clamping yoke connection, Clamping range, max.: 4 mm ² , Pitch in mm: 5.08 mm, No. of poles: 12, 225°, Box
1945860000	BLZP 5.08/13/225B SN OR BX	PCB plug-in connector, Clamping yoke connection, Clamping range, max.: 4 mm ² , Pitch in mm: 5.08 mm, No. of poles: 13, 225°, Box
1945870000	BLZP 5.08/14/225B SN OR BX	PCB plug-in connector, Clamping yoke connection, Clamping range, max.: 4 mm ² , Pitch in mm: 5.08 mm, No. of poles: 14, 225°, Box
1945880000	BLZP 5.08/15/225B SN OR BX	PCB plug-in connector, Clamping yoke connection, Clamping range, max.: 4 mm ² , Pitch in mm: 5.08 mm, No. of poles: 15, 225°, Box
1945890000	BLZP 5.08/16/225B SN OR BX	PCB plug-in connector, Clamping yoke connection, Clamping range, max.: 4 mm ² , Pitch in mm: 5.08 mm, No. of poles: 16, 225°, Box
1945900000	BLZP 5.08/17/225B SN OR BX	PCB plug-in connector, Clamping yoke connection, Clamping range, max.: 4 mm ² , Pitch in mm: 5.08 mm, No. of poles: 17, 225°, Box
1945910000	BLZP 5.08/18/225B SN OR BX	PCB plug-in connector, Clamping yoke connection, Clamping range, max.: 4 mm ² , Pitch in mm: 5.08 mm, No. of poles: 18, 225°, Box
1945920000	BLZP 5.08/19/225B SN OR BX	PCB plug-in connector, Clamping yoke connection, Clamping range, max.: 4 mm ² , Pitch in mm: 5.08 mm, No. of poles: 19, 225°, Box
1945930000	BLZP 5.08/20/225B SN OR BX	PCB plug-in connector, Clamping yoke connection, Clamping range, max.: 4 mm ² , Pitch in mm: 5.08 mm, No. of poles: 20, 225°, Box
1945940000	BLZP 5.08/21/225B SN OR BX	PCB plug-in connector, Clamping yoke connection, Clamping range, max.: 4 mm ² , Pitch in mm: 5.08 mm, No. of poles: 21, 225°, Box
1945950000	BLZP 5.08/22/225B SN OR BX	PCB plug-in connector, Clamping yoke connection, Clamping range, max.: 4 mm ² , Pitch in mm: 5.08 mm, No. of poles: 22, 225°, Box
1945960000	BLZP 5.08/23/225B SN OR BX	PCB plug-in connector, Clamping yoke connection, Clamping range, max.: 4 mm ² , Pitch in mm: 5.08 mm, No. of poles: 23, 225°, Box
1945970000	BLZP 5.08/24/225B SN OR BX	PCB plug-in connector, Clamping yoke connection, Clamping range, max.: 4 mm ² , Pitch in mm: 5.08 mm, No. of poles: 24, 225°, Box